

SCENARIO #3

ANSON SUPPLY

Supply from Abilene and all is north.

Demands as follows:

- Stamford-1.4 MGD
- Haskell-1.2 MGD
- NCTMWA-2.0 MGD
- Anson-1.37 MGD

PIPELINE IMPROVEMENTS

STATUS	FROM	TO	PRESSURE CLASS (PSI)	DAM (INCHES)	STAMFORD
NEW	STAMFORD	HASKELL	150	14	16.1
UPGRADE	ABILENE	WYE			21.6
NEW	WYE	ANSON			3.9

PUMP STATION IMPROVEMENTS

STATUS	LOCATION	PUMP FLOW (MGD)	TDH (FEET)
UPGRADE PROPOSED	ABILENE	1.50	400
NEW	HAMLIN	1.40	220
NEW	STAMFORD	2.10	240

TANK IMPROVEMENTS

STATUS	LOCATION	TYPE OF TANK	SIZE (MG)	HEIGHT (FEET)	WATER LEVEL (FEET)
UPGRADE	SOUTH OF HAMLIN	GST	0.5	42	40-REFILL 15-SERVICE

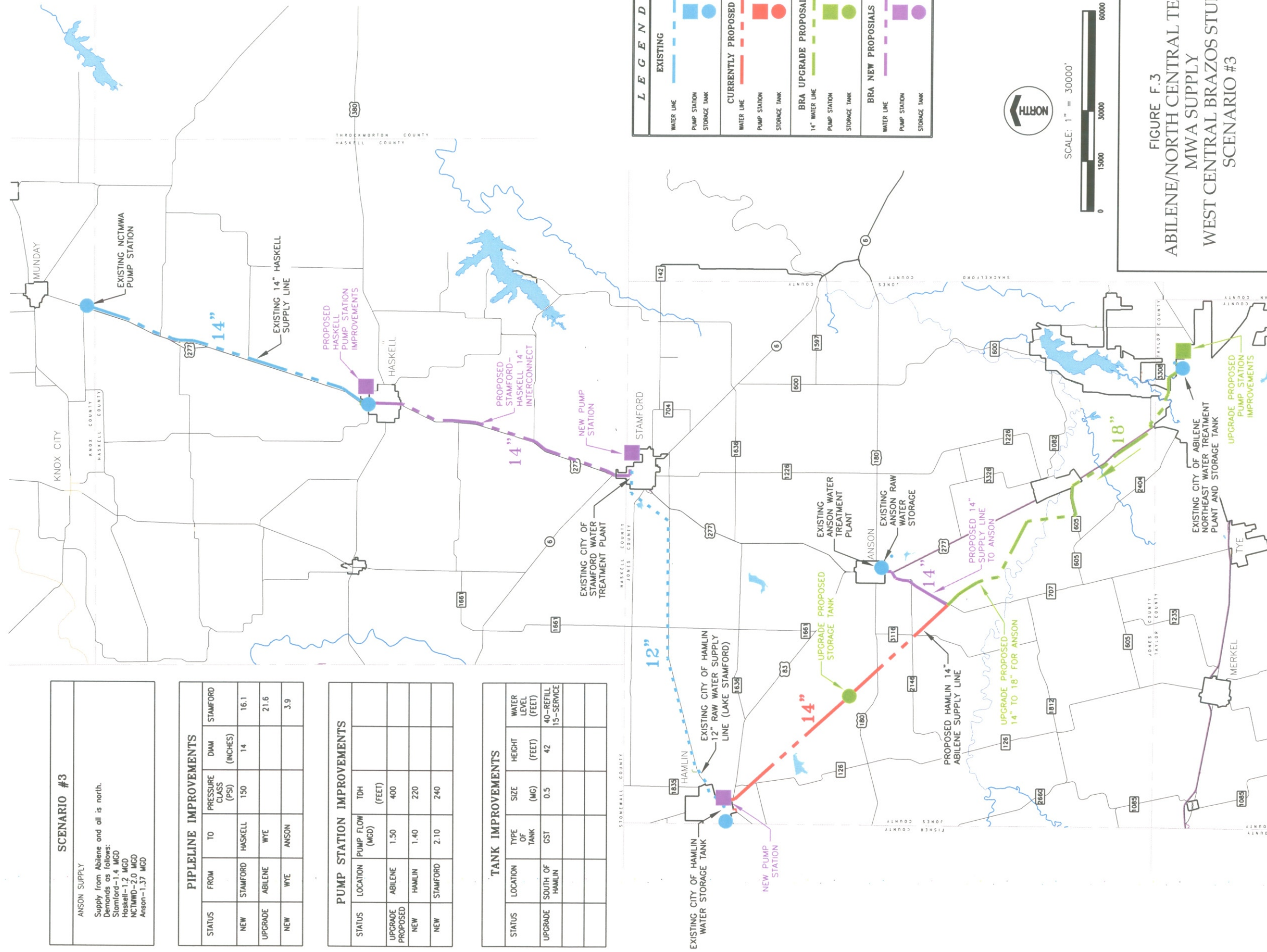

FIGURE F.3
ABILENE/NORTH CENTRAL TEXAS
MWA SUPPLY
WEST CENTRAL BRAZOS STUDY
SCENARIO #3

ACAD Rel 15.06s (LMS Tech) User: CAM
 [BRA02372]N:\WR\JM-REPORT\BRASTUDY\BRAZOS-STUDIES\MWA-SCENARIO3.DWG LAYOUT: 11x17
 FEB 10, 2004 7:12:17 A.M. LTS: 10000.00 PSLTS: 0 TWIST: 0.0, 0.0, 0.0