

Please do not destroy or throw away this publication.
If you have no further use for it, write to the State
Board of Water Engineers, Austin, requesting return
postage.

* * *

TEXAS

* * *

STATE BOARD OF WATER ENGINEERS

C. S. Clark, Chairman
A. H. Dunlap, Member
J. W. Pritchett, Member

* * *

KNOX COUNTY, TEXAS

Records of wells, drillers' logs,
and water analyses, and map
showing location of wells.

* * *

WORKS PROGRESS ADMINISTRATION

GROUND-WATER SURVEY

PROJECT 2090

L. P. Fuggins,
Project Superintendent

* * *

Analyses made, map prepared, data
assembled, and report mimeographed by

WORKS PROGRESS ADMINISTRATION
PROJECT 6507-5112

* * *

Sponsored by the State Board of Water Engineers with
the Bureau of Industrial Chemistry of The University
of Texas and the U. S. Geological Survey cooperating.

* * *

Austin, Texas
Nov. 15, 1937

KNOX COUNTY, TEXAS

* * *

Introduction
by
Samuel F. Turner
Associate Hydraulic Engineer
U. S. Geological Survey

The purpose of this survey was to obtain information concerning existing wells and springs and the quantity and quality of water they yield, and to put down test holes where additional information was needed.

This project was part of a statewide Works Progress Administration project known as a "Statewide Inventory of Water Wells," sponsored by the State Board of Water Engineers. The Division of Ground Water of the U. S. Geological Survey cooperated in the technical direction of the project and the Bureau of Industrial Chemistry of The University of Texas furnished laboratory space and equipment and supervised the chemical analyses.

The analyses were made by chemists employed on Works Progress Administration Project 6507-5112 at Austin, Texas, sponsored by the State Board of Water Engineers. This release was typed and assembled by typists and draftsmen employed on this project.

The field work in Knox County was started in October, 1936, and completed January 3, 1937. This work was done as Project 2090 of District 12 of the Works Progress Administration, Wichita Falls, Texas. L. P. Huggins, an engineer, was project superintendent. Mr. Huggins should be given credit for his great interest in the work and for the many extra hours he spent on the project. The office of the Works Progress Administration in Wichita Falls District made this work possible by constant help and cooperation.

This release contains the well and spring records and well logs obtained by the project superintendent, logs of the test holes drilled by the W. P. A. labor, and the chemical analyses of water from privately owned wells and springs. Locations of all wells, springs, and test holes listed are shown on the map in the back of the release.

The test wells were drilled by W. P. A. labor using a soil auger, drop auger, churn drill, and a sand bucket. Samples were collected at one foot intervals by the well driller in charge of the party. The project superintendent studied these samples and compiled the logs.

Records of wells and springs in Knox County, Texas
 (All wells are dug unless otherwise indicated in "Remarks" column.)
 (See "Logs of W. P. A. test wells" for all records of test wells.)

No.	Distance from Benjamin	Section or Labor	Survey and Block or League	Owner	Date completed	Depth of well (ft.)	Diameter of well (in.)	Height of measuring point above ground (ft.)	a/
f/1	16 $\frac{1}{2}$ miles northwest	Sec. 31, SW cor.	D.&W.R.R. blk. 4	C. H. Featherston	--	17	36	0	
f/2	do.	Sec. 31	do.	Big 4 Ranch Company	1928	4,516	6-5/8	--	
3	do.	Sec. 120, NE cor. SE $\frac{1}{4}$	F.&T.C.R.R. Co. blk. 44	R. L. Kincaid	--	35	42	--	
4	16 $\frac{1}{2}$ miles north	Sec. 119, NE cor. SE $\frac{1}{4}$	do.	H. E. Black	--	35	36	--	
5	16 miles north	Sec. 118, cen. W $\frac{1}{2}$	do.	C. C. Henning	--	29	36	--	
f/6	15 miles north	Sec. 20, NE $\frac{1}{4}$ NW $\frac{1}{4}$	D.&W. R.R. blk. 4	Mart Ebeling	--	28	--	--	
f/7	do.	Sec. 20, NE cor. NW $\frac{1}{4}$	do.	do.	--	32	--	--	
f/8	14 $\frac{1}{2}$ miles north	Sec. 20, NW cor. NE $\frac{1}{4}$	do.	do.	--	28	--	--	
9	13 miles northwest	Sec. 25, NE cor.	do.	C. H. Featherston	--	27	36	0	
f/10	14 miles north	Sec. 13, SW cor.	do.	J. A. Moody	--	17	60	0	
f/11	12 $\frac{1}{2}$ miles north	Sec. 3, SE cor.	do.	do.	--	19	60	0	
f/12	13 $\frac{1}{2}$ miles north	Sec. 10, SE cor.	do.	do.	--	23	60	0	
f/13	15 miles north	Sec. 8, NW cor.	do.	do.	--	20	48	0	
14	12 $\frac{1}{2}$ miles north	Sec. 5, SE cor.	do.	do.	--	24	60	0	
15	do.	Sec. 4, NW cor. SW $\frac{1}{4}$	do.	-- Browning	--	16	42	0	
f/16	12 miles north	Sec. 4, SE cor. SW $\frac{1}{4}$	do.	J. F. Burdett	--	32	36	2.5	
f/17	do.	Sec. 4, cen. S line	do.	C. C. Browning	--	16	36	0	
18	12 $\frac{1}{2}$ miles north	Sec. 79, SW cor. SE $\frac{1}{4}$	H.&T.C.R.R. Co., blk. B	B. Gillospic	--	26	60	--	
f/19	13 $\frac{1}{2}$ miles north	Sec. 77, NW cor. SE $\frac{1}{4}$	do.	Dr. Hines Clark	1936	32	--	--	
f/20	do.	do.	do.	do.	1936	31	--	--	
f/21	14 $\frac{1}{2}$ miles north	Sec. 76, SW cor.	do.	G. W. Myers	--	28	--	--	
f/22	15 miles north	Sec. 75, NE cor.	do.	B. Guinn	--	60	5 $\frac{1}{2}$	--	
f/23	14 $\frac{1}{2}$ miles north	Sec. 69, NW cor. SE $\frac{1}{4}$	do.	T. B. Masterson	--	46	5	1	
f/24	14 miles north	Sec. 68, NE cor. NW $\frac{1}{4}$	do.	do.	--	46	5	1	

a/ Measuring point was usually top of casing, top of well curb, or top of pump base.
 b/ B, bucket; C, cylinder; Cf, centrifugal; E, electric; G, gasoline; H, hand; S, steam; W, windmill; number indicates horsepower.
 c/ D, domestic; I, irrigation; Ind, industrial; N, not used; P, public; S, stock.

Records obtained by L. P. Huggins, Project Superintendent
(Chemical analyses of water from these wells and springs are in the table of analyses.)

No.	Water Level		Pump and power	Use of water	Topographic situation	Supply	Remarks
	Depth below measuring point (feet)	Date of measurement					
1	14	e/	C,W	D	Breaks	A	Rock casing. Owner reported water in red clay and 4 foot drawdown after pumping 5
2	--	--	--	--	--	--	Oil test. 1 gallons a minute for 24 hours. See log.
3	20	e/	--	--	--	--	Concrete casing.
4	21	e/	C,W	--	Rolling	A	Brick casing. 5 foot drawdown after pump-about 5 gallons a minute for 3 hours.
5	21	e/	--	S	Draw	--	Rock casing.
6	5	e/	--	--	--	--	
7	5	e/	--	--	--	--	
8	5	e/	C,W	D	Rolling	--	Reported yield, 5 gallons a minute.
9	10	Oct. 14, 1936	--	S	Breaks	A	Rock casing. Owner reported water in red clay.
10	14	e/	C,W	S	do.	A	Owner reported 3 feet drawdown after pumping 3 gallons a minute for 12 hours. Re-
11	15	e/	C,W	S	Rolling	A	Rock casing. Reported mineral taste.
12	18	e/	C,W	S	do.	A	Do.
13	16	e/	C,W	S	do.	A	Do.
14	20	Oct. 14, 1936	C,W	S	do.	A	Do.
15	13	Oct. 20, 1936	C,W	D	Draw	A	Water reported in red clay. Estimated yield, 4 gallons a minute.
16	28.5	Sept. 30, 1936	B,H	S	Flat	W	Wood curb. Owner reported mineral taste.
17	11	e/	C,W	S	do.	--	
18	18	Oct. 1, 1936	C,W	D	Draw	A	Rock casing.
19	30	Sept. 15, 1936	C,W	D	Breaks	W	Tenant reported 2 feet drawdown after pumping 3 gallons a minute for 10 hours.
20	28	do.	B,H	D	do.	W	Tenant reported mineral taste.
21	--	--	B,H	D	Flat	A	Wood curb. Reported mineral taste.
22	49	Sept. 30, 1936	C,W	D	do.	A	Drilled well. Galvanized iron casing. 5 feet drawdown after pumping about 3 gallons a minute for 3 hours. Mineral taste
23	26	Oct. 1, 1936	C,W	D	Rolling	A	Drilled well. Galvanized iron casing. Reported mineral taste.
24	26	do.	C,W	D	Draw	A	Do.

d/ A, supply reported permanent or adequate for designated use; W, supply reported weak.

e/ Water level reported.

--/ No water sample collected for analysis.

Records of wells and springs in Knox County--Continued

No.	Distance from Benjamin	Section or Labor	Survey and Block or League	Owner	Date completed	Depth of well (ft.)	Diameter of well (in.)	Height of measuring point above ground (ft.) <u>a/</u>
25	14 miles north	Sec. 43, SW cor. NW $\frac{1}{4}$	H.&T.C.R.R. blk. B	T. B. Masterson	--	43	48	--
f/26	14 miles northeast	do.	do.	do.	--	42	5	--
f/27	14 $\frac{1}{2}$ miles northeast	Sec. 41, SW cor.	do.	J. O. Cure	--	40	48	0
28	13 $\frac{1}{2}$ miles northeast	Sec. 43, SE cor.	do.	Lola Scott	--	43	36	--
f/29	do.	Sec. 42, SW cor.	do.	T. B. Masterson	--	50	5	1
30	do.	do.	do.	E.A. Burgess	--	33	36	3
f/31	16 $\frac{1}{2}$ miles northeast	Sec. 30, SW cor. NE $\frac{1}{4}$	H.&T.C.R.R. blk. C	O. Q. Shaw	--	16	--	0
f/32	do.	Sec. 50, cen. N line SE $\frac{1}{4}$	do.	W. A. Shaw	--	31	42	0
f/33	13 $\frac{1}{2}$ miles northeast	Sec. 33, SW cor.	do.	-- Waggoner	--	Spring	--	--
f/34	13 miles northeast	Sec. 57, SW cor. NE $\frac{1}{4}$	do.	do.	--	Spring	--	--
f/35	do.	Sec. 58, SE cor. SW $\frac{1}{4}$	do.	A. L. Davis	--	42	42	--
36	do.	Sec. 58, SW cor. NW $\frac{1}{4}$	do.	S. B. Parris	--	42	42	0
37	13 $\frac{1}{2}$ miles northeast	Sec. 58, NW $\frac{1}{4}$ NW $\frac{1}{4}$	do.	J. G. Parris	--	60	--	0
f/38	do.	do.	do.	do.	--	43	--	0
f/39	do.	do.	do.	W. W. Parris	--	31	42	0
40	12 $\frac{1}{2}$ miles northeast	Sec. 63, cen. W line NW $\frac{1}{4}$	do.	Sarah Green	--	37	42	0
f/41	13 miles northeast	Sec. 88, NE cor.	do.	J. A. La Quay	--	50	42	3
f/42	13 $\frac{1}{2}$ miles northeast	Sec. 89, SE cor. SW $\frac{1}{4}$	do.	J. B. Lowery	--	42	42	--
43	do.	Sec. 89, SW cor. SE $\frac{1}{4}$	do.	Jake Welch	--	46	42	--
44	13 miles northeast	Sec. 62, SW cor.	do.	M. J. Massingale	--	50	42	2.5
f/45	13 $\frac{1}{2}$ miles northeast	Sec. 62, NE cor. SW $\frac{1}{4}$	do.	M. Welch	--	41	36	0
f/46	do.	Sec. 89, SE cor. NE $\frac{1}{4}$	do.	C. M. Grooves	--	37	42	3.5
f/47	14 miles northeast	Sec. 61, cen. W line SW $\frac{1}{4}$	do.	M. A. Scott	--	21	42	0
f/48	do.	Sec. 90, cen. SE $\frac{1}{4}$	do.	W. A. Ryder	--	33	42	0.5
49	do.	Sec. 90, SE cor. NE $\frac{1}{4}$	do.	E. A. Burgess	--	47	48	--
50	14 $\frac{1}{2}$ miles northeast	Sec. 90, cen. E line NE $\frac{1}{4}$	do.	W. A. Ryder	--	56	--	3

L. P. Huggins, Project Superintendent

No.	Water Level		Pump and power <u>b/</u>	Use of water <u>c/</u>	Topographic situation	Supply <u>d/</u>	Remarks
	Depth below measuring point (feet)	Date of measurement					
25	25	<u>e/</u>	C,H	D	Flat	A	Galvanized iron casing.
26	32	Oct. 1, 1936	C,W	D	do.	--	Drilled well. Galvanized iron casing. Tenant reported 6 feet drawdown after pumping 3 gallons a minute for 6 hours.
27	30	<u>e/</u>	C,W	D	do.	A	Galvanized iron casing. Reported mineral taste.
28	36	Oct. 1, 1936	B,H	D	Rolling	A	Concrete casing. Tenant reported water in sandy soil.
29	45	<u>e/</u>	C,W	D	do.	A	Drilled well. Galvanized iron casing. Drawdown 5 feet after pumping about 3
30	27	<u>e/</u>	C,W	D	do.	A	Brick casing. 3 gallons a minute for 5 hours.
31	14	<u>e/</u>	B,H	D	Breaks	--	Reported mineral taste.
32	25	--	B,H	D	Rolling	--	Concrete casing. Reported mineral taste.
33	Flows	Oct. 9, 1936	None	S	Cliff	A	Reported flow, 30 gallons a minute from 4 openings in sandy gravel.
34	Flows	do.	None	D	Breaks	A	Reported flow, 5 gallons a minute from 3 openings in sandy gravel.
35	34	<u>e/</u>	C,W	--	Rolling	--	Concrete casing. Reported mineral taste.
36	33	<u>e/</u>	C,W	D	do.	--	Brick casing.
37	31	Oct. 5, 1936	--,H	D	do.	--	Concrete casing.
38	35	do.	B,H	D	do.	--	Reported mineral taste.
39	28	--	B,H	--	do.	--	Concrete casing.
40	34	--	C,W	D	--	--	Do.
41	47	Oct. 2, 1936	C,W	D	Rolling	A	Brick casing. Owner reported water in sandy clay and slight drawdown after pump-
42	34	<u>e/</u>	C,W	D	Flat	--	Re- ing 3 gallons a minute for 6 hours. ported mineral taste.
43	42	--	C,W	D	Rolling	--	Brick casing.
44	47	Oct. 2, 1936	C,W	D	Flat	A	Galvanized iron casing. Owner reported water in sandy clay and slight drawdown after pumping 3 gallons a minute for 6
45	31	Oct. 5, 1936	C,W	D	Rolling	--	Concrete casing. Reported hours. mineral taste.
46	33	Oct. 2, 1936	B,H	S	Flat	A	Brick casing. Owner reported water with mineral taste in sandy clay.
47	18	<u>e/</u>	C,W	D	Draw	A	Owner reported 1 foot drawdown after pumping 3 gallons a minute for 6 hours.
48	28	<u>e/</u>	C,W	D	Flat	A	Brick casing.
49	44	Oct. 1, 1936	C,W	D	do.	A	Concrete casing. Owner reported slight drawdown after pumping 3 gallons a minute
50	26	do.	B,H	--	Draw	A	Concrete casing. for 3 hours.

Records of wells and springs in Knox County--Continued

No.	Distance from Benjamin	Section or Labor	Survey and Block or League	Owner	Date completed	Depth of well (ft.)	Diameter of well (in.)	Height of measuring point above ground (ft.) a/
f/ 51	13 $\frac{1}{2}$ miles northeast	Sec. 90, SW cor. NW $\frac{1}{4}$	H.&T.C.R.R blk. C	E. A. Burgess	--	43	48	2.5
52	do.	Sec. 91, SE cor. NE $\frac{1}{4}$	do.	Lola Scott	--	40	42	3
f/ 53	do.	Sec. 120, cen.E line NE $\frac{1}{4}$	do.	First State Bank, Truscott	--	29	42	2
54	13 miles northeast	Sec. 91, SW cor. NW $\frac{1}{4}$	do.	J. O. Cure	--	39	36	3
f/ 55	do.	Sec. 120, cen. SE $\frac{1}{4}$	do.	W. H. Reid	--	58	36	2.5
f/ 56	do.	Sec. 91, SW cor. SE $\frac{1}{4}$	do.	H. H. Williams	--	55	36	2
f/ 57	do.	Sec. 91, SE cor.	do.	E. E. Taylor	--	28	--	--
f/ 58	do.	Sec. 92, NW cor. NE $\frac{1}{4}$	do.	Oscar Miller	--	35	36	--
f/ 59	12 $\frac{1}{2}$ miles northeast	Sec. 89, SW cor.	do.	H. H. Lowery	--	45	42	--
f/ 60	12 miles northeast	Sec. 93, cen.N line NE $\frac{1}{4}$	do.	O. W. Welch	--	33	42	--
61	do.	Sec. 93, NE cor.	do.	Gilliland School	--	40	42	3
f/ 62	11 $\frac{1}{2}$ miles northeast	Sec. 88, cen.S line SW $\frac{1}{4}$	do.	Clemens & Faust	--	32	42	0
63	do.	Sec. 93, SE cor.	do.	J. D. Cook	--	46	36	0
f/ 64	10 $\frac{1}{2}$ miles northeast	Sec. 117, NE cor. SE $\frac{1}{4}$	do.	M. E. Ryder	--	50	42	0
f/ 65	11 miles northeast	Sec. 117, cen.E line NE $\frac{1}{4}$	do.	O. A. Ilseng	--	44	42	0
66	do.	Sec. 94, NW cor.	do.	John Blair	--	60	42	0
f/ 67	do.	Sec. 93, SW cor.	do.	W. T. Cook	--	63	42	--
68	11 $\frac{1}{2}$ miles northeast	Sec. 118, NE cor. SE $\frac{1}{4}$	do.	B. S. Martin	--	49	42	--
f/ 69	do.	Sec. 118, cen.E line NE $\frac{1}{4}$	do.	H. Jamison	--	41	42	--
f/ 70	12 miles northeast	Sec. 118, NE cor.	do.	Farmers' Coop. Society	--	44	--	1
71	do.	Sec. 92, SW cor.	do.	E. B. McClure	--	41	42	--
f/ 72	do.	Sec. 119, SE cor.	do.	J. G. Horne, et al.	--	41	5	1
f/ 73	do.	Sec. 119, cen. SE $\frac{1}{4}$	do.	do.	--	38	42	0
f/ 74	do.	Sec. 119, cen.W line SE $\frac{1}{4}$	do.	do.	--	100	5	2
f/ 75	11 $\frac{1}{2}$ miles northeast	Sec. 119, cen.W line SW $\frac{1}{4}$	do.	do.	--	82	5	3
76	do.	Sec. 122, SE cor.	do.	J. C. Eubanks	--	60	42	2.5

L. P. Huggins, Project Superintendent

No.	Water Level		Pump and power b/	Use of water c/	Topographic situation	Supply d/	Remarks
	Depth below measuring point (feet)	Date of measurement					
51	37.5	Oct. 1, 1936	C, W	D	Flat	A	Brick casing.
52	26	e/	B, H	D	do.	A	Do.
53	27	Oct. 1, 1936	C, W	D	Rolling	A	Brick casing. Tenant reported mineral taste and 1 foot drawdown after pumping 3 gallons a minute for 6 hours.
54	34	c/	C, W	D	do.	A	Brick casing.
55	30.5	e/	C, W	D	do.	A	Brick casing. Reported mineral taste.
56	30	Oct. 1, 1936	C, W	D	do.	A	Do.
57	25.5	e/	C, W	D	Draw	A	Concrete casing. Owner reported mineral taste and 1 foot drawdown after pumping 3 gallons a minute for 6 hours.
58	33	e/	C, W	D	Flat	--	Brick casing.
59	38	e/	B, H	--	Draw	--	Brick casing. Reported mineral taste.
60	51	e/	C, W	D	Rolling	--	Galvanized iron casing. Reported mineral taste.
61	33	Oct. 2, 1936	C, W	D	Flat	A	Brick casing.
62	27	Oct. 5, 1936	C, W	D	Draw	--	Do.
63	36	do.	C, W	D	Rolling	A	Concrete casing.
64	39	Oct. 6, 1936	B, H	--	do.	A	Reported mineral taste.
65	36	do.	C, W	D	do.	--	Brick casing. Reported mineral taste.
66	32	do.	B, H	D	do.	--	
67	42	Oct. 2, 1936	C, W	--	Flat	--	Brick casing. Reported mineral taste.
68	41	do.	--	--	Rolling	--	Concrete casing.
69	38	do.	C, W	D	do.	--	Concrete casing. Reported mineral taste.
70	41	do.	C, G, S	Ind	Flat	A	Concrete casing. Reported 1 foot drawdown after pumping 50 gallons a minute for 2 hours.
71	38	do.	C, W	D	do.	A	Brick casing.
72	37	do.	C, H	D	do.	A	Drilled well. Galvanized iron casing. Reported mineral taste.
73	30	Oct. 5, 1936	C, W	D	Rolling	--	Brick casing. Reported mineral taste.
74	50	Oct. 2, 1936	C, H	--	Flat	A	Drilled well. Galvanized iron casing. Reported mineral taste.
75	52	do.	C, W	D	do.	A	Do.
76	54	do.	C, W	D	Rolling	A	Brick curb and casing. Owner reported slight drawdown after pumping 3 gallons a minute for 6 hours.

Records of wells and springs in Knox County--Continued

No.	Distance from Benjamin	Section or Labor	Survey and Block or League	Owner	Date completed	Depth of well (ft.)	Diameter of well (in.)	Height measuring point above ground (ft.) ^{a/}
f/ 77	11 miles northeast	Sec. 123, NW cor. NE $\frac{1}{2}$	H.&T.C.R.R. blk. C	H. T. Cook	--	64	42	3
f/ 78	11 $\frac{1}{2}$ miles northeast	Sec. 123, NW cor. SE $\frac{1}{2}$	do.	J. C. Eubanks	--	72	42	3
79	12 miles northeast	Sec. 122, NE cor.	do.	L. B. Baty	--	54	5	3
f/ 80	12 miles north	Sec. 122, NW cor.	do.	J. E. Eubanks	--	31	5	--
f/ 81	do.	Sec. 149, NE cor.	do.	T. T. Faulkner	--	30	5	1
f/ 82	do.	Sec. 121, SW cor.	do.	Ray Baty	--	80	42	1
33	12 $\frac{1}{2}$ miles north	Sec. 150, SE cor. NE $\frac{1}{2}$	do.	C. C. Myers	--	55	42	3
f/ 84	13 miles north	Sec. 121, NW cor.	do.	G. W. Solomon	--	50	36	--
85	13 miles north	Sec. 150, cen. SW $\frac{1}{4}$	do.	R. G. Ilseng	--	36	5	1
86	11 miles north	Sec. 147, NW cor. SE $\frac{1}{2}$	H.&T.C.R.R. blk. 44	J. Masterson	--	21	36	--
f/ 88	10 $\frac{1}{2}$ miles north	Sec. 2, NW cor.	D. & W. R.R. blk. 3	W. E. Spivey	--	52	36	--
89	13 miles north	Sec. 2, NE cor.	G.C.&S.F.R.R.	J. H. Westbrook	--	14	5	2
f/ 91	9 $\frac{1}{2}$ miles north	Sec. 165, NE cor.	H.&T.C.R.R. blk. 44	R. R. Myers	--	40	36	--
92	10 miles north	Sec. 165, cen. N line	do.	do.	--	40	36	2.5
93	do.	Sec. 150, NW cor. SW $\frac{1}{4}$	do.	B. R. Westbrook	--	45	36	2
94	10 $\frac{1}{2}$ miles north	Sec. 150, SW cor. NW $\frac{1}{2}$	do.	Tom Westbrook	--	42	36	--
95	do.	Sec. 151, NE cor.	do.	Mamie Jones	--	45	36	2.5
96	do.	Sec. 150, NW cor.	do.	do.	--	44	36	2
f/ 97	11 miles north	Sec. 144, SW cor SE $\frac{1}{2}$	do.	Jim Jones	--	32	5	--
98	11 $\frac{1}{2}$ miles north	Sec. 1, SW cor.	G.C.&S.F.R.R.	W.F. Hickman	--	27	42	2
f/ 99	do.	Sec. 144, cen. W line NE $\frac{1}{2}$	H.&T.C.R.R. blk. 44	W. W. Gleason	--	33	36	2
f/100	do.	Sec. 144, NW cor. NE $\frac{1}{4}$	do.	H. Barnes	--	29	5	0
f/101	do.	do.	do.	J. W. Chowning	--	36	5	2
102	do.	do.	do.	Dr. J. E. Stoner	--	33	4	--

a/ Measuring point was usually top of casing, top of well curb, or top of pump base.

b/ B, bucket; C, cylinder; Cf, centrifugal; E, electric; G, gasoline; H, hand; S, steam; W, windmill; number indicates horsepower.

c/ D, domestic; I, irrigation; Ind, industrial; N, not used; P, public; S, stock.

L. P. Huggins, Project Superintendent

No.	Water Level		Pump and power <u>b/</u>	Use of water <u>c/</u>	Topographic situation	Supply <u>d/</u>	Remarks
	Depth below measuring point (feet)	Date of measurement					
77	54	Oct. 2, 1936	C,W	D	Rolling	--	Reported mineral taste.
78	69	do.	B,H	D	Flat	A	Brick curb and casing. Reported mineral taste.
79	34	do.	C,W	D	do.	A	Drilled well. Galvanized iron casing.
80	22	Sept. 30, 1936	C,W	S	Undulating	A	Drilled well. Galvanized iron casing. Owner reported mineral taste.
81	21	<u>e/</u>	C,W	D	Flat	A	Do.
82	60	Oct. 2, 1936	C,W	D	do.	A	Galvanized iron casing. Owner reported mineral taste.
83	45	do.	C,W	D	do.	A	Wood casing.
84	21	Oct. 1, 1936	B,H	--	Draw	--	Wood curb.
85	33	Oct. 2, 1936	C,W	D	Flat	W	Drilled well. Galvanized iron casing. Tenant reported 3 feet drawdown after pump-
86	3.5	Sept. 30, 1936	C,H	S	Draw	A	3 gallons a minute for 6 hours.
88	30	Sept. 29, 1936	C,W	D	Flat	A	Brick casing. Owner reported mineral taste.
89	6	Oct. 1, 1936	C,W	D	Draw	A	Drilled well. Galvanized iron casing. Owner reported 5 feet drawdown after pump-
91	22.5	Sept. 29, 1936	C,W	S	do.	--	Brick casing. 3 gallons a minute for 6 hours.
92	22.5	do.	C,W	D	Flat	A	Do.
93	23	do.	C,H	D	do.	A	Concrete casing.
94	23	do.	C,W	--	Draw	A	Brick casing. Reported 6 feet drawdown after pumping 4 gallons a minute for 3
95	31.5	do.	C,H	D	Flat	A	Brick casing. hours.
96	28	do.	C,H	D	Draw	A	Do.
97	27	Sept. 30, 1936	C,W	D	Flat	A	Drilled well. Galvanized iron casing. Owner reported mineral taste.
98	20	Sept. 29, 1936	C,W	D	do.	A	Owner reported mineral taste.
99	28	Sept. 30, 1936	B,H	D	do.	A	Brick casing. Reported mineral taste.
100	25	do.	C,W	D	do.	A	Drilled well. Galvanized iron casing. Owner reported mineral taste.
101	28	do.	C,W	D	do.	A	Do.
102	28	do.	C,W	D	do.	W	Drilled well. Galvanized iron casing.

d/ A, supply reported permanent or adequate for designated use; W, supply reported weak.

c/ Water level reported.

e/ No water sample collected for analysis.

Records of wells and springs in Knox County--Continued

No.	Distance from Benjamin	Section or Labor	Survey and Block or League	Owner	Date completed	Depth of well (ft.)	Diameter of well (in.)	Height of measuring point above ground (ft.) $\frac{a}{b}$
f/103	11 $\frac{1}{2}$ miles north	Sec. 131, cen.S line E $\frac{1}{2}$	H.&T.C.R.R. blk. 44	J. H. Dunn	--	37	8	2
104	do.	Sec. 143, NE cor.	do.	Clyde Bullion	--	19	42	0
f/105	do.	do.	do.	do.	--	--	--	--
f/106	12 miles north	Sec. 132, cen. S line SW $\frac{1}{4}$ NW $\frac{1}{4}$	do.	J. C. Eubanks	--	39	5 $\frac{1}{2}$	0
107	do.	Sec. 2, cen.N line SE $\frac{1}{2}$	D. & W. R.R. blk. 4	do.	--	39	5 $\frac{1}{2}$	0
108	11 miles north	Sec. 143, NE cor. SW $\frac{1}{4}$	H.&T.C.R.R. blk. 44	Clyde Bullion	--	15	60	--
109	do.	Sec. 152, NE cor. NW $\frac{1}{4}$	do.	Gwinn Hickman	--	41	42	0
f/110	10 $\frac{1}{2}$ miles north	Sec. 152, cen. NW $\frac{1}{4}$	do.	R. B. Masterson	--	35	6	0
111	do.	Sec. 152, SE cor. NW $\frac{1}{4}$	do.	Gwinn Hickman	--	17	36	0
f/112	do.	Sec. 152, NE cor. SW $\frac{1}{4}$	do.	W. A. Brown	--	32	42	0
113	9 $\frac{1}{2}$ miles north	Sec. 162, NE cor.	do.	C. I. Browder	--	58	42	0
f/114	8 $\frac{1}{2}$ miles north	Sec. 24, NE cor.	D. & W. R.R. blk. 3	do.	--	36	4	--
115	do.	do.	do.	do.	--	28	42	0
116	9 miles north	Sec. 174, NE cor. E $\frac{1}{2}$	H.&T.C.R.R. blk. 44	J. B. Eubanks	--	37	42	0
f/117	10 miles north	Sec. 162, NW cor.	do.	W. A. Brown	1897	57	42	0
f/118	9 $\frac{1}{2}$ miles north	Sec. 161, NW cor.	do.	R. B. Masterson	--	52	6	0
f/119	9 $\frac{1}{2}$ miles northwest	Sec. 28, cen.E line SW $\frac{1}{4}$	D. & W. R.R. blk. 3	C. M. Guinn	1936	31	54	0
f/120	11 $\frac{1}{2}$ miles north	Sec. 16, NE cor. SW $\frac{1}{4}$	D. & W. R.R. blk. 4	L. Chesser	--	24	72	--
121	do.	Sec. 16, NE cor. SW $\frac{1}{4}$	do.	do.	--	27	--	0
f/122	11 miles northwest	Sec. 16, SW cor.	do.	do.	--	20	54	--
f/123	12 miles northwest	Sec. 26, cen.E line SW $\frac{1}{4}$	do.	C. H. Featherston	--	19	36	0
124	12 $\frac{1}{2}$ miles northwest	Sec. 26, SW cor. NW $\frac{1}{4}$	do.	do.	--	29	42	0
f/125	12 miles northwest	Sec. 26, SW cor.	do.	do.	--	21	--	0
f/126	9 miles northwest	Sec. 1	G.C.&S.F.R.R. blk. 6	W. R. Moore	1928	3,511	5-3/16	--
f/127	8 $\frac{1}{2}$ miles west	Sec. 3, N $\frac{1}{4}$ S $\frac{1}{4}$	G.C.&S.F.R.R.	Mrs. J. M. Moore	--	15	--	1
f/128	7 $\frac{1}{2}$ miles west	Sec. 126, N $\frac{1}{4}$ N $\frac{1}{4}$	H.&T.C.R.R. blk. 13	C. R. Elliot	--	28	30	2
129	7 miles west	Sec. 105, cen. S $\frac{1}{4}$	do.	W. P. McFadden	--	31	--	--

L. P. Huggins, Project Superintendent

No.	Water Level		Pump and power b/	Use of water c/	Topographic situation	Supply d/	Remarks
	Depth below measuring point (feet)	Date of measurement					
103	30	Sept. 30, 1936	C,H	S	Flat	A	Drilled well. Galvanized iron casing. Reported salty taste.
104	7	Oct. 14, 1936	C,W	--	Rolling	--	Rock casing. Reported yield 6 gallons a minute. Water reported in red clay.
105	--	--	--	--	do.	--	Drilled well. Well sanded up.
106	27.5	Oct. 14, 1936	C,W	--	--	A	Drilled well. Galvanized iron casing. Reported 6 feet drawdown after pumping 5
107	22	do.	C,W	--	--	A	Drilled well. Galvanized iron casing. Reported [] gallons a minute for 3 hours.
108	8	e/	None	S	Valley	--	Rock casing. [] yield, 6 gallons a minute.
109	39	Oct. 20, 1936	C,W	D	Rolling	A	Brick casing. Estimated yield, 4 gallons a minute.
110	23	do.	C,W & G,-	D	Draw	A	Drilled well. Steel casing.
111	9	do.	Cf. & G,3	D,Ind	do.	A	Concrete casing. Reported 8 feet drawdown after pumping 300 gallons a minute
112	22	do.	--	N	--	--	Concrete casing. Well temporarily unused because of faulty equipment. [] for 3 hours.
113	52	do.	C,W	D	Breaks	A	Galvanized iron casing. Reported 8 feet drawdown after pumping 4 gallons a minute. []
114	24	e/	B,H	--	do.	A	Drilled well. Galvanized iron casing. Reported slight [] minute for 6 hours.
115	19	Oct. 20, 1936	C,W	D	do.	A	Rock casing. Estimated [] mineral taste. yield, 4 gallons a minute.
116	33	do.	C,W	S	--	A	Do.
117	16	do.	C,W & G,-	D	Rolling	A	Concrete casing.
118	20	e/	C,W	S	Draw	A	Drilled well. Steel casing. Estimated yield, 4 gallons a minute.
119	21	Oct. 20, 1936	--	--	do.	--	Water reported in red clay.
120	4.3	e/	--	D	Flat	A	Wood curb; rock casing.
121	12	e/	C,W	D	do.	A	Owner reported 2 feet drawdown after pumping 5 gallons a minute for 6 hours.
122	24	e/	--	S	--	--	
123	16	e/	C,W	D	Breaks	A	Rock casing. Water reported in red clay.
124	27	e/	C,W	D	do.	A	Wood curb; rock casing. Owner reported water in red clay.
125	17	e/	C,W	--	do.	A	Rock casing. Owner reported water in red clay and 3 feet drawdown after pumping 4
126	--	--	--	--	--	--	Oil test. [] gallons a minute for 6 hours. Located 475 varas S and 475 varas E of NW
127	8	Dec. 9, 1936	C,W	S	Rolling	A	Wood casing. [] corner of section 1. See log. Reported unfit for domestic use be-
128	15	do.	C,W	S	do.	A	Brick casing. [] cause of mineral taste. Tenant reported mineral taste.
129	--	--	B,H	D	do.	W	Wood casing.

Records of wells and springs in Knox County--Continued

No.	Distance from Benjamin	Section or Labor	Survey and Block or League	Owner	Date completed	Depth of well (ft.)	Diameter of well (in.)	Height of measuring point above ground (ft.) <u>a/</u>
F/150	4 $\frac{3}{4}$ miles southwest	Sec. 45, N $\frac{1}{2}$	H.&T.C.R.R. blk. 13	--	--	34	--	2
F/151	1 $\frac{1}{2}$ miles west	Sec. 17, cen E line N $\frac{1}{2}$	W. T. Ward	Benjamin State Bank	--	36	30	--
F/152	1 $\frac{1}{2}$ miles north	Sec. 22, NW cor. S $\frac{1}{2}$	H.&T.C.R.R. blk. 44	Dr. G. H. Beavers	1927	4,504	5-3/16	--
F/153	1 $\frac{1}{2}$ miles north	Sec. 3, SE cor.	D. & W. R.R. blk. 3	do.	--	17	42	0
137	7 miles northeast	Sec. 5, cen.S line SE $\frac{1}{2}$	do.	do.	--	21	42	0
F/158	6 miles northeast	Sec. 111, NW cor. SW $\frac{1}{2}$	H.&T.C.R.R. blk. C	L. P. Jones, et al.	1927	2,606	6-5/8	--
159	10 miles northeast	Sec. 69, NE cor.	do.	J. J. Collier	--	27	42	--
F/140	10 $\frac{1}{2}$ miles east	Sec. 40, NE cor. SW $\frac{1}{2}$	do.	J. C. Feemster	--	47	36	0
F/141	do.	do.	do.	do.	--	48	36	0
142	11 miles east	Sec. 1, NE cor.	Wm. Johnson	E. J. Kinnibrough	1935	23	--	--
F/143	11 $\frac{1}{2}$ miles east	Sec. 2, NE cor. S $\frac{1}{2}$	J. Hefflefinger	D. B. Shipman	--	61	36	0
144	12 miles east	Sec. 18, NW cor. SW $\frac{1}{2}$	C. T. R. R. blk. C	J. C. Seaton	--	65	36	0
F/145	12 $\frac{1}{2}$ miles east	Sec. 18, NE cor. SW $\frac{1}{2}$	do.	J. W. Trainham	--	41	36	0
146	12 miles east	Sec. 18, SW cor. NW $\frac{1}{2}$	do.	Barney Welch	--	49	24	0
F/147	do.	Sec. 2, NE cor.	J. Hefflefinger	J. S. Albright	--	45	--	--
148	do.	do.	do.	League Davis	--	33	36	0
F/149	do.	Sec. 2, SE cor.	W. H. Bratcher	W. M. Ford	--	54	--	--
150	do.	Cen. S $\frac{1}{2}$	Richard Hope	Jess Trainham	--	49	--	--
F/151	12 $\frac{1}{2}$ miles east	Sec. 18, cen.N line NW $\frac{1}{2}$	C. T. R. R. blk. C	J. C. Feemster	--	49	--	--
F/152	do.	Sec. 18, NE cor. NW $\frac{1}{2}$	do.	do.	--	44	--	--
F/153	do.	do.	do.	J. W. Feemster	--	49	24	0
154	13 miles east	Sec. 18, NE cor.	do.	F. F. Jernigan	--	39	36	0
F/155	do.	do.	do.	J. D. Jefcoat	--	40	36	0
F/157	do.	Sec. 1, SW cor.	do.	J. Hughes	--	36	36	0
F/158	do.	Sec. 72, cen.N line NW $\frac{1}{2}$	G.H.&H.R.R. blk. B	Jack Kinnibrough	--	35	30	0
159	do.	do.	do.	do.	--	41	30	0
160	do.	Sec. 72, NE cor. NW $\frac{1}{2}$	do.	Mrs. R. E. Hughes	--	35	--	0

L. P. Huggins, Project Superintendent

No.	Water Level		Pump and power <u>b/</u>	Use of water <u>c/</u>	Topographic situation	Supply <u>d/</u>	Remarks
	Depth below measuring point (feet)	Date of measurement					
130	22	Dec. 9, 1936	C,W	D	do.	A	Reported 1.5 feet drawdown after pumping 3 gallons a minute for 4 hours.
131	20.3	do.	B,H	S	Flat	A	Brick casing. Reported unfit for domestic use.
133	--	--	--	--	--	--	Oil test. Located 50 feet E and 50 feet S of center of W line. Altitude, 1,441 feet.
136	12	<u>e/</u>	C,W	S	Breaks	A	Galvanized iron casing. See log. Reported mineral taste.
137	3	<u>e/</u>	C,W	S	do.	A	Rock casing.
138	--	--	--	--	--	--	Oil test. See log.
139	25	<u>e/</u>	C,W	D	--	--	Concrete casing.
140	45	Oct. 13, 1936	B,H	D	--	A	Reported mineral taste.
141	39	do.	C,W	--	Rolling	A	Concrete casing.
142	17	Oct. 27, 1936	B,H	--	--	--	
143	53	Oct. 13, 1936	C,W	D	Breaks	A	Concrete casing. Reported mineral taste.
144	62	do.	C,W	--	Rolling	--	Concrete casing.
145	39	do.	C,W	D	do.	A	Concrete casing. Reported mineral taste.
146	42	do.	C,W	D	--	A	Concrete casing. Tenant reported slight drawdown after pumping 4 gallons a minute
147	2	<u>e/</u>	C,-	--	--	--	Lo. for 24 hours.
148	31	Oct. 13, 1936	C,W	L	Draw	A	Galvanized iron casing.
149	9	<u>e/</u>	--	--	--	--	Concrete casing.
150	4	<u>e/</u>	--	--	Rolling	--	
151	4	<u>e/</u>	--	--	Flat	--	
152	3	<u>e/</u>	--	--	--	--	
153	45.5	Oct. 13, 1936	C,W	D	Flat	A	Concrete casing. Owner reported slight drawdown after pumping 4 gallons a minute
154	35	do.	C,W	D	--	A	Concrete casing. for 24 hours.
155	34	do.	C,W	L	Rolling	A	do.
157	34	Oct. 26, 1936	B,H	D	Flat	A	Rock casing.
158	27	Oct. 27, 1936	C,W	D	do.	A	Concrete casing.
159	27	do.	C,W	D	do.	A	do.
160	22	do.	B,H	D	do.	A	Tenant reported water in gravel.

Records of wells and springs in Knox County--Continued

No.	Distance from Benjamin	Section or Labor	Survey and Block or League	Owner	Date completed	Depth of well (ft.)	Diameter of well (in.)	Height of measuring point above ground (ft.) <u>g</u>
f/161	13 $\frac{1}{2}$ miles east	Sec. 1, SE cor.	C. T. R. R. blk. C	E. E. Taylor	1935	28	--	0
f/162	14 miles east	Sec. 64, NW cor. SW $\frac{1}{4}$	G.P.&H.R.R. blk. B	W. M. Ford	--	39	30	0
f/163	13 miles east	Sec. 1, cen.W line NW $\frac{1}{4}$	C. T. R. R. blk. C	E. E. Taylor	--	40	42	0
f/164	do.	Sec. 1, NW cor.	do.	J. J. Collier	--	40	36	0
f/165	13 $\frac{1}{2}$ miles east	Sec. 2, cen.S line SW $\frac{1}{4}$	do.	Vera Gin Co.	--	39	42	0
166	do.	Sec. 2, SW cor.	do.	D. R. Sullivan	--	39	30	0
f/167	do.	do.	do.	J. W. Warner	--	38	42	0
168	do.	do.	do.	R. C. Spinxs	--	39	30	--
169	13 miles east	Sec. 17, SE cor.	do.	Vera School	--	50	42	0
f/170	do.	Sec. 17, cen.S line SE $\frac{1}{4}$	do.	T. J. Couch	--	54	24	0
f/171	do.	Sec. 17, SW cor. SE $\frac{1}{4}$	do.	J. F. Hughes	--	51	24	0
172	13 $\frac{1}{2}$ miles east	Sec. 17, SE cor. SW $\frac{1}{4}$	do.	T. J. Couch	--	47	30	0
f/173	13 miles east	Sec. 17, NE cor. SW $\frac{1}{4}$	do.	do.	--	40	42	0
f/174	do.	Sec. 17, NW cor.	do.	R. F. McGuire	--	50	24	--
f/175	13 $\frac{1}{2}$ miles northeast	Sec. 16, NE cor. NW $\frac{1}{4}$	do.	A. Ford	--	50	42	0
176	do.	do.	do.	A. Gibbons	--	53	42	0
177	14 miles east	Sec. 16, NE cor. SE $\frac{1}{4}$	do.	W. F. McGuire	--	44	42	0
f/178	do.	Sec. 16, SE cor. NE $\frac{1}{4}$	do.	do.	--	40	42	0
179	do.	Sec. 3, SW cor. NW $\frac{1}{4}$	do.	Mrs. --Slicano	--	45	42	0
f/180	do.	Sec. 3, cen.W line NW $\frac{1}{4}$	do.	J. C. Gray	--	34	42	0
f/181	14 miles northeast	Sec. 4, SW cor.	do.	J. Welch	--	41	42	0
182	14 $\frac{1}{2}$ miles east	Sec. 4, SE cor. SW $\frac{1}{4}$	do.	B. Welch	--	55	42	0
183	15 miles east	Sec. 4, NE cor. SE $\frac{1}{4}$	do.	A. J. Fuller	--	39	42	0
f/184	do.	Sec. 4, SE cor.	do.	Mrs. C. T. Boone	--	30	42	0
f/185	do.	Sec. 3, NE cor.	do.	-- Brawley	--	38	42	0
186	14 miles east	Sec. 5, NW $\frac{1}{4}$ SW $\frac{1}{4}$	do.	Ray W. Gray	--	41	42	0
f/187	do.	Sec. 3, SE cor. SW $\frac{1}{4}$	do.	do.	--	34	42	0

L. F. Huggins, Project Superintendent

No.	Water Level		Pump and power b/	Use of water c/	Topographic situation	Supply d/	Remarks
	Depth below measuring point (feet)	Date of measurement					
161	23	Oct. 27, 1936	B,H	D	Flat	A	
162	30	do.	C,W	D	do.	A	Concrete casing. Tenant reported 5 feet drawdown after pumping 4 gallons a minute
163	36	Oct. 9, 1936	C,W	D	Rolling	A	for 12 hours.
164	34	Oct. 13, 1936	C,W	D	--	A	Concrete casing.
165	33	Oct. 9, 1936	C,S,-	Ind	Flat	A	
166	34	Oct. 13, 1936	C,S,-	Ind	--	A	Reported slight drawdown after pumping 3 gallons a minute for 24 hours.
167	33	Oct. 9, 1936	B,H	D	Flat	A	Concrete casing.
168	4	e/	B,H	--	do.	--	Do.
169	45	Oct. 9, 1936	C,W	D	Sand fill	A	Do.
170	48	Oct. 15, 1936	C,W	D	Flat	A	Do.
171	44	do.	B,H	D	do.	A	Do.
172	44	do.	B,H	D	--	A	Do.
173	37	Oct. 6, 1936	B,H	D	Rolling	A	Concrete casing. Slight mineral taste reported.
174	3	e/	C,W	D	Flat	A	Wood curb; concrete casing. Owner reported 5 feet drawdown after pumping 4 gallons
175	47	Oct. 6, 1936	B,H	D	Rolling	A	Concrete casing. a minute for 3 hours. Slight mineral taste reported.
176	51	do.	B,H	D	do.	A	
177	40	do.	C,W	D	do.	A	Concrete casing.
178	35	do.	C,W	D	do.	A	Concrete casing. Slight mineral taste reported.
179	37	do.	C,W	D	do.	A	Concrete casing.
180	32	do.	B,H	D	do.	A	Slight mineral taste reported.
181	37	do.	C,W	--	do.	A	Concrete casing. Slight mineral taste reported.
182	28	do.	C,W	D	do.	A	Concrete casing.
183	23	do.	C,W	D	do.	A	Do.
184	27	do.	B,H	--	do.	A	Concrete casing. Slight mineral taste reported.
185	30	Oct. 7, 1936	C,W	D	do.	A	Brick casing.
186	36	do.	C,W	D	--	A	Do.
187	32	do.	B,H	D	Rolling	A	Do.

Records of wells and springs in Knox County--Continued

No.	Distance from Benjamin	Section or Labor	Survey and Block or League	Owner	Date completed	Depth of well (ft.)	Diameter of well (in.)	Height of measuring point above ground (ft.) ^{a/}
139	14½ miles east	Sec. 3, SE cor.	C. T. R. R. blk. C	Lee McMurray	--	33	42	0
f/190	do.	Sec. 2, SE cor. NE¼	do.	T. Boone	--	35	42	0
191	14 miles east	Sec. 2, NE cor. SW¼	do.	J. C. Gray	--	40	24	--
f/192	do.	do.	do.	do.	--	41	24	0
f/193	do.	Sec. 2, NW cor. SE¼	do.	J. W. Ford	--	38	--	--
f/194	13½ miles east	Sec. 2, SW cor. SE¼	do.	B. F. Hughes	--	36	42	0
f/195	14 miles east	Sec. 2, cen. E line SE¼	do.	C. C. Allen	--	31	42	0
f/196	do.	Sec. 65, cen. W line SW¼	G. H. & H. R. R. blk. B	H. A. Patterson	--	37	42	0
f/197	do.	Sec. 64, NW cor.	do.	M. Hallobaugh	--	35	42	0
f/198	14½ miles east	Sec. 64, NE cor. NW¼	do.	do.	--	30	42	0
199	do.	Sec. 65, NE cor.	do.	R. N. Smith	--	30	42	0
f/201	15 miles east	Sec. 36, NW cor. NE¼	do.	Henry Robinson	--	81	5½	0
202	do.	do.	do.	do.	--	25	30	0
203	do.	Sec. 37, cen. W line SW¼	do.	Paul Bussel	--	20	30	0
204	do.	Sec. 64, NE cor. SE¼	do.	A. R. McGaughey	--	34	36	0
f/205	do.	Sec. 64, NE cor.	do.	Mrs. M. K. Fuller	--	38	30	0
206	do.	Sec. 37, cen. N line NW¼	do.	R. J. Trainham	--	35	42	0
f/207	15½ miles east	Sec. 38, SW cor. NW¼	do.	M. H. Sullins	--	36	42	0
f/208	14½ miles east	Sec. 63, SW cor. SE¼	do.	M. R. Fuller	--	33	42	0
209	do.	Sec. 63, SE cor. SW¼	do.	H. A. Patterson	--	41	42	0
f/210	do.	Sec. 62, cen. S line SW¼	do.	Lee McMurray	--	31	42	0
f/211	15½ miles east	Sec. 62, SE cor.	do.	J. N. McGaughey	--	33	42	0
212	15 miles east	Sec. 62, NW cor. SE¼	do.	do.	--	30	42	0

a/ Measuring point was usually top of casing, top of well curb, or top of pump base.

b/ B, bucket; C, cylinder; Cf, centrifugal; E, electric; G, gasoline; H, hand; S, steam; W, windmill; number indicates horsepower.

c/ D, domestic; I, irrigation; Ind, industrial; N, not used; P, public; S, stock.

L. P. Huggins, Project Superintendent

No.	Water Level		Pump and power b/	Use of water c/	Topographic signa- tion	Sup- ply d/	Remarks
	Depth below measur- ing point (feet)	Date of measure- ment					
189	29	Oct. 7, 1936	B,H	--	do.	--	Brick casing.
190	29	Oct. 8, 1936	C,W	D	Flat	A	Concrete casing.
191	--	--	C,W	D	do.	A	Concrete casing. Owner reported slight drawdown after pumping 4 gallons a minute
192	36	Oct. 13, 1936	C,W	--	do.	A	Concrete casing. for 12 hours.
193	33	e/	B,H	D	do.	A	Rock casing.
194	32	Oct. 9, 1936	C,W	D	do.	A	Concrete casing.
195	29	Oct. 8, 1936	C,W	D	do.	A	Do.
196	33	do.	C,W	D	do.	A	Do.
197	31	do.	C,W	D	do.	A	
198	28	do.	B,H	D	do.	A	
199	25	do.	C,W	D	do.	A	Concrete casing.
201	19	Oct. 27, 1936	C,W	D	Rolling	A	Bored well. Galvanized iron casing. Owner reported 6 feet drawdown after pump-
202	22	do.	B,H	D	do.	A	ing 4 gallons a minute for 12 hours. Concrete casing.
203	15	e/	C,W	D	Flat	A	Do.
204	26	Oct. 27, 1936	C,W	D	do.	A	Do.
205	31	do.	C,W	D	do.	A	Concrete casing. Tenant reported slight drawdown after pumping 5 gallons a minute
206	28	Oct. 8, 1936	C,W	D	do.	A	Concrete casing. for 24 hours.
207	27	do.	C,W	D	do.	A	Do.
208	31	do.	C,W	D	do.	A	Do.
209	31	do.	C,W	D	Rolling	A	Do.
210	28	Oct. 7, 1936	C,W	D	Flat	A	Brick casing.
211	25	do.	C,W	D	do.	A	Concrete casing.
212	27	do.	B,H	D	--	A	Brick casing.

b/ A, supply reported permanent or adequate for designated use; W, supply reported weak.

c/ Water level reported.

f/ No water sample collected for analysis.

Records of wells and springs in Knox County--Continued

No.	Distance from Benjamin	Section or Labor	Survey and Block or League	Owner	Date completed	Depth of well (ft.)	Diameter of well (in.)	Height of measuring point above ground (ft.) <u>a/</u>
<u>2/</u> 213	15½ miles east	Sec. 62, cen.S line NE¼	C.H.&H.R.R. blk. B	G. W. Blackburn	--	39	42	0
214	16 miles east	Sec. 39, NW cor.	do.	E. C. Hardin	--	32	42	0
<u>2/</u> 215	do.	Sec. 40, SW cor.	do.	J. H. McGuire	--	40	42	0
<u>1/</u> 216	do.	Sec. 61, SE cor.	do.	R. F. Richards	--	32	42	0
217	15½ miles east	Sec. 62, NW cor. NE¼	do.	J. H. Henson	--	42	42	0
<u>1/</u> 218	do.	Sec. 61, SE cor. SW¼	do.	A. J. Fuller	--	35	42	--
219	do.	Sec. 61, SW cor. NW¼	do.	R. F. Richards	--	30	42	0
<u>2/</u> 220	do.	Sec. 61, cen.S line NE¼	do.	do.	--	34	42	0
<u>1/</u> 221	16 miles northeast	Sec. 60, SE cor. SW¼	do.	J. D. Goodrich	--	35	42	0
<u>2/</u> 222	16 miles east	Sec. 61, cen. NE¼	do.	Mrs. S. J. Richards	--	44	42	0
<u>1/</u> 223	do.	Sec. 60, cen.S line SE¼	do.	B. F. Rupe	--	34	42	0
<u>1/</u> 224	17 miles east	Sec. 24, SW cor.	do.	R. B. Trainham	--	31	42	0
<u>1/</u> 225	do.	Sec. 25, cen. NW¼	do.	I. Shipman	--	37	42	0
226	do.	do.	do.	do.	--	36	42	0
<u>1/</u> 227	16 miles east	Sec. 39, SW cor. SE¼	do.	L. M. Christian	--	28	42	0
<u>2/</u> 228	16½ miles east	Sec. 26, cen.S line SW¼	do.	Dora Lee	--	14	42	0
<u>1/</u> 229	do.	Sec. 27, NW cor.	do.	E. Hunt	--	28	42	0
230	16 miles east	Sec. 27, cen.W line NW¼	do.	S. M. Williams	--	29	42	0
<u>2/</u> 231	do.	Sec. 38, SE¼ SE¼	do.	M. H. Sullins	--	34	42	0
232	do.	Sec. 38, SE cor.	do.	do.	--	34	42	0
<u>1/</u> 233	16½ miles east	Sec. 27, SE cor. SW¼	do.	A. E. Boyd	--	32	42	0
<u>2/</u> 234	16 miles east	Sec. 28, NE cor. NW¼	do.	J. H. Blackburn	--	31	42	0
235	do.	Sec. 37, NE cor.	do.	Ernest Beck	--	36	30	0
236	15½ miles east	Sec. 37, NE cor. SE¼	do.	J. L. Bussel	--	31	30	0
237	do.	Sec. 28, SW cor.	do.	J. H. Blackburn	--	22	24	0
<u>2/</u> 238	16 miles east	Sec. 29, NW cor. NE¼	do.	-- Kelliam	--	15	24	0
<u>1/</u> 239	16½ miles east	Sec. 29, NE cor.	do.	G. F. Feemster	--	42	42	0

L. P. Huggins, Project Superintendent

No.	Water Level		Pump and power <u>b/</u>	Use of water <u>c/</u>	Topographic situation	Supply <u>d/</u>	Remarks
	Depth below measuring point (feet)	Date of measurement					
213	31	<u>e/</u>	C,W	D	Rolling	A	Brick casing.
214	26	Oct. 7, 1936	C,W	D	Flat	A	Do.
215	25	do.	C,W	D	do.	A	Concrete casing.
216	27	do.	B,F	D	do.	A	Do.
217	25	do.	C,W	D	do.	A	Brick casing.
218	--	--	C,W	D	do.	A	Rock casing.
219	28	Oct. 6, 1936	C,-	D	Rolling	A	Concrete casing.
220	28	do.	C,W	D	do.	A	Do.
221	33	Oct. 7, 1936	B,F	D	Sand fill	A	Reported slight mineral taste.
222	39	do.	C,W	D	rolling	A	Concrete casing.
223	28	do.	C,W	D	do.	A	Do.
224	29	do.	C,W	D	flat	--	
225	29	do.	C,W	D	do.	A	Cement casing. Reported mineral taste.
226	36	do.	C,W	D	do.	A	Cement casing.
227	25	Oct. 8, 1936	C,W	D	do.	A	Concrete casing.
228	9	do.	--	D	do.	A	Concrete casing. Reported mineral taste.
229	25	do.	C,W	D	do.	A	Do.
230	24	do.	C,W	--	do.	A	Concrete casing.
231	31	do.	C,W	D	do.	A	Concrete casing. Reported slight mineral taste.
232	28	do.	C,W	D	do.	A	
233	26	Oct. 9, 1936	C,W	D	Rolling	A	Concrete casing.
234	25	do.	C,W	D	--	A	Concrete casing. Reported slight mineral taste.
235	24	Oct. 21, 1936	C,W	D	Flat	A	Concrete casing. Estimated yield, 5 gallons a minute.
236	26	do.	C,W	S	do.	A	Concrete casing. Estimated yield, 3 gallons a minute.
237	13	do.	C,W	D	do.	A	Do.
238	12	do.	B,F	D	--	A	Concrete casing. Reported mineral taste.
239	39	Oct. 19, 1936	C,W	D	Draw	A	Concrete casing.

Records of wells and springs in Knox County--Continued

No.	Distance from Benjamin	Section or Labor	Survey and Block or League	Owner	Date completed	Depth of well (ft.)	Diameter of well (in.)	Height of measuring point above ground (ft.) a/
240	16½ miles east	Sec. 28, SE cor.	G.H.&H.R.R. blk. B	J. H. Blackburn	--	30	24	0
f/241	do.	Sec. 1, cen.W line SW¼	do.	F. D. Brannan	--	16	--	0
242	do.	Sec. 28, SE cor. NE¼	do.	J. H. Blackburn	--	21	--	0
f/243	do.	Sec. 28, cen.N line NE¼	do.	do.	--	29	42	0
f/244	17 miles east	Sec. 27, NE cor. SE¼	do.	E. A. Boyd	--	21	42	0
245	do.	Sec. 27, cen.E line SE¼	do.	do.	--	29	42	0
f/246	do.	Sec. 27, SE cor.	do.	do.	--	25	--	0
f/247	do.	Sec. 2, SW cor.	do.	L. J. Shoopman	--	30	42	0
f/248	do.	Sec. 2, cen.S line SW¼	do.	J. H. Blackburn	--	41	42	0
f/249	do.	do.	do.	Bill Blackburn	--	33	42	0
f/250	do.	Sec. 1, NE cor. NW¼	do.	Mrs. -- Henderson	--	45	42	0
251	18 miles east	Sec. 2, SE cor.	do.	W. R. Moore	--	56	42	0
252	17½ miles east	Sec. 1, cen. NE¼	do.	-- Blackburn	--	30	42	0
f/253	17 miles east	Sec. 1, SW cor. NE¼	do.	do.	--	30	42	0
254	do.	Sec. 1, SW cor. SE¼	do.	T. H. Crawford	--	28	42	0
255	do.	Sec. 1, cen. SE¼	do.	W. E. Albertson	--	40	42	0
256	17½ miles east	Sec. 212, NW cor. SW¼	B.B.B.&C.R.R. blk. A	J. J. Moore	--	47	42	0
f/257	18 miles east	Sec. 212, cen. SW¼	do.	do.	--	17	42	0
f/258	do.	Sec. 213, NW cor. SE¼	do.	Mrs. Dudley Benge	--	19	42	0
259	do.	Sec. 213, IE cor. SW¼	do.	do.	--	29	42	0
260	17½ miles east	Sec. 214, SW cor. NW¼	do.	W. J. Blackburn	--	50	42	0
f/261	17 miles east	Sec. 220, cen.S line SE¼	do.	H. F. King	--	21	42	0
262	do.	Sec. 220, cen. SE¼	do.	do.	--	19	42	0
263	do.	Sec. 220, SW cor. SE¼	do.	do.	--	20	42	0
f/264	do.	Sec. 219, NW cor. SE¼	do.	W. F. Robertson	--	20	42	0
265	16 miles east	Sec. 218, NW cor.	do.	W. M. Coffman	--	23	42	0
f/266	do.	Sec. 218, NW cor. SW¼	do.	do.	--	23	42	0

- 22 -
L. P. Huggins, Project Superintendent

No.	Water Level		Purp and power b/	Use of water c/	Topo- graphic situa- tion	Sup- ply d/	Remarks
	Depth below measur- ing point (feet)	Date of measur- ment 1936					
240	14	Oct. 21, 1936	C,W	D	Flat	A	Concrete casing. Tenant reported 5 feet drawdown after pumping 5 gallons a minute for 6 hours.
241	12.5	do.	B,H	D	do.	A	
242	17	do.	C,W	D	do.	A	Concrete casing.
243	25	Oct. 9, 1936	B,H	D	do.	A	Concrete casing.
244	18	do.	--	D	Breaks	A	Concrete casing. Reported slight mineral taste.
245	24	do.	C,W	D	Flat	A	Concrete casing. Water reported in sand and gravel.
246	21	do.	B,H	D	do.	A	Concrete casing.
247	27	do.	C,W	D	do.	A	Do.
248	30	do.	C,W	D	Rolling	A	
249	29	do.	B,H	D	do.	A	Concrete casing.
250	33	do.	B,H	D	do.	A	Do.
251	23	do.	C,W	D	Flat	A	Do.
252	29	Oct. 19, 1936	B,H	D	Draw	A	Do.
253	25	do.	C,W	D	--	A	Do.
254	10	do.	B,H	D	Rolling	A	Rock casing.
255	24	do.	B,H	D	do.	A	Concrete casing. Reported slight mineral taste.
256	44	do.	B,H	S	do.	A	Concrete casing.
257	14	e/	C,W	D	do.	A	Do.
258	14	Oct. 19, 1936	B,H	D	do.	A	Do.
259	19	do.	C,W	D	do.	A	Do.
260	25	do.	B,H	D	do.	A	Do.
261	17	do.	B,H	D	do.	A	Do.
262	15	do.	C,W	D	do.	A	Do.
263	17	do.	B,H	D	do.	A	
264	17	do.	B,H	D	do.	A	Concrete casing.
265	20	do.	C,W	D	River bottoms	A	Do.
266	20	do.	C,W	D	Rolling	A	Do.

Records of wells and springs in Knox County--Continued

No.	Distance from Benjamin	Section or Labor	Survey and Block or League	Owner	Date completed	Depth of well (ft.)	Diameter of well (in.)	Height of measuring point above ground (ft.) a/
267	16 miles east	Sec. 31, cen.S line SE $\frac{1}{2}$	G.H.&H.R.R. blk. B	Mrs. Roxy Morris	--	17	30	0
f/268	15 $\frac{1}{2}$ miles east	Sec. 31, NW cor. SE $\frac{1}{4}$	do.	do.	--	21	24	0
269	do.	Sec. 31, SW cor. NE $\frac{1}{4}$	do.	do.	--	16	24	0
f/270	do.	Sec. 31, NW cor. NE $\frac{1}{4}$	do.	do.	--	25	--	0
271	do.	Sec. 30, SW cor. SE $\frac{1}{4}$	do.	J. B. Tolson	--	19	42	0
f/272	16 miles east	Sec. 30, NE cor. SE $\frac{1}{4}$	do.	W. J. Blackburn	--	13	42	0
273	do.	do.	do.	do.	--	12	42	0
274	do.	do.	do.	J. H. Beck	--	20	42	0
f/275	15 $\frac{1}{2}$ miles east	Sec. 30, SE cor. NW $\frac{1}{4}$	do.	L. P. Snoddy	--	19	20	0
276	16 miles east	Sec. 30, NE cor. NW $\frac{1}{4}$	do.	do.	--	24	--	0
277	16 $\frac{1}{2}$ miles east	Sec. 29, NE cor. SE $\frac{1}{4}$	do.	Mrs. -- Parham	--	30	42	0
f/278	do.	Sec. 220, SW cor. NW $\frac{1}{4}$	B.B.B.&C.R.R. blk. A	E. J. Hillman	--	33	42	0
f/279	do.	do.	do.	Louis Toms	--	28	--	0
f/280	do.	Sec. 220, cen.W line NW $\frac{1}{4}$	do.	do.	--	28	--	0
281	16 miles east	Sec. 29, cen.N line SW $\frac{1}{4}$	G.E.&H.R.R. blk. B	Crow Parham	--	29	36	0
f/282	15 $\frac{1}{2}$ miles east	Sec. 30, cen.W line NW $\frac{1}{4}$	do.	L. P. Snoddy	--	18	--	0
283	do.	Sec. 35, NE cor.	do.	Harry Beck	--	25	24	0
f/284	15 miles east	Sec. 36, SW cor. SE $\frac{1}{4}$	do.	J. H. Blackburn	--	50	--	--
f/285	do.	Sec. 35, NE cor. NW $\frac{1}{4}$	do.	E. A. Beck	--	19	24	0
f/286	do.	Sec. 35, NE $\frac{1}{2}$ NW $\frac{1}{4}$	do.	do.	--	14	--	0
287	do.	Sec. 35, SE $\frac{1}{2}$ NW $\frac{1}{4}$	do.	do.	--	22	36	0
f/288	do.	Sec. 35, SE $\frac{1}{4}$ SE $\frac{1}{2}$	do.	Mrs. S. F. Beck	--	22	30	0
290	do.	Sec. 34, NE cor.	do.	do.	--	18	24	0
f/291	13 miles east	Sec. 71, SW cor. SE $\frac{1}{4}$	do.	Ida K. Hale	--	15	36	0
292	do.	Sec. 71, SE cor. SW $\frac{1}{4}$	do.	do.	--	25	36	0
293	12 $\frac{1}{2}$ miles east	Sec. 71, cen. SW $\frac{1}{4}$	do.	J. Kinnibrough	--	31	36	0
f/294	12 miles east	Sec. 21, NE cor.	C. T. R. R. blk. C	C. M. McQuiston	--	23	36	--

L. P. Huggins, Project Superintendent

No.	Water Level		Pump and power b/	Use of water c/	Topographic situation	Supply d/	Remarks
	Depth below measuring point (feet)	Date of measurement					
267	15	Oct. 21, 1936	C,W	S	River bottoms	A	Concrete casing.
268	17	e/	C,W	D	do.	A	Concrete casing. Owner reported 1 foot drawdown after pumping 4 gallons a minute
269	14	Oct. 21, 1936	C,W	D	--	A	Do. for 4 hours.
270	10	do.	C,W	D	River bottoms	A	Brick casing. Owner reported mineral taste.
271	16	Oct. 19, 1936	C,W	D	Rolling	A	Brick casing.
272	9	do.	C,W	D	do.	A	Concrete casing.
273	9	do.	B,H	D	--	A	Do.
274	15	do.	C,W	D	--	A	Do.
275	17	e/	C,W	D	Flat	A	Wood curb; metal casing.
276	21	Oct. 21, 1936	C,W	D	do.	A	Wood curb. Owner reported mineral taste and 3 feet drawdown after pumping 4 gal-
277	25	Oct. 19, 1936	C,W	D	Rolling	A	Concrete cas- lons a minute for 4 hours. ing.
278	25	do.	C,W	D	--	A	Do.
279	17	Oct. 21, 1936	C,W	S	Rolling	A	Reported mineral taste.
280	25	do.	C,W	D	do.	A	Do.
281	19	do.	C,W	D	Undulating	A	Brick casing. Tenant reported 5 feet drawdown after pumping 6 gallons a minute
282	15	do.	B,H	D	Flat	A	Wood casing. for 6 hours.
283	23	do.	C,W	I,S	Rolling	--	Concrete casing. Estimated yield, 3 gallons a minute.
284	--	--	B,H	D	do.	A	Wood curb.
285	9	Oct. 21, 1936	C,W	D,S	Breaks	--	Concrete casing.
286	4	do.	--	D,S	do.	--	Wood curb.
287	8	do.	C,W	D,S	do.	A	Brick casing. Owner reported slight drawdown after pumping 5 gallons a minute
288	13	do.	C,W	D	Sand dunes	A	Concrete casing. for 24 hours.
290	17	do.	C,G,4	D	do.	A	Do.
291	13	Oct. 23, 1936	B,H	D	Draw	--	Rock casing.
292	20	do.	C,W	D	do.	A	Concrete casing. Estimated yield, 4 gallons a minute.
293	28.5	do.	B,H	D	Flat	A	Rock casing.
294	--	--	B,H	D	do.	A	Concrete casing.

Records of wells and springs in Knox County--Continued

No.	Distance from Benjamin	Section or Labor	Survey and Block or League	Owner	Date completed	Depth of well (ft.)	Diameter of well (in.)	Height of measuring point above ground (ft.) _{a/}
295	12 miles east	Sec. 21, NW cor. NE ¹ / ₄	C. T. R. R. blk. C	J. Kinnibrough	--	28	36	0
f/296	11½ miles east	Sec. 21, NE cor. NW ¹ / ₄	do.	do.	--	18	36	--
297	do.	Sec. 22, SW cor. NW ¹ / ₄	do.	Chas. Hobart	--	18	36	2
f/298	13 miles east	Lab. 10, NW cor.	D. G. Burnet, League 23	J. H. Bates	--	27	36	3
f/299	11 miles east	Lab. 10, SW ¹ / ₄	D. G. Burnet, League 21	John Andres	--	20	36	3
3/300	11½ miles east	Lab. 7, NE cor.	do.	J. Herring	--	16	36	3
f/301	13 miles east	Lab. 5, NW cor.	D. G. Burnet, League 23	O. L. McCulloch	--	42	36	2
f/302	11½ miles east	Lab. 5, SE cor.	D. G. Burnet, League 21	A. F. Huskinson	--	26	36	2
f/303	13 miles east	Sec. 22, NE cor.	D. & W. R. R. blk. 2	W. R. Lytle	1917	19	36	4
304	11 miles east	Lab. 2, NW cor.	D. G. Burnet, League 21	J. Keeler	--	37	36	0.5
305	12 miles east	Sec. 23, cen. E line NW ¹ / ₄	D. & W. R. R. blk. 2	J. A. Hendricks	1926	27	36	3
f/306	do.	Lab. 1, SE cor.	D. G. Burnet, League 21	Joe Bellinghausen	1935	19	36	3
307	13 miles east	Sec. 17, cen. N line W ¹ / ₃	D. & W. R. R. blk. 2	Laura Butler	--	31	36	3.5
f/308	13½ miles east	Sec. 18, SW cor. NW ¹ / ₄	do.	Holon Smith	--	32	36	3.5
f/309	12½ miles southeast	Sec. 23, cen. E line SE ¹ / ₄	do.	Mrs. -- Camp	--	26	36	2
310	13½ miles east	Sec. 24, SE ¹ / ₄	do.	F. A. Doss	--	37	36	3
f/311	15 miles southeast	Sec. 25, SW ¹ / ₂ SW ¹ / ₄	do.	J. Corvency	--	42	36	2
f/312	14 miles southeast	Sec. 25, SE cor.	do.	Calhoun Campbell	--	42	36	3
f/313	do.	Sec. 28, NE cor. SE ¹ / ₄	do.	L. A. Humphrey	--	41	36	4.5
314	do.	Sec. 28, SE cor. SW ¹ / ₄	do.	G. L. Mays	--	40	36	4
f/315	14½ miles southeast	Sec. 30, NE ¹ / ₄ SE ¹ / ₄	do.	-- Ellicott	--	32	36	3.5
316	13 miles southeast	Sec. 78, SE cor. NW ¹ / ₄	do.	Maggie Smith	--	33	36	4
f/317	do.	Sec. 29, NW ¹ / ₄ NW ¹ / ₄	do.	H. M. Michaels	--	35	36	3
f/318	do.	Sec. 27, NE cor. SE ¹ / ₄	do.	Joe Warren	--	33	36	2.5
320	12½ miles southeast	Sec. 27, NW ¹ / ₄ SW ¹ / ₄	do.	Chas. Matlock	--	33	36	3.5

a/ Measuring point was usually top of casing, top of well curb, or top of pump base.

b/ B, bucket; C, cylinder; Cf, centrifugal; E, electric; G, gasoline; H, hand; S, steam; W, windmill; number indicates horsepower.

c/ D, domestic; I, irrigation; Ind, industrial; N, not used; P, public; S, stock.

L. P. Huggins, Project Superintendent

No.	Water Level		Pump and power b/	Use of water c/	Topographic situation	Supply d/	Remarks
	Depth below measuring point (feet)	Date of measurement					
295	25	Oct. 26, 1936	C,W	D	Rolling	A	Concrete casing. Estimated yield, 4 gallons a minute.
296	--	--	B,H	D	do.	A	Rock casing.
297	15	Dec. 22, 1936	C,W	D	River bottoms	A	Concrete casing. Owner reported slight drawdown after pumping 4 gallons a minute
298	23.5	Dec. 23, 1936	C,W	D	Rolling	A	Brick casing. Owner reported salty taste. for 24 hours.
299	16.5	Dec. 22, 1936	C,W	D	Flat	A	Owner reported slightly salty taste.
300	13	do.	B,H	D	Hill-side	A	Concrete casing. Owner reported water in sand.
301	37	Dec. 23, 1936	C,W	D	Rolling	A	Concrete casing. Tenant reported slightly salty taste and slight drawdown after
302	21	Dec. 22, 1936	C,W	D	do.	A	pumping 4 gallons a minute for 24 hours. Concrete casing.
303	10.5	Dec. 25, 1936	C,W	D	Flat	A	Do.
304	29	Dec. 22, 1936	C,W	D	Rolling	A	Do.
305	24	do.	C,W	D	Flat	W	Concrete casing. Tenant reported 3 feet drawdown after pumping 4 gallons a minute
306	16	do.	B,H	D	do.	A	Concrete casing. Owner reported water in sand. for 1 hour.
307	27.5	Dec. 23, 1936	C,W	D	Rolling	A	Concrete casing.
308	25.5	do.	C,W	D	do.	A	Do.
309	20	Dec. 22, 1936	C,W	D	do.	A	Do.
310	32	Dec. 23, 1936	C,W	D	do.	A	Do.
311	32	Dec. 22, 1936	C,W	D	do.	A	Do.
312	31.5	Dec. 23, 1936	C,W	D	do.	A	Do.
313	36	do.	C,W	D	do.	A	Do.
314	31	do.	C,H	D	do.	A	Do.
315	22.5	do.	C,W	D	do.	A	Concrete casing. Owner reported slight drawdown after pumping 4 gallons a minute
316	29	Dec. 22, 1936	C,W	D	Flat	A	Do. for 24 hours.
317	27	do.	B,H	D	Rolling	A	Concrete casing.
319	25.5	Dec. 23, 1936	C,W	D	Flat	A	Do.
320	29	do.	C,W	D	do.	A	Do.

c/ A, supply reported permanent or adequate for designated use; W, supply reported weak.

d/ Water level reported.

/ No water sample collected for analysis.

Records of wells and springs in Knox County--Continued

No.	Distance from Benjamin	Section or Labor	Survey and Block or League	Owner	Date completed	Depth of well (ft.)	Diameter of well (in.)	Height of measuring point above ground (ft.) a/
f/321	12½ miles southeast	Sec. 100, SE cor. SW¼	D. & W. R. R. blk. 2	R. H. Howell	1934	25	36	2
322	11½ miles southeast	Sec. 100, SW cor. NW¼	do.	Mrs. --- Huskinson	--	43	36	3
f/323	11 miles southeast	Lab. 1, NE cor.	D. G. Burnet, League 16	Frank Knapp	--	25	36	3
f/324	do.	Sec. 99, NW cor.	D. & W. R. R. blk. 2	W. H. Machen	--	16	36	1
325	10½ miles east	Lab. 2, NW cor.	D. G. Burnet, League 20	A. A. Dusterhouse	--	30	36	2.5
f/326	do.	Lab. 4, NW cor.	do.	L. Loran	1900	23	--	0
f/327	9½ miles east	Lab. 12, cen. S line	D. G. Burnet, League 16	A. F. Homer	--	27	36	2
328	9 miles east	Lab. 14, cen. W line	do.	John Arvis	--	24	36	2
f/329	8½ miles southeast	Lab. 12, cen. S line	D. G. Burnet, League 15	A. Wilde	--	35	--	2.5
f/330	8 miles east	Lab. 13, SE cor.	D. G. Burnet, League 14	A. Schumacher	1910	22	36	4
f/331	7½ miles east	Con. W line S½	D. G. Burnet, League 22	J. C. League	--	24	30	--
332	6 miles east	Sec. 102, NE cor. NW¼	H. & T. C. R. R. blk. C	Joe Redder	--	14	30	--
f/333	6½ miles east	Sec. 103, cen. S½	do.	do.	--	14	30	--
f/334	7 miles east	SW¼ SW¼	Mrs. E. Furd	R. R. Killam	--	16	--	0
f/335	do.	Sec. 19, S cor.	R. H. Hunter	W. T. McClain	--	8	48	0
336	6½ miles southeast	Lab. 11, NE cor.	D. G. Burnet, League 12	F. J. Redden	--	29	36	3
f/337	7 miles southeast	Lab. 13, SW cor.	D. G. Burnet, League 13	T. M. Kuehler	--	14	36	0
338	8 miles southeast	Lab. 10, cen. E line	D. G. Burnet, League 14	L. Friske	1921	26	36	3
f/339	7 miles southeast	Lab. 8, NE¼ SE¼	D. G. Burnet, League 12	F. L. Stengel	--	20	36	0.5
f/340	6½ miles southeast	Lab. 11, SW cor.	D. G. Burnet, League 11	E. J. Smith	--	25	30	0
f/341	7½ miles southeast	Lab. 7, NE cor.	do.	H. S. Jungman	--	32	30	0
f/342	do.	Lab. 8, SW cor.	D. G. Burnet, League 13	S. E. Williamson	1914	31	36	1
f/343	8½ miles southeast	Lab. 4, SW cor.	do.	H. M. Michaels	1910	29	36	4
f/344	9 miles southeast	Lab. 2, NW cor.	D. G. Burnet, League 14	do.	--	24	36	3
345	9½ miles southeast	Sec. 80, N side	D. & W. R. R. blk. 2	do.	--	25	36	2
346	do.	Lab. 3, SE cor.	D. G. Burnet, League 14	do.	--	16	36	3

L. P. Huggins, Project Superintendent

No.	Water Level		Pump and power <u>b/</u>	Use of water <u>c/</u>	Topographic situa-	Sup- ply <u>d/</u>	Remarks
	Depth below measuring point (feet)	Date of measurement					
321	22	Dec. 22, 1936	C,W	D	Flat	A	Concrete casing.
322	27	do.	C,W	D	do.	A	Do.
323	18	do.	C,W	D	do.	A	Owner reported slight drawdown after pumping 4 gallons a minute for 24 hours.
324	10	do.	C,W	D	Rolling	A	Concrete casing.
325	25.5	do.	B,H	D	Flat	A	Concrete casing. Owner reported water in sand.
326	19	do.	C,W	D	do.	A	Wood curb.
327	22	do.	C,W	D	do.	A	Concrete casing.
328	19.5	do.	C,W	D	Rolling	A	Do.
329	29.5	do.	C,W	D	do.	A	Brick casing.
330	14.5	Dec. 21, 1936	C,W	D	do.	A	Concrete casing.
331	--	--	B,H	S	do.	W	Do.
332	--	--	C,W	S	Breaks	W	Rock casing. Reported 4 feet drawdown after pumping 3 gallons a minute for 24 hours.
333	6	<u>e/</u>	B,H	D	Rolling	A	Concrete casing.
334	8	Oct. 28, 1936	B,H	--	Breaks	W	Concrete casing. Tenant reported water with mineral taste in clay.
335	3	<u>e/</u>	B,H	S	River bottoms	A	Metal casing. Tenant reported salty taste.
336	25.5	Dec. 21, 1936	B,H	D	Sand hill	A	Concrete casing.
337	11	do.	C,W	D	do.	A	Do.
338	21	do.	C,W	D	do.	A	Do.
339	13	do.	C,W	D	do.	A	Do.
340	20	Nov. 14, 1936	C,W	D	Sand dunes	A	Concrete casing. Owner reported mineral taste and slight drawdown after pumping 4 gallons a minute for 6 hours.
341	22.5	<u>e/</u>	C,W	I,D	Rolling	A	Concrete casing. Owner reported mineral taste. Reported 27 wells dug in 1900 without striking water
342	21.5	Dec. 21, 1936	C,W	D	Sand hill	A	Concrete casing.
343	17	do.	B,H	D	do.	A	Concrete casing. Owner reported water in sand.
344	15	do.	B,H	D	do.	A	Do.
345	13	do.	B,H	D	Rolling	A	Do.
346	13	Dec. 22, 1936	B,H	S	Flat	A	Do.

-9-
Records of wells and springs in Knox County--Continued

No.	Distance from Benjamin	Section or Labor	Survey and Block or League	Owner	Date completed	Depth of well (ft.)	Diameter of well (in.)	Height of measuring point above ground (ft.) a/
f/347	9 miles southeast	Lab. 6, NW $\frac{1}{4}$	D. G. Burnet, League 15	-- Davis	1933	42	--	0
f/348	10 miles southeast	Lab. 2, SW cor.	do.	Joe Blake	1916	21	36	0.5
f/349	10 $\frac{1}{2}$ miles southeast	Sec. 81, cen. E line	D. & W. R. R. blk. 2	W. S. Ledbetter	--	39	36	4
f/350	10 miles southeast	Sec. 81, SE cor. NW $\frac{1}{4}$	do.	J. W. Douglass	--	32	30	3
f/351	10 $\frac{1}{2}$ miles southeast	Sec. 81, SE cor. SW $\frac{1}{4}$	do.	W. C. Hill	--	31	30	2
f/353	11 $\frac{1}{2}$ miles southeast	Sec. 77, NE $\frac{1}{4}$ NW $\frac{1}{4}$	do.	Dan Weaver	--	29	36	3
f/354	do.	Sec. 78, cen. E line NE $\frac{1}{4}$	do.	Dr. W. F. Farrington	--	31	30	3
f/355	12 miles southeast	Sec. 73, NE cor.	do.	J. B. Roberts	--	30	30	2
f/356	11 $\frac{1}{2}$ miles southeast	Sec. 78, SE cor. SW $\frac{1}{4}$	do.	A. J. Johnson	--	33	30	3
f/357	11 miles southeast	Sec. 72, NE cor.	do.	J. K. Johnson	--	38	6	0.5
358	10 $\frac{1}{2}$ miles southeast	Sec. 79, cen. S line SW $\frac{1}{4}$	do.	Roy Barron	--	25	30	0
f/359	9 $\frac{1}{2}$ miles southeast	Sec. 80, SW cor.	do.	E. E. Akers	--	26	30	3
360	do.	Sec. 97, NE cor.	do.	C. C. Burns	--	23	30	3
f/361	10 miles southeast	Sec. 71, NW cor. NE $\frac{1}{4}$	do.	J. D. Henderson	--	54	30	3
f/362	9 $\frac{1}{2}$ miles southeast	Sec. 96, cen. S $\frac{1}{2}$	do.	K. G. Stroom	--	30	30	0
f/363	9 miles southeast	Sec. 94, SW cor. NE $\frac{1}{4}$	do.	R. C. Partridge	--	24	30	1
f/364	8 $\frac{1}{2}$ miles southeast	Lab. 2, SW cor.	D. G. Burnet, League 11	Bigo Takarsloy	--	34	30	0
f/365	do.	Lab. 1, SW $\frac{1}{4}$	D. G. Burnet, League 10	G. E. Rodgers	--	28	30	3
366	8 miles south	Lab. 5, NE cor.	D. G. Burnet, League 9	Louise Ingram	--	22	30	0
367	8 $\frac{1}{2}$ miles south	Lab. 4, NW cor.	do.	J. W. Howell	--	30	30	0
f/368	8 miles south	Lab. 7, cen. E line	D. G. Burnet, League 8	do.	--	43	30	0
369	7 $\frac{1}{2}$ miles south	Lab. 10, SW cor.	D. G. Burnet, League 9	Fred N. Decker	--	38	30	0
f/370	7 miles southeast	Lab. 8, SE cor.	D. G. Burnet, League 10	T. D. Herfel	--	40	30	0
f/371	6 $\frac{1}{2}$ miles southeast	Lab. 11, NW cor.	D. G. Burnet, League 9	John Michaels	--	25	30	0
f/372	6 $\frac{1}{2}$ miles south	Lab. 12, NW $\frac{1}{4}$	D. G. Burnet, League 7	M. H. Vorhies	--	23	30	1
f/373	7 miles south	Lab. 9, NE cor.	D. G. Burnet, League 6	H. E. Clouts	--	17	30	0
374	6 $\frac{1}{2}$ miles south	Lab. 13, SW cor.	do.	W. H. Clouts	--	24	30	3
f/375	6 miles south	Lab. 14, cen. E line	D. G. Burnet, League 5	J. H. Howell	--	25	30	3.5

-10-
L. P. Huggins, Project Superintendent

No.	Water Level		Pump and power <u>b/</u>	Use of water <u>c/</u>	Topographic situation	Supply <u>d/</u>	Remarks
	Depth below measuring point (feet)	Date of measurement					
347	36	Dec. 22, 1936	C,W	D	Rolling	A	Bored well.
348	14	do.	C,W	D	do.	A	Concrete casing. Owner reported slight drawdown after pumping 4 gallons a minute
349	28	Dec. 21, 1936	C,W	D	do.	A	Do. for 24 hours.
350	19	Dec. 10, 1936	C,W	D	do.	A	Do.
351	25	do.	C,W	D	do.	A	Do.
353	22	Dec. 23, 1936	B,H	D	Flat	A	Concrete casing. Owner reported water in sand.
354	19	Dec. 10, 1936	C,W	D	do.	A	Concrete casing.
355	21	do.	C,W	D	do.	A	Do.
356	21	do.	C,W	D	do.	A	Do.
357	23	do.	C,H	D	do.	A	Drilled well. Steel casing.
358	18	do.	C,W	D	do.	A	Concrete casing. Owner reported slight drawdown after pumping 4 gallons a minute
359	16	do.	C,W	D	do.	A	Do. for 24 hours.
360	13	do.	B,H	D	Rolling	A	Concrete casing.
361	34	do.	C,W	D	do.	A	Wood casing.
362	14	Nov. 14, 1936	B,H	D	do.	A	Brick casing.
363	19	Dec. 10, 1936	C,W	D	Flat	A	Owner reported slight drawdown after pumping 4 gallons a minute for 24 hours.
364	13	Nov. 14, 1936	C,W	--	do.	A	Concrete casing. Tenant reported mineral taste.
365	16	Dec. 10, 1936	C,W	D	do.	A	Concrete casing. Owner reported slight drawdown after pumping 4 gallons a minute
366	13	Nov. 14, 1936	C,W	D	do.	A	Do. for 24 hours.
367	15.2	do.	C,W	I,D	Draw	A	Do.
368	22.5	do.	C,W	D	Sand dunes	A	Do.
369	13	do.	C,W	I,D	do.	A	Do.
370	36	do.	C,W	D	do.	A	Concrete casing. Owner reported slight mineral taste.
371	21.5	do.	C,W	D	do.	A	Do.
372	13	<u>e/</u>	C,H	D	Rolling	A	Concrete casing.
373	15	Nov. 13, 1936	C,W	D	Flat	A	Do.
374	15	<u>e/</u>	C,W	S	Valley	A	Concrete casing. Owner reported 2 feet drawdown after pumping 3 gallons a minute
375	20	<u>e/</u>	C,W	D	Sand dunes	A	Concrete casing. Tenant reported mineral taste. for 6 hours

Records of wells and springs in Knox County--Continued

No.	Distance from Benjamin	Section or Labor	Survey and Block or League	Owner	Date completed	Depth of well (ft.)	Diameter of well (in.)	Height of measuring point above ground (ft.)
376	6 $\frac{1}{2}$ miles south	Lab. 14, SE cor.	D. G. Burnet, League 5	E. F. Jones	--	37	30	3
f/377	7 $\frac{1}{2}$ miles south	Lab. 8, NW cor.	do.	H. Hackfield	--	29	--	--
378	do.	Lab. 11, cen. S line	do.	S. L. Sibly	--	21	30	3.5
f/379	8 miles south	Lab. 8, cen. W line	D. G. Burnet, League 6	J. W. Howell	--	27	30	0
380	7 $\frac{1}{2}$ miles south	Lab. 7, cen.	do.	C. A. Richardson	--	28	30	0
f/381	8 $\frac{1}{2}$ miles south	Lab. 7, cen. E line	D. G. Burnet, League 5	C. F. Carm	--	23	30	0
f/382	do.	Lab. 7, SW cor.	do.	Roy Smith	--	22	24	2.5
f/383	do.	Lab. 5, NE cor.	do.	Mrs. J. M. Snelson	--	15	60	0
384	9 miles south	Lab. 5, cen. S line	do.	G. F. Stubbs	1921	20	30	3
385	9 $\frac{1}{2}$ miles south	Sec. 83, SE cor.	D. & W. R.R. blk. 2	M. F. Whitten	1916	23	30	--
f/386	do.	Sec. 83, SW cor.	do.	Joe Smith	--	26	30	0
387	9 miles south	Sec. 83, NE cor. SW $\frac{1}{2}$	do.	W. F. Waldrip	--	26	30	0
f/388	do.	Sec. 83, cen. NW $\frac{1}{2}$	do.	L. P. King	--	23	30	0
f/389	7 $\frac{1}{2}$ miles south	Sec. 84, NE cor. NW $\frac{1}{2}$	do.	H. Hackfield	--	30	30	3
390	8 miles south	Sec. 84, cen. NW $\frac{1}{2}$	do.	B. P. Denton	--	32	30	0
f/391	9 miles southwest	Sec. 2, NE cor.	H. S. Melven	R. A. Campbell	--	Spring	--	--
392	9 miles south	NE cor. S $\frac{1}{2}$	Hrs. of J. Garrard	J. L. Armstrong	--	26	30	0
f/393	do.	Cen. E line	do.	do.	--	24	50	0
394	10 miles south	Cen. S line cen. 1/3	do.	C. N. Armstrong	--	23	30	0
395	10 $\frac{1}{2}$ miles southwest	Sec. 99, SW cor. E $\frac{1}{2}$	J. A. Fanning	B. B. Campbell	--	38	5 $\frac{1}{2}$	0
f/396	12 miles southwest	Sec. 64, N cor.	H. & T. C. R.R. blk. 13	P. C. Large	--	28	30	1.5
f/397	do.	Sec. 64, cen. NE line	do.	W. H. Hutchison	--	34	30	2.5
f/398	do.	Sec. 63, S cor.	do.	F. E. Walker	--	31	--	4
399	16 miles southwest	W $\frac{1}{2}$	Elijah Boren	J. I. Davis	--	17	30	0
f/400	15 $\frac{1}{2}$ miles southwest	NE cor.	do.	Tom Osborne	--	17	30	--
f/401	15 miles southwest	NE $\frac{1}{2}$ NW $\frac{1}{2}$	do.	T. H. Burnet	--	18	30	0
f/402	15 $\frac{1}{2}$ miles southwest	SW cor. NE $\frac{1}{2}$	do.	do.	--	16	30	0

L. P. Huggins, Project Superintendent

c.	Water Level		Pump and power <u>b/</u>	Use of water <u>c/</u>	Topographic situa-	Sup- ply <u>d/</u>	Remarks
	Depth below measur- ing point (feet)	Date of measure- ment					
376	22	<u>e/</u>	C,W	D	Sand dunes	A	Concrete casing. Estimated yield 3 gal- lons a minute.
377	24.5	Jan. 1, 1937	C,W	D	Hilltop	A	Galvanized iron casing. Foreman reported 3 feet drawdown after pumping 3 gallons a minute for 6 hours.
378	17.3	do.	C,W	D	Flat	A	Concrete casing. minute for 6 hours.
379	14	Nov. 13, 1936	C,W	D	do.	A	Concrete casing. Owner reported slight mineral taste.
380	23	<u>e/</u>	C,W	D	do.	A	Concrete casing.
381	16	Nov. 13, 1936	C,W	D	do.	A	Do.
382	14	<u>e/</u>	C,W	D	Sand dunes	A	Steel casing.
383	12	<u>e/</u>	B,H	D	Flat	A	Galvanized iron casing.
384	11	Dec. 11, 1936	C,W	D	do.	A	Concrete casing. Owner reported slight drawdown after pumping 4 gallons a minute
385	17.5	<u>c/</u>	C,W	D	do.	A	Concrete casing. Reported for 24 hours. well originally 39 feet deep with 1½ feet
386	15	Nov. 13, 1936	C,W	D	do.	A	Concrete casing. of water.
387	17.5	do.	C,W	D	Rolling	A	Do.
388	17	do.	C,W	D	Flat	A	Do.
389	25	<u>e/</u>	C,W	D	Rolling	A	Wood curb; concrete casing. Estimated yield, 3 gallons a minute. Tenant report-
390	26	Nov. 13, 1936	C,W	D	do.	A	Concrete casing. Owner ed mineral taste. reported 1 foot drawdown after pumping 4
391	Flows	do.	None	S	River bank	A	Estimated gallons a minute for 12 hours. flow, 40 gallons a minute from 1 opening.
392	19	do.	C,W	D	Flat	A	Concrete casing. Reported mineral taste.
393	14	do.	C,W	D	do.	A	Concrete casing. Reported mineral taste.
394	19.5	do.	C,W	D	Rolling	A	Concrete casing.
395	22	do.	C,W	D	Flat	A	Drilled well. Galvanized iron casing.
396	26.5	Dec. 9, 1936	B,H	--	Draw	W	Concrete casing.
397	31	do.	C,W	S	Breaks	W	Concrete casing. Owner reported 2 feet drawdown after pumping 3 gallons a minute
398	12	do.	C,W	S	do.	W	Wood curb. Owner reported for 6 hours. 9 feet drawdown after pumping 3½ gallons a
399	13	Nov. 5, 1936	C,W	D	--	A	Concrete casing. minute for 6 hours.
400	3.5	<u>e/</u>	C,W	D	Velley flat	A	Do.
401	14	<u>e/</u>	C,W	D	do.	A	Do.
402	8	<u>e/</u>	C,W	D	do.	A	Concrete casing. Foreman reported 6 feet drawdown after pumping 3 gallons a minute for 12 hours.

Records of wells and springs in Knox County--Continued

No.	Distance from Benjamin	Section or Labor	Survey and Block or League	Owner	Date completed	Depth of well (ft.)	Diameter of well (in.)	Height of measuring point above ground (ft.) <u>a/</u>
403	15 $\frac{1}{2}$ miles southwest	NE cor.	Elijah Boren	T. H. Burnet	--	13	30	--
f/404	15 miles southwest	Sec. 51, NW cor.	do.	R. B. Bush	--	13	30	--
405	do.	Sec. 53, SW cor.	do.	do.	--	31	30	--
f/406	do.	do.	do.	do.	--	29	30	0
407	do.	do.	do.	do.	--	28	30	0
f/408	14 $\frac{1}{2}$ miles southwest	do.	do.	do.	--	35	30	0
409	do.	Sec. 53, cen. S line W $\frac{1}{2}$	do.	do.	--	24	30	0
410	14 miles southwest	Sec. 53, S $\frac{1}{2}$ E $\frac{1}{2}$	do.	do.	--	26	30	0
411	13 $\frac{1}{2}$ miles southwest	Sec. 59, E $\frac{1}{2}$	H.&T.C.R.R. blk. 13	R. C. Hamlin	--	14	--	5
f/412	14 miles southwest	Sec. 52, NW cor. NE $\frac{1}{4}$	Levi Johnson	Charlie Burleson	--	24	30	0
413	do.	Sec. 5, W side	H.E.&W.T.R.R.	R. B. Bush	--	27	5 $\frac{1}{2}$	0
414	13 $\frac{1}{2}$ miles southwest	Sec. 53, SW cor.	Elijah Boren	B. F. Farmer	--	20	30	0
f/416	11 $\frac{1}{2}$ miles southwest	Sec. 56, NE cor. W 1/3	Geo. G. Alford	-- Davis	--	17	5 $\frac{1}{2}$	0
f/417	12 miles southwest	Sec. 56, SE cor. W $\frac{1}{2}$	do.	J. W. Green	--	12	--	0
f/418	do.	do.	do.	do.	--	42	--	0
f/419	do.	Sec. 56, SE cor. W 1/3	do.	Mrs. W. D. Lee Estate	--	6	30	--
420	do.	Sec. 55, cen.	G. T. Slaughter	J. W. Henderson	--	27	--	--
421	11 $\frac{1}{2}$ miles southwest	Sec. 55, cen. N line E $\frac{1}{2}$	do.	W. H. Gornett	--	34	30	--
f/422	12 miles southwest	Sec. 54, NE cor.	Geo. G. Alford	Fred Papeworth	--	24	--	0
f/423	do.	Sec. 54, NW cor. E $\frac{1}{2}$	do.	M. M. Youngblood	--	26	30	0
f/424	12 $\frac{1}{2}$ miles southwest	Sec. 54, SE cor. W $\frac{1}{2}$	do.	A. G. Yarnett	--	22	--	--
425	12 miles southwest	E side	F. Papeworth	L. L. Houston	--	40	30	0
f/426	12 $\frac{1}{2}$ miles south	Sec. 5, NE cor.	H.E.&W.T.R.R.	B. F. Farmer	--	42	5 $\frac{1}{2}$	0
f/427	do.	Sec. 24, cen. N line	H.&T.C. R.R. blk. 14	G. G. Carpenter	--	25	30	0
428	do.	Sec. 24, cen. N line NW $\frac{1}{4}$	do.	R. B. Bush	--	39	30	0

a/ Measuring point was usually top of casing, top of well curb, or top of pump base.

b/ D, bucket; C, cylinder; Cf, centrifugal; E, electric; G, gasoline; H, hand; S, steam; W, windmill; number indicates horsepower.

c/ D, domestic; I, irrigation; Ind, industrial; N, not used; P, public; S, stock.

L. P. Huggins, Project Superintendent

No.	Water Level		Pump and power <u>b/</u>	Use of water <u>c/</u>	Topographic situation	Supply <u>d/</u>	Remarks
	Depth below measuring point (feet)	Date of measurement					
403	2.5	<u>e/</u>	B,H	D	Valley	W	Concrete casing.
404	--	--	C,W	D	do.	W	Concrete casing. Reported 2 feet drawdown after pumping 3 gallons a minute for 3
405	--	--	B,H	--	Rolling	W	Concrete casing. <u>hours.</u>
406	27	Nov. 5, 1936	C,W	S	do.	W	Concrete casing. Foreman reported mineral taste and yield, 4 gallons a minute.
407	22	do.	C,W	S	do.	W	Concrete casing.
408	23	do.	C,W	S	do.	W	Concrete casing. Foreman reported mineral taste and yield, 4 gallons a minute.
409	21	do.	B,H	D	Flat	W	Concrete casing.
410	24	do.	B,H	D	do.	W	Do.
411	11	Dec. 9, 1936	C,W	D	Valley	A	Wood casing.
412	18.5	Nov. 5, 1936	B,H	D	Flat	W	Concrete casing. Owner reported mineral taste.
413	19	do.	C,W	D	do.	A	Drilled well. Foreman reported mineral taste.
414	16	do.	C,W	D	Ravine	A	Concrete casing. Owner reported 3 feet drawdown after pumping 4 gallons a minute
416	12.5	Nov. 6, 1936	C,H	D	River bottoms	A	Drilled well. Galvanized iron casing. Tenant reported mineral <u>for 6 hours.</u>
417	9.5	do.	B,H	D	Hill-side	A	Wood curb. Tenant reported mineral taste.
418	38	<u>e/</u>	None	N	Breaks	--	
419	--	--	--	N	do.	--	Brick casing.
420	--	--	B,H	D	do.	A	Wood curb.
421	29	<u>e/</u>	C,W	D	Rolling	A	Concrete casing. Owner reported slight drawdown after pumping 3 gallons a minute
422	17.5	Nov. 6, 1936	C,W	D	Flat	A	Owner reported mineral taste. Reported wells failed in 1898. <u>for 12 hours.</u>
423	20	do.	C,W	D	do.	A	Concrete casing. Tenant reported mineral taste.
424	--	--	C,W	D	do.	A	Owner reported mineral taste.
425	25.5	Nov. 6, 1936	C,W	D	do.	A	Concrete casing.
426	32	Nov. 5, 1936	C,W	D	do.	A	Drilled well. Galvanized iron casing. Tenant reported 6 feet drawdown after
427	21	do.	C,W	D	--	A	<u>pumping 4 gallons a minute for 12 hours.</u> Concrete casing. Reported mineral taste.
428	26	<u>e/</u>	C,W	D	Flat	A	Concrete casing.

d/ A, supply reported permanent or adequate for designated use; W, supply reported weak.

e/ Water level reported.

f/ No water sample collected for analysis.

Records of wells and springs in Knox County--Continued

No.	Distance from Benjamin	Section or Labor	Survey and Block or League	Owner	Date completed	Depth of well (ft.)	Diameter of well (in.)	Height of measuring point above ground (ft.) a/
f/429	13 miles south	Sec. 24, NE cor. SW $\frac{1}{4}$	H.&T.C.R.R. blk. 14	Kinney & Wilbanks	--	18	30	0
f/430	12 $\frac{1}{2}$ miles south	cen.	Nancy Alden	W. O. Griffith	--	23	30	0
431	do.	do.	do.	do.	--	13	30	0
f/432	do.	Sec. 54, E $\frac{1}{2}$	D. & W. R. R. blk. 2	T.H. Pannell	--	20	--	--
f/433	12 miles south	Sec. 54, cen.	do.	R.F. Varnell	--	15	30	0
f/434	12 $\frac{1}{2}$ miles south	Sec. 54, W side	do.	Mrs. T. H. Pannell	--	19	--	--
435	do.	NW cor.	Nancy Alden	W. O. Griffith	--	42	30	--
436	do.	Sec. 6, SE cor.	H.E.&W.T.R.R.	A. L. Lea	--	22	5 $\frac{1}{2}$	0
f/437	12 miles south	Sec. 54, W side	D. & W. R. R. blk. 2	W. O. Griffith	--	24	30	0
f/438	do.	Sec. 6, cen. E line	H.E.&W.T.R.R.	A. L. Lea	--	17	30	--
f/439	11 $\frac{1}{2}$ miles south	Sec. 6, E $\frac{1}{2}$	do.	do.	--	17	30	0
f/440	11 miles south	Sec. 53, SE cor. NW $\frac{1}{4}$	D. & W. R. R. blk. 2	Mrs. J. S. Wilson	--	20	30	--
442	11 $\frac{1}{2}$ miles south	Sec. 53, SW cor.	do.	Union Grove School	--	18	30	--
f/443	do.	Sec. 53, cen. S line SE $\frac{1}{4}$	do.	A. P. Denton	--	29	30	--
444	do.	Sec. 54, SE cor. NE $\frac{1}{4}$	do.	A. R. Forsythe	--	29	--	0
445	12 miles south	Sec. 55, SW cor. NW $\frac{1}{4}$	do.	W. R. Jones	--	19	--	0
446	11 $\frac{1}{2}$ miles south	Sec. 52, SE cor. SW $\frac{1}{4}$	do.	Benton Anderson	--	28	--	0
f/447	do.	Sec. 55, NE cor. NW $\frac{1}{4}$	do.	W. N. Lewis	1924	30	30	0
f/448	do.	Sec. 52, SW $\frac{1}{4}$ SE $\frac{1}{4}$	do.	B. C. Anderson	--	50	--	--
f/449	do.	Sec. 52, SE cor.	do.	Tom White	--	33	30	0
450	12 miles south	Sec. 55, SE cor.	do.	J. H. McGee	--	53	--	0
f/451	do.	Sec. 49, NE $\frac{1}{4}$ NW $\frac{1}{4}$	do.	A. E. Hopson	--	44	5 $\frac{1}{2}$	--
452	do.	Sec. 49, NW cor. NE $\frac{1}{4}$	do.	N. B. Webb	--	24	36	0
453	11 miles south	Sec. 51, SE $\frac{1}{4}$ SW $\frac{1}{4}$	do.	C. W. Pullig	--	25	--	0
456	do.	Sec. 57, NW cor. NE $\frac{1}{4}$	do.	Mrs. -- Gore	--	29	30	0
457	do.	Sec. 57, cen. N line NE $\frac{1}{4}$	do.	Betty G. Davis	--	30	30	--
f/458	11 $\frac{1}{2}$ miles south	Sec. 57, SE cor. NE $\frac{1}{4}$	do.	Mrs. -- Pyte	--	46	30	0

L. P. Huggins, Project Superintendent

No.	Water Level		Pump and power <u>b/</u>	Use of water <u>c/</u>	Topographic situation	Supply <u>d/</u>	Remarks
	Depth below measuring point (feet)	Date of measurement					
429	8.5	Nov. 5, 1936	B,H	D	Rolling	A	Concrete casing. Tenant reported mineral taste.
430	3.5	do.	C,W	D	Flat	A	Concrete casing. Owner reported 5 feet drawdown after pumping 4 gallons a minute
431	5	do.	B,H	D	do.	A	Concrete casing. for 12 hours.
432	--	--	B,H	D	do.	A	
433	9	Nov. 5, 1936	C,W	D	do.	A	Concrete casing. Tenant reported yield 4 gallons a minute.
434	--	--	B,H	D	do.	A	Wood curb. Owner reported mineral taste.
435	--	--	C,W	--	Rolling	A	Concrete casing.
436	18	Nov. 5, 1936	B,H	D	do.	A	Drilled well. Galvanized iron casing.
437	16	do.	B,H	S	Flat	A	Concrete casing.
438	--	--	C,W	D	Rolling	A	Concrete casing. Tenant reported slight drawdown after pumping 3 gallons a minute
439	10	<u>e/</u>	B,H	D	Hill-side	A	Concrete casing. for 24 hours. Owner reported mineral taste.
440	11.5	<u>e/</u>	B,H	D	Rolling	A	Concrete casing.
442	--	--	C,H	P	do.	A	Do.
443	--	--	C,H	D	Flat	A	Concrete casing. Owner reported mineral taste.
444	26.5	Nov. 5, 1936	C,W	D	do.	A	Reported slight drawdown after pumping 3 gallons a minute for 12 hours.
445	15	do.	B,H	D	do.	A	
446	21	Nov. 6, 1936	--	D	do.	A	Wood curb.
447	12.5	do.	C,W	D	Rolling	A	Concrete casing. Owner reported mineral taste.
448	--	--	B,H	D	do.	A	
449	31	Nov. 6, 1936	C,H	D	Hilltop	W	Concrete casing.
450	25	Nov. 5, 1936	C,W	D	Rolling	A	Owner reported slight drawdown after pumping 4 gallons a minute for 12 hours.
451	--	--	C,W	D	do.	A	Drilled well. Galvanized iron casing.
452	18	<u>e/</u>	C,W	D	Draw	A	Brick casing.
453	19	Nov. 6, 1936	B,H	D	Rolling	A	
456	25	Nov. 12, 1936	C,W	D	do.	A	Concrete casing.
457	--	--	C,W	D	Flat	A	Do.
458	30	Nov. 12, 1936	C,W	D	Rolling	A	Do.

Records of wells and springs in Knox County--Continued

No.	Distance from Benjamin	Section or Labor	Survey and Block or League	Owner	Date completed	Depth of well (ft.)	Diameter of well (in.)	Height of measuring point above ground (ft.) a/
f/459	11½ miles south	Sec. 57, cen. SE¼	D. & W. R. R. blk. 2	Mrs. C. J. Reese	--	52	30	0
f/460	12 miles south	Sec. 57, cen. E line SW¼	do.	R. D. Wall	--	41	30	0
f/461	do.	Sec. 57, cen. W line SE¼	do.	W. H. Cornett	--	43	--	--
462	do.	Sec. 48, NE cor. NW¼	do.	J. P. Hester	--	43	30	0
f/463	do.	Sec. 48, NW cor. NE¼	do.	L. W. Coates	--	53	30	--
464	do.	Sec. 57, cen. S line SE¼	do.	W. H. Cornett	--	52	30	0
f/465	12½ miles south	Sec. 47, SW cor. NE¼	do.	Salem Hutchinson	--	41	30	0
f/466	12 miles south	Sec. 203, NE cor. NW¼	H. & T. C. R. R. blk. 45	Mrs. J. B. Watson	--	54	30	0
f/467	do.	Sec. 203, NW¼ NW¼	do.	C. B. Teague	1927	3,560	6-5/8	--
468	do.	Sec. 59, SE cor.	D. & W. R. R. blk. 2	Woodward Bros.	--	46	30	0
f/469	11 miles south	Sec. 59, NE cor.	do.	J. P. Hester	--	44	30	0
470	do.	Sec. 60, cen. S line SW¼	do.	J. E. McPherson	--	50	30	--
f/471	10 miles south	Sec. 92, SW cor.	do.	T. F. Dickerson	--	21	30	0
472	9½ miles south	Lab. 2, SW cor.	D. G. Burnet, League 7	T. L. Nesbit	--	22	30	0
f/473	10 miles south	Sec. 92, SE cor. W¼	D. & W. R. R. blk. 2	W. C. Elliott	--	18	30	--
f/474	do.	Sec. 60, NE cor.	do.	G. W. Hammons	--	23	30	0
f/475	11 miles south	Sec. 61, SW cor.	do.	C. O. Jamson	--	29	30	0
476	11½ miles south	Sec. 45, cen. E line NE¼	do.	Horace Roberts	--	31	--	0
f/477	do.	Sec. 45, NE¼ SE¼	do.	do.	--	47	30	0
f/478	12 miles south	Sec. 45, cen. E line SE¼	do.	H. T. Gibbons	--	39	30	--
f/479	do.	Sec. 44, SW¼ SW¼	do.	A. B. Lowery	--	39	30	2
f/480	12½ miles south	Sec. 197, cen. E line	H. & T. C. R. R. blk. 45	B. L. Lowery	--	46	30	2
f/481	do.	Sec. 190, NE cor. NW¼	do.	S. F. Lowery	--	41	30	--
f/482	do.	Sec. 183, NE¼ NW¼	do.	F. M. Harrison	--	53	30	3
f/483	12 miles south	Sec. 43, cen. E line SE¼	D. & W. R. R. blk. 2	J. B. Jones	--	60	30	3
f/484	11½ miles south	Sec. 45, NE cor.	do.	J. C. Sweatt	--	32	30	2

L. P. Huggins, Project Superintendent

No.	Water Level		Pump and power b/	Use of water c/	Topographic situation	Supply d/	Remarks
	Depth below measuring point (feet)	Date of measurement					
459	39	Nov. 12, 1936	C,W	D	Rolling	A	Concrete casing. Water reported to be very hard.
460	36	do.	C,W	D	Flat	A	Do.
461	--	--	--	--	--	--	Well sanded up.
462	35	Nov. 12, 1936	C,W	D	Flat	A	Concrete casing. Owner reported slight drawdown after pumping 3 gallons a minute
463	42	e/	C,W	D	Hilltop	A	Concrete casing. for 9 hours.
464	40	Nov. 12, 1936	C,W	D	Flat	A	Do.
465	32	do.	C,W	D	do.	A	Concrete casing. Reported mineral taste.
466	40	do.	C,W	D	do.	A	Concrete casing. Tenant reported mineral taste and 2 feet drawdown after pumping 4
467	--	--	--	--	--	--	Oil test. gallons a minute for 12 hours. Located 350 feet from N line and 995 feet from W line. Altitude, 1,459 feet. See
468	30	Nov. 12, 1936	C,W	D	Flat	A	Concrete casing. log.
469	40	do.	C,W	D	do.	A	Do.
470	42	e/	C,W	--	Rolling	A	Do.
471	13	Nov. 13, 1936	C,W	D	Flat	A	Do.
472	11	do.	C,W	D	Rolling	W	Concrete casing. Reported 10 feet drawdown after pumping 4 gallons a minute for
473	9	e/	C,W	I,D	Draw	A	Concrete casing. Owner reported 12 hours. ed mineral taste.
474	14.5	Nov. 14, 1936	C,W	D	Flat	A	Concrete casing.
475	22	Nov. 12, 1936	C,H	D	do.	A	Do.
476	27	do.	B,H	D	do.	A	
477	36	do.	C,W	D	do.	A	Concrete casing. Tenant reported slight drawdown after pumping 3½ gallons a minute
478	--	--	B,H	D	do.	A	Concrete casing. for 12 hours.
479	28	Nov. 27, 1936	C,W	D	Rolling	A	Galvanized iron casing.
480	24	do.	C,W	D	do.	A	Concrete casing.
481	21	e/	C,W	D	Flat	A	Do.
482	33	Nov. 27, 1936	C,W	D	do.	A	Do.
483	42	do.	C,W	D	do.	A	Do.
484	23	Nov. 26, 1936	C,W	D	do.	A	Concrete casing. Owner reported 3 feet drawdown after pumping 4 gallons a minute for 24 hours.

Records of wells and springs in Knox County--Continued

No.	Distance from Benjamin	Section or Labor	Survey and Block or League	Owner	Date completed	Depth of well (ft.)	Diameter of well (in.)	Height of measuring point above ground (ft.) _{a/}
f/485	11½ miles south	Sec. 63, SW¼ SW¼	D. & W. R.R. blk. 2	G.A. Branton	--	47	30	2
f/486	do.	Sec. 62, SE cor.	do.	C. A. Hull	--	43	30	2
f/487	do.	Sec. 43, NW¼ NW¼	do.	J. C. Sweatt	--	43	30	0
f/489	do.	Sec. 62, SE¼ SW¼	do.	G.A. Branton	--	42	30	2
f/490	10½ miles south	Sec. 93, SW cor. SE¼	do.	E. Partridge	--	54	30	2.2
f/491	9½ miles south	Sec. 93, NE cor.	do.	Pondleton & Neff	--	25	30	0
f/492	10½ miles south	Sec. 70, NW¼ SW¼	do.	F. T. Jarvis	--	29	30	2.5
f/493	do.	Sec. 63, NW¼ NW¼	do.	E.F. Branton	--	45	30	3
f/494	10 miles southeast	Sec. 70, cen. NE¼	do.	F. T. Jarvis, Sr.	--	35	30	3
495	do.	Sec. 94, cen. E line S¼	do.	W.E. Walling	--	32	30	4
f/496	do.	Sec. 94, SE cor.	do.	R. C. Partridge	--	27	30	3
f/497	do.	Sec. 70, NE cor.	do.	A.P. Garrett	--	32	30	2.5
f/498	do.	Sec. 69, NW¼ NW¼	do.	R.T. Walling	--	31	30	2.5
f/499	10½ miles southeast	Sec. 70, cen. E line NE¼	do.	F. T. Jarvis	--	40	30	4
f/500	do.	Sec. 70, cen. E line	do.	do.	--	36	30	4
f/501	11 miles southeast	Sec. 69, SE cor. SW¼	do.	J. B. Ammerman	--	51	30	--
f/502	11½ miles southeast	Sec. 64, NW cor. SW¼	do.	M.G. Nerrick	--	47	30	2
f/503	12 miles south	Sec. 42, NE cor.	do.	R.V. Burton	--	47	30	2
f/504	12 miles southeast	Sec. 41, NW cor.	do.	do.	--	47	30	--
f/505	12½ miles south	Sec. 41, NW cor. SW¼	do.	Mrs. -- Burroughs	--	32	36	2
f/506	do.	Sec. 42, SE cor.	do.	L. E. Hudson	--	51	30	--
f/507	do.	Sec. 183, NE cor.	H.&T.C.R.R. blk. 45	N. D. Smith Estate	--	32	30	--
f/508	13½ miles southeast	Sec. 176, SE cor. NE¼	do.	H. H. Nicholson	--	46	30	2
f/509	13 miles southeast	Sec. 41, SE cor.	D. & W. R.R. blk. 2	J. H. Jones	--	35	30	3
f/510	13½ miles southeast	Sec. 166, NE cor.	H.&T.C.R.R. blk. 45	W. K. Moore	--	45	30	--
f/511	12½ miles southeast	Sec. 40, cen. W line NW¼	D. & W. R.R. blk. 2	E. L. Burnison	--	49	30	2
f/512	12 miles southeast	Sec. 65, NW¼ SW¼	do.	Mrs. H. C. Campbell	--	35	30	--

L. P. Huggins, Project Superintendent

No.	Water Level		Pump and power <u>b/</u>	Use of water <u>c/</u>	Topographic situation	Supply <u>d/</u>	Remarks
	Depth below measuring point (feet)	Date of measurement					
485	35	Nov. 28, 1936	C,W	D	Rolling	A	Concrete casing.
486	30	Nov. 26, 1936	C,W	D	do.	A	Do.
487	27	do.	C,W	--	Flat	A	Do.
489	32	do.	C,W	--	do.	A	Concrete casing. Owner reported mineral taste.
490	32	do.	C,W	D	Rolling	A	Concrete casing. Owner reported 3 feet drawdown after pumping 4 gallons a minute
491	18.7	Nov. 14, 1936	C,W	D	Flat	A	Concrete casing. Owner reported mineral taste. for 24 hours.
492	17	Nov. 26, 1936	C,W	D	Rolling	A	Concrete casing. Owner reported slight drawdown after pumping 4 gallons a minute
493	30	do.	C,W	D	do.	A	Do. for 24 hours.
494	28	do.	C,W	D	do.	A	Do.
495	27	Dec. 10, 1936	C,W	D	Flat	A	Do.
496	23	Nov. 26, 1936	C,W	D	Rolling	A	Do.
497	27.5	<u>e/</u>	Cf, & E, $\frac{1}{4}$	D	do.	A	Concrete casing.
498	4	Nov. 26, 1936	C,W	D	Flat	A	Do.
499	36	do.	B,H	D	do.	A	Do.
500	24	do.	B,H	D	Rolling	A	Do.
501	--	--	C,W	D	Flat	A	Concrete casing. Tenant reported slight drawdown after pumping 4 gallons a minute
502	28.5	Nov. 28, 1936	C,W	D	do.	A	Do. for 24 hours.
503	29	do.	C,W	D	do.	A	Do.
504	--	--	C,W	D	do.	A	Do.
505	29	Nov. 27, 1936	B,H	D	do.	A	Rock casing.
506	30.5	<u>e/</u>	C,W	D	do.	A	Concrete casing.
507	--	--	C,W	D	do.	A	Concrete casing. Owner reported 3 feet drawdown after pumping 4 gallons a minute
508	16	Nov. 27, 1936	C,H	D	do.	A	Concrete casing. for 12 hours.
509	26	do.	C,W	D	do.	A	Do.
510	--	--	C,W	D	do.	A	Do.
511	29	Nov. 27, 1936	C,W	D	do.	A	Do.
512	--	--	C,W	D	Rolling	A	Do.

Records of wells and springs in Knox County--Continued

No.	Distance from Benjamin	Section or Labor	Survey and Block or League	Owner	Date completed	Depth of well (ft.)	Diameter of well (in.)	Height of measuring point above ground (ft.) a/
f/513	12 miles southeast	Sec. 64, NE cor. SE $\frac{1}{4}$	D. & W. R.R. blk. 2	Mrs. -- Smith	--	39	30	3
f/514	11 $\frac{1}{2}$ miles southeast	Sec. 68, SW cor. SE $\frac{1}{4}$	do.	-- Johnson	--	40	30	2
f/515	do.	Sec. 68, SW cor.	do.	J. T. Voss	--	42	30	2
f/516	11 miles southeast	Sec. 68, SW $\frac{1}{4}$ NW $\frac{1}{4}$	do.	J. B. Scott	--	45	30	2
f/518	10 $\frac{1}{2}$ miles southeast	Sec. 95, cen. S line	do.	W.W. McCarty	--	36	30	2.5
f/519	do.	Sec. 96, S cor.	do.	R. I. Myers	--	40	30	--
f/520	11 miles southeast	Sec. 71, SE cor. SW $\frac{1}{4}$	do.	do.	--	42	30	2
f/521	11 $\frac{1}{2}$ miles southeast	Sec. 72, S7 cor. SE $\frac{1}{4}$	do.	E. Dickerson	1901	41	30	1.5
i/522	12 miles southeast	Sec. 67, cen. S line NE $\frac{1}{4}$	do.	B. F. Tanksley	1906	47	30	4
523	12 $\frac{1}{2}$ miles southeast	Sec. 37, NW cor.	do.	T. D. L. Johnson	--	39	30	4
f/524	do.	Sec. 66, NW $\frac{1}{4}$ NE $\frac{1}{4}$	do.	do.	--	46	30	3
f/525	do.	Sec. 66, cen. N line SW $\frac{1}{4}$	do.	-- Shoety	--	42	30	5
f/526	13 miles southeast	Sec. 37, NW $\frac{1}{4}$ SW $\frac{1}{4}$	do.	G. W. Holloman	--	43	30	2
f/527	13 $\frac{1}{2}$ miles southeast	Sec. 39, SE cor. NE $\frac{1}{4}$	do.	Mrs. M. C. Hardin	--	48	30	3
f/528	do.	Sec. 40, SE cor.	do.	D. R. Huckleby	--	35	30	3
f/529	do.	Sec. 158, NW $\frac{1}{4}$ NE $\frac{1}{4}$	H.&T.C.R.R. blk. 45	Frank Mears	--	55	30	3
f/530	14 miles southeast	Sec. 39, SW $\frac{1}{4}$ SE $\frac{1}{4}$	D. & W. R.R. blk. 2	T. J. Thompson	--	43	30	3
f/531	do.	Sec. 38, NE cor. SW $\frac{1}{4}$	do.	J. R. Nelson	1895	43	36	2
532	14 $\frac{1}{2}$ miles southeast	Sec. 135, NW $\frac{1}{4}$ NE $\frac{1}{4}$	H.&T.C.R.R. blk. 45	W. E. McNeil	--	43	32	2.5
f/533	15 $\frac{1}{2}$ miles southeast	Sec. 122, cen. W line SW $\frac{1}{4}$	do.	Geo. Pratt	--	23	36	2
f/534	15 miles southeast	Sec. 135, NE cor.	do.	J. B. Renaue	--	29	36	2.5
535	14 $\frac{1}{2}$ miles southeast	Sec. 123, NE cor. SW $\frac{1}{4}$	do.	W. E. McNeil	--	30	--	--
f/536	do.	Sec. 123, SW $\frac{1}{4}$ NW $\frac{1}{4}$	do.	Mrs. -- Martin	--	29	36	5
537	14 miles southeast	Sec. 123, cen. N line NW $\frac{1}{4}$	do.	C. A. Steinnoale	--	32	36	1.5
f/538	13 miles southeast	Sec. 36, SE cor.	D. & W.R.R. blk. 2	G. C. Pruitt	--	38	30	3
539	12 $\frac{1}{2}$ miles southeast	Sec. 73, SE cor.	do.	W.J. Wallace	1906	37	30	3
f/540	13 $\frac{1}{2}$ miles southeast	Sec. 75, NW $\frac{1}{4}$ SE $\frac{1}{4}$	do.	W. F. McNabb	1923	32	36	3

L. P. Huggins, Project Superintendent

No.	Water Level		Pump and power b/	Use of water c/	Topographic situation	Supply d/	Remarks
	Depth below measuring point (feet)	Date of measurement					
513	26	Nov. 27, 1936	C,W	D	Flat	A	Concrete casing.
514	26	Nov. 28, 1936	C,C,2	--	do.	--	Concrete casing. Owner reported 14 feet drawdown after pumping 25 gallons a minute
515	31	do.	C,W	D	do.	A	Concrete casing. for 3 hours.
516	28	do.	C,W	D	do.	A	Do.
518	25.5	Dec. 11, 1936	C,W	D	do.	A	Do.
519	32	e/	C,W	D	do.	A	Do.
520	24	Nov. 28, 1936	C,W	D	Rolling	A	Concrete casing. Owner reported slight drawdown after pumping 4 gallons a minute
521	29	Dec. 11, 1936	C,W	D	Flat	A	Do. for 24 hours.
522	28	do.	C,W	D	do.	A	Concrete casing. Owner reported mineral taste.
523	21	do.	C,H	D	do.	A	Concrete casing.
524	21	Nov. 27, 1936	C,W	D	do.	A	Do.
525	19	do.	C,W	D	do.	A	Do.
526	17	do.	C,W	D	do.	A	Do.
527	28	do.	C,W	D	do.	A	Do.
528	18	do.	C,W	D	do.	A	Do.
529	26	do.	C,W	D	do.	A	Do.
530	22	do.	C,W	D	do.	A	Do.
531	34	Dec. 28, 1936	C,W	D	do.	A	Do.
532	23.6	do.	C,W	--	do.	A	Do.
533	17	do.	C,W	D	do.	A	Reported slight drawdown after pumping 4 gallons a minute for 24 hours.
534	21	do.	B,H	D,S	do.	--	Concrete casing.
535	16	e/	C,W	D	do.	A	Wood curb.
536	26	Dec. 28, 1936	C,W	D	do.	A	Concrete casing.
537	20	do.	C,W	D	do.	A	Do.
538	22.5	Dec. 11, 1936	C,W	D	do.	A	Concrete casing. Owner reported mineral taste.
539	24	do.	C,W	D	do.	A	Concrete casing. Owner reported slight drawdown after pumping 4 gallons a minute
540	16	Dec. 23, 1936	C,W	D	do.	A	Do. for 24 hours.

Records of wells and springs in Knox County--Continued

No.	Distance from Benjamin	Section or	Survey and Block or League	Owner	Date completed	Depth of well (ft.)	Diameter of well (in.)	Height of measuring point above ground (ft.) <u>a/</u>
541	14 miles southeast	Sec. 124, NE cor.	H.&T.C.R.R. blk. 45	E. B. Bowden	1914	42	36	2
f/542	do.	Sec. 115, NW cor.	do.	do.	1921	28	--	2.5
f/543	15 miles southeast	Sec. 114, NW ¹ / ₄ SW ¹ / ₄	do.	E.R. Elliott	--	30	30	2.5
f/544	15 ¹ / ₂ miles southeast	Sec. 114, NW cor. SE ¹ / ₄	do.	Wallace Reed	--	34	30	2.5
f/545	17 ¹ / ₂ miles southeast	Sec. 215, cen. S line SW ¹ / ₄	Samuel Washburn	--	1923	40	30	2.5
f/546	15 ¹ / ₂ miles southeast	Sec. 215, NW cor.	do.	J.M. Simpson	--	39	30	--
547	15 miles southeast	Sec. 103, cen. N line W ¹ / ₂	H.&T.C.R.R. blk. 45	Charlie Yates	1906	31	30	2.5
f/548	do.	Sec. 104, NW cor. S ¹ / ₂	do.	E. C. Pryor	--	27	30	2.5
f/549	15 ¹ / ₂ miles southeast	Sec. 102, cen. W line NW ¹ / ₄	do.	G. H. West	--	21	36	1.5
550	16 miles southeast	Sec. 101, SE cor. SW ¹ / ₄	do.	Ezra Harlan	--	30	--	--
f/551	16 ¹ / ₂ miles southeast	Sec. 86, SW cor.	do.	E.W. Coffman	--	40	30	2
f/552	17 miles southeast	Sec. 83, SE cor. NW ¹ / ₄	do.	F. F. Goode	--	40	5 ¹ / ₂	0.5
f/553	19 ¹ / ₂ miles southeast	Sec. 7, NE ¹ / ₄ SE ¹ / ₄	H.&T.C.R.R.	do.	1927	4,543	6-5/8	--

a/ Measuring point was usually top of casing, top of well curb, or top of pump base.

b/ B, bucket; C, cylinder; Cf, centrifugal; E, electric; G, gasoline; H, hand; S, steam; W, windmill; number indicates horsepower.

c/ D, domestic; I, irrigation; Ind, industrial; N, not used; P, public; S, stock.

L. P. Huggins, Project Superintendent

No.	Water Level		Pump and power b/	Use of water c/	Topographic situation	Supply d/	Remarks
	Depth below measuring point (feet)	Date of measurement					
541	21	Dec. 29, 1936	C,W	D	Rolling	A	Brick casing.
542	17.5	do.	C,W	D	Regulating	A	Tenant reported water in chalky clay.
543	18	e/	C,W	D	Flat	A	Concrete casing.
544	19	e/	B,H	D	--	A	Concrete casing. Reported mineral taste.
545	6	e/	B,H	N	Draw	W	Do.
546	14	Dec. 29, 1936	C,W	D	Flat	A	Do.
547	23	do.	C,W	D	do.	A	Concrete casing. Estimated yield 3 gallons a minute.
548	19	e/	C,W	D	do.	A	Concrete casing. Reported slight drawdown after pumping 3 gallons a minute for 6
549	18	e/	C,W	D	do.	W	Brick casing. Owner reported 2 hours. feet drawdown after pumping 3 gallons a
550	22	Dec. 29, 1936	C,W	D	do.	A	Brick curb. minute for 4 hours.
551	53	do.	C,W	D	Hilltop	W	Concrete casing.
552	30	e/	C,W	D	Rolling	A	Drilled well. Galvanized iron casing.
553	--	--	--	--	--	--	Oil test. Located 200 feet from extreme E line and 200 feet from S line. See log.

d/ A, supply reported permanent or adequate for designated use; W, supply reported weak.

e/ Water level reported.

f/ No water sample collected for analysis.

Table of Drillers' Logs, Knox County, Texas

Thickness Depth	
(feet)	(feet)
Driller's log of well 2	
Deep Rock Oil Co., Big 4 Ranch No. 1, 1 1/2 miles northwest of Benjamin.	
Red rock - - - - -	100
Red shale and gypsum shells - - - - -	140
Red rock and gypsum shells - - - - -	190
Red rock - - - - -	475
Red rock and gypsum - - - - -	635
Pink shale - - - - -	735
Brown lime - - - - -	750
Gray shale - - - - -	765
Red shale and lime shell - - - - -	730
Pink shale - - - - -	845
Red shale - - - - -	890
Red rock - - - - -	905
Red shale and lime shells - - - - -	935
Red rock and gypsum - - - - -	955
Red rock - - - - -	1025
Gypsum - - - - -	1045
Red rock - - - - -	1070
Gypsum - - - - -	1080
Red rock - - - - -	1095
Lime - - - - -	1105
Red rock - - - - -	1110
Brown shale - - - - -	1235
Red rock - - - - -	1300
Light colored shale - - - - -	1330
Blue shale - - - - -	1558
Hard, gray lime - - - - -	2030
Blue shale - - - - -	2035
Lime - - - - -	2110
Water sand - - - - -	2140
Gray lime - - - - -	2190
Red rock - - - - -	2220
Gray lime - - - - -	2295
Gray, sandy lime - - - - -	2365
Hard, gray lime - - - - -	2435
Blue shale - - - - -	2465
Light colored lime - - - - -	2470
Blue shale - - - - -	2530
Red shale - - - - -	2550
Blue shale - - - - -	2595
Red shale - - - - -	2645
Water sand - - - - -	2665
Red shale - - - - -	2685
Hard, gray lime - - - - -	2695
Blue shale - - - - -	2740
Red shale - - - - -	2755
Blue shale - - - - -	2800
Red shale - - - - -	2820
Blue shale - - - - -	2825
Gray lime - - - - -	2940
Blue shale - - - - -	2875
Gray lime - - - - -	2900
Blue shale - - - - -	2950
Gray lime - - - - -	2960

Thickness Depth	
(feet)	(feet)
Driller's log of well 2--Continued	
Blue shale - - - - -	3010
White lime - - - - -	3020
Blue shale - - - - -	3042
Gray lime - - - - -	3055
Blue shale - - - - -	3090
Gray lime - - - - -	3115
Broken, gray lime - - - - -	3125
Blue shale and shells - - - - -	3200
Gray lime - - - - -	3220
Blue shale and shells - - - - -	3235
Gray, sandy shale - - - - -	3250
Water sand - - - - -	3270
Blue shale - - - - -	3310
White lime - - - - -	3325
Blue shale - - - - -	3375
Gray water sand - - - - -	3415
Blue shale - - - - -	3512
Shale - - - - -	3535
Water sand - - - - -	3555
Blue shale - - - - -	3575
Sandy lime - - - - -	3580
Water sand - - - - -	3585
Sand - - - - -	3590
Blue shale - - - - -	3655
Sandy lime - - - - -	3685
Shale - - - - -	3860
Lime - - - - -	3870
Blue shale - - - - -	3960
Shale and sandy, lime shells - - - - -	4060
Sandy shale - - - - -	4105
Shale and shells - - - - -	4115
Hard, sandy lime - - - - -	4120
Shale and shells - - - - -	4150
Shale - - - - -	4225
Lime - - - - -	4232
Blue shale - - - - -	4240
Water sand - - - - -	4250
Hard, sandy lime - - - - -	4255
Blue shale - - - - -	4270
Brown shale - - - - -	4345
Gray, sandy lime - - - - -	4370
Blue shale - - - - -	4435
Gray lime - - - - -	4510
Sandy lime, hole full of water - - - - -	4516
CASING RECORD: 750 feet of 15 1/2-inch casing, 1318 feet of 10-inch casing, 2686 feet of 8 1/2-inch casing, and 5275 feet of 6-5/8-inch casing.	
Driller's log of well 126	
Deep Rock Oil Co., W. R. Moore No. 1, 9 miles northwest of Benjamin.	
Soil - - - - -	5

(Continued on next page)

Table of Drillers' Logs, Knox County--Continued

	Thickness	Depth
	(feet)	(feet)
<u>Driller's log of well 120--Continued</u>		
Red clay - - - -	55	90
Red rock - - - -	355	445
Black shale - - - -	55	500
Red rock - - - -	135	635
Gray shale - - - -	5	640
Red rock - - - -	260	900
Lime shell and shale - - - -	10	910
Red rock - - - -	185	1095
Gray shale - - - -	15	1110
Lime shell and shale - - - -	10	1120
Red shale - - - -	10	1150
Lime shell and shale - - - -	80	1210
Shale - - - -	10	1220
Gray shale - - - -	10	1230
Lime shell and shale - - - -	5	1235
Gray shale - - - -	15	1250
Lime shell and shale - - - -	5	1255
Gray shale - - - -	10	1265
Lime shell and shale - - - -	25	1290
Red rock - - - -	5	1295
Lime shell and shale - - - -	205	1500
Gray shale - - - -	5	1505
Lime shell and shale - - - -	40	1545
Gray shale - - - -	5	1550
Lime shell - - - -	285	1815
$\frac{1}{2}$ bailer water, 1740 feet.		
Gray shale - - - -	10	1825
Lime shell and shale - - - -	50	1875
Gray shale - - - -	15	1890
Lime shell and shale - - - -	55	1945
Sandy lime, 1 bailer water-	5	1950
Broken lime - - - -	10	1960
Gray lime - - - -	60	2020
Pink shale - - - -	15	2035
Lime shell and shale - - - -	55	2090
Black shale - - - -	35	2125
Sand - - - -	70	2195
Gray lime - - - -	20	2215
Lime shell and shale - - - -	45	2260
Gray lime - - - -	30	2290
Gray shale - - - -	25	2315
Red rock - - - -	10	2325
Lime - - - -	5	2330
Sandy shale - - - -	10	2340
Gray shale - - - -	10	2350
White shale - - - -	65	2415
Red rock - - - -	10	2425
Lime - - - -	2	2427
Gray shale - - - -	8	2435
Black shale - - - -	15	2450
Red rock - - - -	25	2475
Black shale - - - -	5	2480
Red rock - - - -	15	2495
Black shale - - - -	28	2523
Lime - - - -	10	2533

	Thickness	Depth
	(feet)	(feet)
<u>Driller's log of well 126--Continued</u>		
Black shale - - - -	72	2605
Lime shell and shale - - - -	355	2960
Brown shale - - - -	10	2970
Gray lime - - - -	15	2985
White shale - - - -	25	3010
Brown shale - - - -	15	3025
Gray lime - - - -	50	3075
Black shale - - - -	15	3090
Brown shale - - - -	10	3100
Brown lime - - - -	10	3110
Black shale - - - -	8	3118
Brown lime - - - -	12	3130
Lime shell and shale - - - -	25	3155
Lime - - - -	25	3180
White shale - - - -	40	3220
Water sand, hole full of		
water - - - -	5	3225
Sandy shale - - - -	5	3230
Lime - - - -	18	3248
White shale - - - -	17	3265
White, sandy lime - - - -	25	3290
Hole full of water at 3270 feet.		
Black shale - - - -	55	3345
White lime - - - -	5	3350
Black shale - - - -	18	3368
Gray lime - - - -	72	3440
Black shale - - - -	8	3448
White lime - - - -	12	3460
Water sand, hole full of		
water - - - -	51	3511

<u>Driller's log of well 133</u>		
Deep Rock Oil Co., Dr. C. H. Leavers No. 1, 3 miles north of Benjamin.		
Red rock - - - -	410	410
Lime - - - -	5	415
Red rock - - - -	155	570
Gypsum - - - -	15	585
Red rock - - - -	335	920
Brown shale - - - -	35	955
Blue shale - - - -	25	980
White lime - - - -	20	1000
Blue shale - - - -	5	1005
White lime - - - -	15	1020
Blue shale - - - -	10	1030
Hard lime - - - -	35	1065
Broken lime - - - -	40	1105
Blue shale and shells - - - -	45	1150
Hard lime - - - -	55	1205
Blue shale - - - -	20	1225
White lime - - - -	20	1245
Blue shale - - - -	5	1250
White lime - - - -	40	1290
Hard lime - - - -	40	1330

(Continued on next page)

Table of Drillers' Logs, Knox County--Continued

	Thickness (feet)	Depth (feet)
Driller's log of well 133--Continued		
Shale and shells	80	1410
White lime	10	1420
Gypsum, lime, and shale	110	1530
Gypsum and sandy shale	5	1535
Black, sandy lime	20	1555
Blue shale	20	1575
Black, sandy lime	30	1605
Blue, sandy shale	15	1620
Water sand	15	1635
Blue shale	10	1645
Lime	5	1650
Blue shale	30	1680
Sandy shale	10	1690
Lime	2	1692
Shale	3	1695
Gray lime	10	1705
Light shale	30	1735
Blue shale	15	1750
White lime	10	1760
Sandy shale	40	1800
Gray sand	70	1870
Sandy shale	15	1885
Brown shale	15	1900
Blue shale	70	1970
Lime	10	1980
Light shale	35	2015
Sandy lime shale	20	2035
Hard, white lime	40	2075
Blue shale and lime shells	40	2115
Gray lime	45	2160
Pink shale	5	2165
Red shale	10	2175
Blue shale	50	2225
Black shale	20	2245
Sandy shale, water	15	2260
Dark blue shale	40	2300
Red shale	40	2340
Brown shale	10	2350
Red rock	45	2395
Dark, sandy shale	30	2475
Red rock	3	2483
Dry, brown sand	10	2493
Blue shale	52	2545
Shale and lime shells	55	2600
Shale and water sand	34	2634
Blue shale	6	2640
Sand	10	2650
Light colored lime	10	2660
Light colored shale	45	2705
Blue shale	20	2725
Shale and lime shells	30	2805
Blue shale	65	2870
Lime shells	45	2915
Blue shale	35	2950
Gray lime	10	2960

	Thickness (feet)	Depth (feet)
Driller's log of well 133--Continued		
Blue shale	35	2995
Gray lime	25	3020
Blue shale	5	3025
Gray lime	5	3030
Gray water sand	30	3060
Blue shale	5	3065
Gray water sand	55	3120
Gray shale	12	3132
Gray sand	68	3200
Gray shale	15	3215
Gray lime, hole full of water	110	3325
Blue shale	15	3340
Gray sand	10	3350
Blue shale	25	3375
Sandy lime, water	5	3380
Blue shale	50	3430
Hole full of water at 3450 feet.		
White water sand	45	3475
Gray sand	10	3485
Blue shale	5	3490
Water sand	1014	4504

Driller's log of well 138		
Deep Rock Oil Co., L. P. Jones, et al. et. 1, 3 miles northeast of Benjamin.		
Red bed	699	699
Lime shell	1	700
Dark shale	8	708
Hard, gray lime	7	715
Gray shale	13	730
Brown shale	5	735
Gray shale	35	770
Gypsum shell	5	775
Gray shale	10	785
Gray shell	55	840
Gypsum shell	10	850
Hard lime	2	852
Gypsum shell	8	860
Hard lime	5	865
Medium lime	5	870
Hard lime	10	880
Blue shale	5	885
Gray shell	5	890
Hard shell	5	895
Blue shale	5	900
Gray shale	40	940
Hard lime	5	945
Medium lime	15	960
Gray shale	15	975
Hard lime	7	982
Gray shale	5	987
Gray shale and gypsum	13	1000
Lime	10	1010

(Continued on next page)

Table of Drillers' Logs, Knox County--Continued

	Thickness (feet)	Depth (feet)
Driller's log of well 130--Continued		
Gypsum shell	4	1014
Lime	6	1020
Gypsum	15	1035
Blue shale	13	1048
Gypsum shells and grey shale	52	1100
Blue shale	50	1150
Gypsum	5	1155
Gray shale	15	1150
Gray lime	8	1158
Gray shale	17	1175
Gypsum	5	1180
Shale	4	1184
Hard lime	3	1192
Gray shale	4	1196
Gypsum	9	1205
Lime	17	1222
Blue shale	5	1227
Gypsum	10	1237
Hard lime	8	1245
Gypsum shells and shale	30	1275
Gray shale	3	1278
Gypsum	8	1286
Hard lime	7	1293
Blue shale	3	1296
Hard shell	4	1300
Gypsum	6	1306
Hard, gray lime	4	1310
Gypsum shells and shale	25	1335
Gray shale	15	1350
Lime shell	3	1353
Sandy lime	4	1357
Gray lime	3	1360
Sandy lime	4	1364
Gray lime	3	1370
Shells and shale	70	1440
Gray shale	3	1448
Soft lime	27	1475
Blue shale	4	1479
Gypsum	3	1485
Gray shale	10	1495
Shale and gypsum shells	25	1520
Shale	22	1542
Sandy lime	3	1548
Gypsum and shale	12	1560
Sandy lime	3	1563
Lime shells and shale	22	1585
Gray shale	10	1595
Gray lime	30	1625
Sandy shale	5	1630
Dry sand	10	1640
Water sand, 4 barrels of water	15	1655
Hard lime	3	1660
Soft lime	10	1670
Brown shale	5	1675

	Thickness (feet)	Depth (feet)
Driller's log of well 150--Continued		
Hard lime	7	1382
Shale	8	1600
Lime	3	1695
Blue shale	32	1725
Sandy lime	20	1745
Soft lime	20	1765
Gray shale	15	1780
Soft lime and gypsum	15	1795
Sandy lime	10	1805
Soft lime	7	1812
Gray lime	81	1893
Blue shale	3	1896
Hard, gray lime	12	1908
Brown shale	6	1914
Gray lime	29	1943
Blue shale	4	1947
Dry sand	4	1951
Sandy shale	3	1954
Gray shale	9	1963
Brown shale	7	1970
Hard, gray lime	15	1985
Sandy lime	5	1990
Gray shale and shells	35	2025
Pink shale	10	2035
Brown shale	25	2060
Gray lime	5	2065
Gray shale	5	2070
Brown shale	45	2115
Gray lime	7	2122
Brown shale	35	2155
Gray lime	2	2157
Gray shale and lime shells	155	2512
Gray lime	10	2522
Water sand	8	2530
Sand	13	2543
Gray shale	3	2546
Hard lime	4	2550
Gray shale	15	2565
Lime	7	2572
Gray shale	13	2585
Hard lime	5	2590
Gray shale	45	2635
Gray shale	39	2674
Caving, gray shale	20	2500
Black shale	2	2502
Gray, sandy lime	2	2504
Gray shale	2	2506
Hard, gray lime	4	2510
Gray, sandy shale	14	2524
Coal	3	2527
Soft, gray shale	10	2537
Hard, gray lime	10	2547
Soft, gray shale	5	2552
Hard, gray lime	11	2563

(Continued on next page)

-48-
Table of Drillers' Logs, Knox County--Continued

	Thickness (feet)	Depth (feet)
Driller's log of well 138--Continued		
Soft, gray shale	3	2566
Gray lime	5	2571
Gray shale	5	2576
Lime shell	2	2578
Sandy shale	19	2597
Hard lime	6	2603
Blue shale	3	2606

Driller's log of well 467
The Texas Company, C. B. Teague No. 1, 12
miles south of Benjamin.

Soft, red mud	30	30
Soft, red sand	35	65
Red clay	30	95
Soft, red shale	735	830
Brown shale	10	840
Gray shale and salt	50	870
Broken, soft brown lime	60	930
Hard, gray lime	30	930
Brown shale	10	970
Hard, gray lime	10	900
Hard, brown lime	80	1060
Shale and lime shells	50	1090
Hard, gray shale	10	1100
Soft, blue shale	40	1140
Water sand	15	1155
Soft, blue shale	10	1165
Shale and lime shells	85	1250
Hard, white lime	5	1255
Shale and lime shells	60	1315
Hard, gray lime	15	1330
Soft, blue shale	10	1340
Hard, gray lime	10	1350
Hard, white lime	15	1365
Blue mud	20	1385
Hard, white lime	15	1400
Blue mud	15	1415
Blue shale and lime shells	70	1435
Blue mud	40	1525
Gray lime	45	1570
Blue mud	20	1590
Hard, white lime	10	1600
White shale	25	1625
White lime	5	1630
White mud	25	1655
Soft, black shale	35	1690
Black mud	5	1695
Hard, white lime	30	1725
White mud	5	1730
Hard, gray lime	15	1745
Soft, blue shale	40	1785
Hard, white lime	35	1820
Soft, blue shale	10	1830
Hard, gray lime	20	1850
Hard, white lime	25	1875

	Thickness (feet)	Depth (feet)
Driller's log of well 467--Continued		
Soft, red mud	5	1380
Soft, gray shale	5	1385
Lime	5	1390
Soft, blue shale	10	1300
Gray lime	60	1960
Hard, white lime	60	2020
Hard, gray lime	30	2050
Soft, gray shale	70	2120
Soft, blue shale	10	2130
Soft, gray shale	15	2145
Red rock	45	2190
Soft, white sand	10	2200
Blue mud	20	2220
Black shale	35	2255
White lime	1	2256
Water sand	7	2263
Hard, white lime	12	2275
Red rock	5	2280
Hard, white lime	13	2293
Soft, blue shale	5	2307
Blue mud	33	2325
Red mud	20	2345
Soft, blue slate	40	2385
Blue mud	15	2400
Hard, white lime	10	2410
Blue mud	20	2450
Soft, blue shale	32	2462
Soft, white shale	10	2472
Hard, white sand	1	2473
White lime	7	2480
Light colored, medium sand	55	2515
Hard, white sand	15	2528
Soft, light shale	5	2534
Soft, white slate	33	2567
Hard, white lime	8	2575
Soft, white shale	10	2585
Hard, white lime	35	2620
White mud	5	2625
Hard, white lime	5	2650
Soft, black slate	5	2655
Hard, white lime	79	2714
Soft, black slate	10	2724
Hard, white lime	6	2730
Soft, dark slate	10	2740
Hard, white lime	60	2800
Soft, white shale	52	2852
Hard, brown lime	13	2865
Hard, white lime	15	2880
Blue mud	15	2895
Soft, white slate	20	2915
Soft, white sand	20	2935
Soft, white slate	5	2940
Soft, white shale	5	2945
Hard, white sand	2	2947

(Continued on next page)

Table of Drillers' Logs, Knox County--Continued

	Thickness (feet)	Depth (feet)
Driller's log of well 467--Continued		
Soft, white slate - - -	6	2953
Soft, black slate - - -	32	2985
Water sand, hole full of water - - - - -	3	2988
Hard, black lime - - -	12	3000
Soft, black slate - - -	32	3032
Hard, white lime - - -	8	3040
Soft, white sand - - -	14	3054
Soft, black slate - - -	7	3061
Hard, white lime - - -	9	3070
Black mud - - - - -	10	3080
Soft, black shale - - -	51	3131
Hard, gray lime - - -	21	3152
Soft, white, water sand - -	46	3193
Hard, white sand - - -	4	3202
Soft, black shale - - -	18	3220
Gray shale - - - - -	35	3255
Soft, blue shale - - -	40	3295
Hard, white lime - - -	7	3302
Soft, blue shale - - -	18	3320
Soft, gray shale - - -	45	3365
Soft, blue shale - - -	75	3440
Light, sandy shale - - -	60	3500
Soft, light colored shale - -	25	3525
Soft, white sand - - -	35	3560

	Thickness (feet)	Depth (feet)
Driller's log of well 553		
Tumble Oil and Refining Co., F. F. Goode		
No. 1, 19 $\frac{1}{2}$ miles southeast of Benjamin.		
Red bed - - - - -	40	40
Red mud - - - - -	20	60
Muddy, red rock - - - - -	20	80
Red bed - - - - -	25	105
Red rock - - - - -	25	130
Red bed - - - - -	15	145
Muddy, red bed - - - - -	30	175
Red rock - - - - -	35	210
Red bed - - - - -	80	290
Red bed and gray shale - -	10	300
Red bed and brown shale - -	20	320
Gray lime - - - - -	25	345
Brown shale - - - - -	15	360
Blue shale - - - - -	10	370
Gray shale and lime - - -	35	405
Gray shale and lime breaks- -	20	425
Hard, gray lime - - - - -	10	435
Gray lime and lime shells - -	20	455
Gray shale and lime breaks- -	45	500
Gray lime - - - - -	30	530
Blue shale - - - - -	15	545
Blue shale and gray lime breaks - - - - -	45	590
Blue shale - - - - -	25	615
Hard lime - - - - -	10	625
Gray shale - - - - -	10	635

	Thickness (feet)	Depth (feet)
Driller's log of well 553--Continued		
Blue shale and hard gray lime breaks - - - - -	45	680
Blue shale and lime breaks- -	10	690
Hard lime - - - - -	10	700
Broken, gray lime - - - - -	30	730
Blue shale and lime breaks- -	40	770
Broken, gray lime - - - - -	40	810
Blue shale and lime breaks- -	25	835
Gray lime - - - - -	45	880
Blue shale and lime breaks- -	35	915
Blue shale - - - - -	55	970
Gray lime and shale breaks- -	15	985
Broken, gray lime - - - - -	45	1030
Gray lime - - - - -	15	1045
Muddy, gray lime - - - - -	25	1070
Gray shale - - - - -	50	1120
Broken, gray lime - - - - -	10	1130
Gray shale - - - - -	65	1195
Blue shale and lime shells- -	40	1235
Gray lime and shale breaks- -	65	1300
Broken, gray lime - - - - -	7	1307
Hard, gray, sandy lime- - -	18	1325
Blue shale - - - - -	30	1355
Brown shale - - - - -	18	1573
Hard, gray lime - - - - -	7	1380
Gray lime - - - - -	20	1400
Hard, gray lime - - - - -	15	1415
Blue shale - - - - -	5	1420
Gray lime - - - - -	35	1455
Gray lime shells - - - - -	50	1505
Blue shale - - - - -	10	1515
Brown shale - - - - -	7	1522
Hard, gray lime - - - - -	8	1530
Hard lime shells - - - - -	60	1590
Gray shale - - - - -	20	1610
Brown shale - - - - -	30	1640
Black water sand - - - - -	10	1650
Blue shale - - - - -	10	1660
Gray shale - - - - -	10	1670
Red bed - - - - -	10	1680
Brown shale - - - - -	5	1685
Red bed - - - - -	15	1700
Gray lime - - - - -	3	1703
White water sand - - - - -	7	1710
Red bed - - - - -	25	1735
Red rock and blue shale breaks - - - - -	10	1745
Gray shale - - - - -	20	1765
Brown shale - - - - -	30	1795
Red bed and rotten lime - -	20	1815
Gray lime - - - - -	20	1835
Gray shale - - - - -	10	1845
Red bed - - - - -	10	1855
Gray lime - - - - -	9	1864

(Continued on next page)

Table of Drillers' Logs, Knox County--Continued

Driller's log of well 553--Continued	
Thickness (feet)	Depth (feet)
Blue shale - - - -	11 1875
Hard, gray lime - - -	5 1880
Gray shale - - - -	20 1900
White water sand - - -	10 1910
Water sand - - - -	5 1915
Blue shale - - - -	17 1932
Hard, black lime - - -	3 1935
Soft and broken, gray lime-	5 1940
Blue shale - - - -	5 1945
Broken, gray shale and shells - - - -	25 1970
Rotten, gray shale - - -	20 1990
Gray lime and shale breaks-	40 2030
Rotten, gray shale - - -	20 2050
Gray shale shells - - -	25 2075
Blue shale - - - -	5 2080
Gray lime - - - -	15 2095
Gray shale and lime shells-	55 2150
Hard, gray lime - - -	5 2155
Soft, gray shale - - -	25 2180
Hard, gray lime - - -	15 2195
Blue shale - - - -	20 2215
Shelly, gray lime - - -	35 2250
Gray lime - - - -	10 2260
Blue shale - - - -	15 2275
Gray lime - - - -	10 2285
Blue shale - - - -	25 2310
Gray lime - - - -	5 2315
White water sand - - -	15 2330
Gray, sandy lime - - -	20 2350
Gray shale - - - -	10 2360
Blue shale - - - -	85 2445
Gray shale and lime shells-	50 2475
Hard, gray lime - - -	5 2480
Hard lime - - - -	15 2495
Gray shale - - - -	40 2535
Gray lime - - - -	8 2543
Soft, gray, sandy shale-	7 2550
White water sand - - -	10 2560
Blue shale - - - -	5 2565
White water sand - - -	15 2580
Blue shale and black lime -	20 2600
White water sand - - -	20 2620
Hard, white water sand -	20 2640
Blue, sandy shale - - -	35 2675
Hard, gray lime - - -	5 2680
Blue shale - - - -	10 2690
Dark, sandy shell - - -	5 2695
Hard lime - - - -	5 2700
Blue shale - - - -	15 2715
Hard, gray lime - - -	20 2735
Gray, sandy lime shells -	15 2750
White, water sand - - -	30 2780
Hard, gray shale - - -	15 2795
Sandy, gray shale - - -	5 2800

Driller's log of well 553--Continued	
Thickness (feet)	Depth (feet)
Blue, sandy shale - - -	20 2820
Gray shale - - - -	40 2860
Caving, blue, sandy shale -	5 2865
Rotten, gray shale - - -	35 2900
Caving, gray shale - - -	35 2935
Rotten, gray shale - - -	15 2950
Blue shale - - - -	40 2990
Loose, gray shale - - -	45 3035
Blue shale - - - -	50 3085
Gray shale - - - -	15 3100
Hard, gray lime - - -	15 3115
Brown, sandy shale - - -	10 3125
Brown shale and lime shells	5 3130
Gray lime - - - -	2 3132
Hard, white water sand -	27 3159
Hard, white sand - - -	5 3164
Blue shale - - - -	6 3170
Hard water sand - - -	3 3173
Blue shale - - - -	2 3175
Blue, sandy shale - - -	4 3179
Blue shale - - - -	4 3183
Hole full of mud.	
Gray shale - - - -	20 3203
Hard, gray lime - - -	3 3206
Gray shale - - - -	25 3229
Gray lime - - - -	1 3250
Hard, gray lime - - -	16 3248
Blue shale - - - -	20 3260
Lime - - - -	1 3269
Blue shale - - - -	56 3325
Gray sand shells - - -	35 3360
Blue, sandy shale - - -	35 3395
Gray, sandy shale - - -	35 3430
Blue, sandy shale - - -	35 3465
Gray, sandy shale - - -	40 3505
Dry, gray sand - - - -	10 3515
Blue, sandy shale - - -	45 3560
Blue shale - - - -	115 3675
Gray shale - - - -	25 3700
Gray shale and sand - - -	10 3710
Blue shale - - - -	245 3955
Soft, gray shale - - -	5 3960
Gray shale - - - -	115 4075
Blue shale - - - -	205 4280
Hard, gray shale - - -	55 4335
Blue shale - - - -	60 4395
Blue shale and sand - - -	10 4405
Hard, gray lime - - -	20 4425
Gray lime - - - -	83 4508
Gray shale - - - -	4 4512
Lime shell - - - -	5 4517
Gray, sandy shale - - -	13 4530
Hard, gray sand - - -	5 4535
Hard, gray water sand -	8 4543

Logs of test wells drilled by W. P. A. labor in Knox County, Texas
(Samples examined and classified by L. P. Figgins, Project Superintendent.)

	Thickness (feet)	Depth (feet)
<u>Well 87</u>		
Flat, northwest corner sec. 2, D. & W.R.R. Co. sur., blk. 3, 10 $\frac{1}{2}$ miles north of Benjamin.		
Surface soil - - - -	3	3
Surface soil and chalk - -	1	4
Chalky clay - - - -	3	7
Red, chalky clay - - - -	1	8
Soft, brown clay - - - -	1	9
Red clay - - - -	10	19
Red, sandy clay - - - -	3	22
Red clay - - - -	1	23
Chalky clay - - - -	3	26
Sandy clay - - - -	2	28
Blue clay - - - -	1	29
Red clay - - - -	5	34
No water sample collected.		

	Thickness (feet)	Depth (feet)
<u>Well 90</u>		
Rolling, C. C. Browning tract, southwest corner sec. 148, H. & T.C.R.R.Co. sur., blk. 44, 10 $\frac{1}{2}$ miles north of Benjamin.		
Surface soil - - - -	3	3
Dark, chalky clay - - - -	4	7
Yellow clay - - - -	5	12
Red clay - - - -	3	15
Yellow clay - - - -	1	16
Blue clay - - - -	1	17
Red clay - - - -	14	31
"Birds-eye" clay - - - -	1	32
Blue clay and white gypsum -	2	34
Blue clay - - - -	1	35
"Birds-eye" clay - - - -	1	36
Red clay and gypsum - - - -	1	37
Red clay - - - -	2	39
Struck water at 28 feet. No water sample collected.		

	Thickness (feet)	Depth (feet)
<u>Well 132</u>		
Sand dunes, Roy Smith tract, northeast corner sec. 223, H. & T.C.R.R.Co. sur., blk. 44, 3 $\frac{1}{2}$ miles north of Benjamin.		
Surface sand - - - -	3	3
Light brown sand - - - -	3	6
Coarse, gray sand - - - -	1	7
Coarse sand and clay - - - -	4	11
Red, silty sand - - - -	4	15
Struck water at 15 feet. Struck quicksand at 15 feet. No water sample collected. Dec. 31, 1936.		

	Thickness (feet)	Depth (feet)
<u>Well 134</u>		
G. F. Stubbs tract, southwest corner NE $\frac{1}{4}$ sec. 229, H. & T.C.R.R.Co. sur., blk. 44, 2 $\frac{1}{2}$ miles northeast of Benjamin.		

	Thickness (feet)	Depth (feet)
<u>Well 134--Continued</u>		
Surface sand - - - -	5	5
Dark gray sand - - - -	4	9
Light gray sand - - - -	4	13
Coarse, red sand and chalk -	4	17
Red, silty sand - - - -	4	21
Struck water at 21 feet. Struck quicksand at 21 feet. No water sample collected. Dec. 30, 1936.		

	Thickness (feet)	Depth (feet)
<u>Well 135</u>		
Sand dunes, G. F. Stubbs tract, southeast corner sec. 229, H. & T.C.R.R.Co. sur., blk. 44, 2 miles northeast of Benjamin.		
Surface sand - - - -	5	5
Brown sand - - - -	1	6
Dark gray sand - - - -	1	7
Light gray sand - - - -	1	8
Struck water at 8 feet. Struck quicksand at 8 feet. No water sample collected. Dec. 30, 1936.		

	Thickness (feet)	Depth (feet)
<u>Well 156</u>		
Hillside, J. D. Jefcoat tract, southeast corner NE $\frac{1}{4}$ sec. 13, C.T.R.R.Co. sur., blk. C, 13 miles east of Benjamin.		
Brown surface soil - - - -	2	2
Red clay - - - -	4	6
Red clay and chalk - - - -	1	7
Pink chalk - - - -	2	9
No water sample collected. Oct. 19, 1936.		

	Thickness (feet)	Depth (feet)
<u>Well 188</u>		
Flat, center north line NW $\frac{1}{4}$ sec. 2, C.T. R.R.Co. sur., blk. C, 14 miles east of Benjamin.		
Surface soil - - - -	4	4
Coarse, red sand - - - -	2	6
Brown sand - - - -	2	8
Red sand and chalk - - - -	2	10
White chalk - - - -	1	11
Light red sand and chalk - -	1	12
Coarse, light red sand - - -	4	16
Red, sandy clay - - - -	5	21
Chalky clay and sand - - - -	2	23
No water sample collected. Oct. 9, 1936.		

	Thickness (feet)	Depth (feet)
<u>Well 318</u>		
Knox County right of way, northwest corner sec. 29, D. & W.R.R.Co. sur., blk. 2, 13 miles southeast of Benjamin.		
Dark brown soil - - - -	2	2
Red clay - - - -	3	5
Brown clay - - - -	3	8

(Continued on next page)

Logs of test wells in Knox County--Continued

		Thickness (feet)	Depth (feet)
Well 318--Continued			
Chalk and red clay	- -	7	15
Chalk and yellow sand	- -	3	18
No water sample collected. Dec. 29, 1936.			

		Thickness (feet)	Depth (feet)
Well 352			
Rolling, W. H. McBride tract, center south line SW $\frac{1}{4}$ sec. 82, D.& W.R.R.Co. sur., blk. 2, 11 miles southeast of Benjamin.			
Surface sand	- - - -	4	4
Brown sand	- - - -	1	5
Red sand	- - - -	1	3
Light red sand	- - - -	2	8
Red sand	- - - -	6	14
Red clay and sand	- - - -	4	18
Red sand	- - - -	1	19
Red sand and white clay	- - - -	2	21
Red, sandy clay	- - - -	2	23
Light red sand	- - - -	1	24
Red sand and chalk	- - - -	1	25
Fine, red sand	- - - -	3	28
Red sand and chalk	- - - -	2	30
No water sample collected.			

		Thickness (feet)	Depth (feet)
Well 415			
Flat, Knox County right of way, southwest corner sec. 55, G. T. Slaughter sur., 12 $\frac{1}{2}$ miles southwest of Benjamin.			
Brown soil	- - - -	2	2
Brown soil and blue clay	- - - -	1	3
Blue and red clay	- - - -	1	4
"Birds-eye" clay	- - - -	2	6
Fine, brown sand and blue clay	- - - -	1	7
"Birds-eye" clay	- - - -	1	8
Red clay	- - - -	2	10
Chalky sand	- - - -	1	11
Fine, brown sand	- - - -	1	12
Fine, grayish-brown sand	- - - -	1	13
Fine, light gray sand	- - - -	2	15
Fine, yellowish-gray sand	- - - -	1	16
Red sand and gravel	- - - -	2	18
Struck water at 17 feet. Water level, 17 feet below top of ground 1 hour after hole completed. No water sample collected. Dec. 14, 1936.			

		Thickness (feet)	Depth (feet)
Well 441			
Draw, Knox County right of way, southwest corner sec. 55, D.& W.R.R.Co. sur., blk. 2, 11 $\frac{1}{2}$ miles south of Benjamin.			
Surface sand	- - - -	1	1
Sandy clay	- - - -	11	12
Fine sand	- - - -	6	18
Struck water at 12 feet. No water sample collected. Nov. 13, 1936.			

		Thickness (feet)	Depth (feet)
Well 454			
S. W. Graham tract, southeast corner SW $\frac{1}{4}$ sec. 90, D.& W.R.R.Co. sur., blk. 2, 10 miles south of Benjamin.			
Brown, surface sand	- - - -	2	2
Red sand	- - - -	2	4
Red clay and sand	- - - -	1	5
Red sand	- - - -	2	7
Light red sand	- - - -	2	9
Gray clay and sand	- - - -	2	11
Red and blue clay	- - - -	1	12
Red clay	- - - -	1	13
Clay and chalk	- - - -	2	15
Red sand and chalk	- - - -	4	19
Red sand and clay	- - - -	3	22
Struck water at 19 feet. No water sample collected.			

		Thickness (feet)	Depth (feet)
Well 455			
P.& S.F.Ry.Co. right of way, center south line W1/3 sec. 91 D.& W.R.R.Co. sur., blk. 2, 10 miles south of Benjamin.			
Surface soil	- - - -	6	6
Red sand	- - - -	4	10
Brown sand	- - - -	1	11
Light brown sand	- - - -	6	17
White sand	- - - -	1	18
Brown and blue sand	- - - -	3	21
Sand and clay	- - - -	2	23
Quicksand	- - - -	2	25
Struck water at 23 feet. No water sample collected.			

		Thickness (feet)	Depth (feet)
Well 488			
G. F. Branton tract, southwest corner sec. 62, D.& W.R.R.Co. sur., blk. 2, 11 miles south of Benjamin.			
Dark brown, surface soil	- - - -	3	3
Red clay	- - - -	1	4
Red clay and chalk	- - - -	4	8
Red sand and chalk	- - - -	2	10
Red sand	- - - -	4	14
Red sand and chalk	- - - -	4	18
Red sand	- - - -	1	19
No water sample collected. Dec. 10, 1936			

		Thickness (feet)	Depth (feet)
Well 517			
Flat, Knox County right of way, center north line NE $\frac{1}{4}$ sec. 69, D.& W.R.R.Co. sur., blk. 2, 10 $\frac{1}{2}$ miles southeast of Benjamin.			
Dark brown sand	- - - -	1	1
Chocolate colored clay	- - - -	1	2
Dark red clay	- - - -	2	4
Red clay	- - - -	3	7
Chalk and red clay	- - - -	1	8
Chalk and yellow sand	- - - -	4	12
Fine, red sand	- - - -	4	16
No water sample collected. Dec. 29, 1936			

Partial analyses of water from wells in Knox County, Texas

(Analyzed at The University of Texas under the direction of Dr. E. P. Schoch, Director of the Bureau of Industrial Chemistry, by J. E. Stullken, C. R. Stewart, D. F. Riddell, and Alfred J. Kelly, Chemists, and J. A. Harraza, Martin Wieland and Jack Ramsey, Assistant Chemists. Results are in parts per million. Well numbers correspond to numbers in table of well records.)

Well No.	Owner	Depth of well (feet)	Date of collection	Total dissolved solids (calculated)	Calcium (Ca)	Magnesium (Mg)	Sodium and Potassium (Na / K) (calculated)	Bicarbonate (HCO ₃)	Sulphate (SO ₃)	Chloride (Cl)	Total hardness as CaCO ₃ (calculated)
3	R.L. Kincaid	35	Oct. 14, 1936	1,883	526	41	1	378	1,122	7	1,486
4	H.E. Black	35	do.	407	100	39	4	451	27	15	409
5	C.C. Henning	29	do.	567	122	50	15	421	121	52	511
9	C.H. Featherstone	27	do.	484	-	-	-	354	114	21	-
14	J.A. Moody	24	Oct. 14, 1936	5,015	-	-	-	268	2,408	885	-
15	- Browning	16	Oct. 20, 1936	7,166	-	-	-	317	3,185	1,530	-
18	B. Gillespie	26	Oct. 1, 1936	392	-	-	-	354	58	13	-
25	T.B. Masterson	43	do.	438	116	34	5	439	38	29	471
28	Lola Scott	43	do.	454	-	-	-	451	31	26	-
30	E.A. Burgess	33	do.	581	-	-	-	427	73	82	-
36	S.B. Parris	42	Oct. 5, 1936	1,003	-	-	-	464	119	290	-
37	F.G. Parris	60	do.	1,621	-	-	-	317	192	735	-
40	Sarah Green	37	do.	700	-	-	-	390	92	160	-
43	Jake Welch	46	Oct. 2, 1936	808	-	-	-	134	161	300	-
44	M.J. Massingale	50	do.	1,112	-	-	-	378	119	405	-
49	E.A. Burgess	47	Oct. 1, 1936	1,395	-	-	-	354	173	550	-
50	W.A. Ryder	56	do.	1,938	231	84	324	317	653	490	922
52	Lola Scott	40	do.	1,296	172	67	200	366	307	370	706
54	J.O. Cure	39	do.	1,121	-	-	-	305	173	400	-
61	Gilliland School	40	Oct. 2, 1936	753	127	36	107	439	92	175	468
63	J.D. Cook	46	Oct. 5, 1936	1,430	-	-	-	390	303	435	-
66	John Blair	60	Oct. 6, 1936	2,368	-	-	-	244	1,171	325	-
68	B.S. Martin	49	Oct. 2, 1936	1,576	-	-	-	354	407	325	-
71	E.B. McClure	41	do.	814	150	46	101	604	65	155	564
76	J.C. Eubanks	60	do.	3,837	-	-	-	146	1,824	725	-
79	L.B. Baty	54	do.	1,264	216	74	134	329	242	436	846
83	C.C. Myers	55	do.	1,283	-	-	-	146	622	180	-
85	R.G. Ilseng	36	do.	936	-	-	-	220	219	285	-
86	J. Masterson	21	Sept. 30, 1936	2,921	-	-	-	98	1,958	43	-
89	J.H. Westbrook	14	Oct. 1, 1936	4,100	581	165	485	171	2,400	385	2,132
92	R.R. Myers	40	Sept. 29, 1936	105	18	1	21	79	15	11	51

Partial analyses of water from wells in Knox County--Continued

Results are in parts per million.

Well No.	Owner	Depth of well (feet)	Date of collection	Total dissolved solids (calculated)	Calcium (Ca)	Magnesium (Mg)	Sodium and Potassium (Na / K) (calculated)	Bicarbonate (HCO ₃)	Sulphate (SO ₄)	Chloride (Cl)	Total hardness as CaCO ₃ (calculated)
93	B.R. Westbrook	45	Sept. 29, 1936	549	-	-	-	512	50	37	-
94	Tom Westbrook	42	do.	1,632	-	-	-	464	453	390	-
95	Mamie Jones	45	do.	5,175	468	421	762	336	1,229	2,130	2,900
96	do.	44	do.	405	-	-	-	439	23	8	-
98	W.F. Hickman	27	do.	912	96	54	168	366	154	260	461
102	Dr. J.E. Stoner	33	Sept. 30, 1936	4,740	-	-	-	147	2,212	950	-
104	Clyde Bullion	19	Oct. 14, 1936	3,404	530	151	330	220	2,010	275	1,943
107	J.C. Eubanks	39	do.	626	-	-	-	317	201	52	-
108	Clyde Bullion	15	do.	83	29	2	1	98	a/	3	82
109	Gwinn Hickman	41	Oct. 20, 1936	1,224	-	-	-	195	645	96	-
111	do.	17	do.	1,221	-	-	-	305	598	88	-
113	C.I. Browder	58	do.	2,852	-	-	-	159	1,403	470	-
115	do.	28	do.	484	105	65	-	610	a/	14	531
116	J.B. Eubanks	37	do.	2,200	-	-	-	256	1,024	345	-
121	L. Chesser	27	Oct. 14, 1936	125	-	-	-	146	a/	3	-
124	C.H. Featherstone	29	do.	3,218	-	-	-	244	2,389	150	-
129	W.P. McFadden	31	Dec. 9, 1936	2,959	-	-	-	403	1,536	290	-
137	G.H. Beavers	21	Oct. 6, 1936	4,012	-	-	-	174	2,246	460	-
139	J.J. Collier	27	Oct. 5, 1936	1,062	177	68	109	366	238	290	722
142	E.J. Kinnibrough	23	Oct. 27, 1936	13,307	662	918	2,755	537	3,508	5,200	5,430
144	J.C. Seaton	65	Oct. 13, 1936	366	-	-	-	305	a/	7'	-
146	Barney Welch	49	do.	766	94	22	169	427	111	160	524
148	League Davis	33	do.	630	-	-	-	85	114	255	-
150	Jess Trainham	49	do.	941	-	-	-	512	131	215	-
154	F.F. Jernigan	39	do.	660	-	-	-	378	76	155	-
159	Jack Kinnibrough	41	Oct. 27, 1936	947	-	-	-	415	125	275	-
160	Mrs. R.A. Hughes	35	do.	624	-	-	-	476	68	88	-
166	D.R. Sullivan	39	Oct. 13, 1936	750	-	-	-	390	88	195	-
168	R.C. Spinxs	39	do.	357	-	-	-	281	48	30	-
169	Vera School	50	Oct. 9, 1936	405	44	15	95	287	42	68	169
172	T.J. Couch	47	Oct. 13, 1936	462	-	-	-	342	69	51	-
176	A. Gibbons	53	Oct. 6, 1936	561	74	14	122	305	61	140	244
177	W.F. McGuire	44	do.	365	-	-	-	268	15	80	-
179	Mrs. - Sloane	43	do.	486	-	-	-	342	27	108	-

a/ Sulphate less than 10 parts per million.

Partial analyses of water from wells in Knox County--Continued

Results are in parts per million.

Well No.	Owner	Depth of well (feet)	Date of collection	Total dissolved solids (calculated)	Calcium (Ca)	Magnesium (Mg)	Sodium and Potassium (Na / K) (calculated)	Bicarbonate (HCO ₃)	Sulphate (SO ₄)	Chloride (Cl)	Total hardness as CaCO ₃ (calculated)
182	B. Welch	33	Oct. 6, 1936	501	-	-	-	366	58	76	-
183	A.J. Fuller	39	do.	250	-	-	-	207	19	34	-
186	Ray W. Gray	41	Oct. 7, 1936	486	-	-	-	232	81	116	-
189	Lee McMurray	33	do.	572	72	17	146	317	81	100	251
191	J.C. Gray	40	Oct. 13, 1936	121	-	-	-	134	a/	7	-
199	R.N. Smith	30	Oct. 8, 1936	599	81	19	121	342	85	125	282
202	Henry Robinson	25	Oct. 27, 1936	894	-	-	-	451	133	215	-
203	Paul Bussel	20	do.	541	122	49	10	342	68	124	505
204	A.R. McGaughey	34	do.	1,433	-	-	-	293	235	550	-
206	R.J. Trainham	35	Oct. 8, 1936	600	-	-	-	281	85	160	-
209	H.A. Patterson	41	do.	611	-	-	-	232	115	165	-
212	J.N. McGaughey	30	Oct. 7, 1936	641	-	-	-	256	111	175	-
214	E.C. Hardin	32	do.	673	-	-	-	293	96	190	-
217	J.H. Henson	42	do.	482	-	-	-	293	65	96	-
219	R.F. Richards	30	Oct. 6, 1936	427	62	24	71	366	50	40	255
226	I. Shipman	36	Oct. 7, 1936	304	-	-	-	281	27	23	-
230	S.M. Williams	29	Oct. 8, 1936	774	-	-	-	330	146	190	-
232	M.H. Sullins	34	do.	640	-	-	-	329	85	160	-
235	Ernest Beck	36	Oct. 21, 1936	607	75	27	120	281	57	190	297
236	J.L. Bussel	31	do.	686	-	-	-	366	57	195	-
237	J.H. Blackburn	22	do.	943	-	-	-	464	121	250	-
240	do.	30	do.	1,913	50	65	571	538	432	530	394
242	do.	21	do.	1,506	-	-	-	427	319	450	-
245	E.A. Boyd	29	Oct. 9, 1936	670	-	-	-	281	123	170	-
251	W.R. Moore	36	do.	1,125	-	-	-	390	204	330	-
252	- Blackburn	30	Oct. 19, 1936	925	65	37	240	525	125	200	318
254	T.H. Crawford	28	do.	562	-	-	-	403	53	100	-
255	W.H. Albertson	40	do.	1,352	-	-	-	488	247	385	-
256	J.J. Moore	47	do.	3,564	-	-	-	549	1,062	1,030	-
259	Mrs. Dudley Benge	29	do.	1,609	166	152	585	470	853	735	1,039
260	W.J. Blackburn	30	do.	690	49	19	193	441	106	106	203
262	H.F. King	19	do.	10,202	189	457	2,800	1,660	3,470	2,470	2,353
263	do.	20	do.	1,265	51	59	356	841	235	150	372
265	W.M. Coffman	23	Oct. 19, 1936	397	40	46	59	488	a/	12	289

a/ Sulphate less than 10 parts per million.

Partial analyses of water from wells in Knox County--Continued
Results are in parts per million.

Well No.	Owner	Depth of well (feet)	Date of collection	Total dissolved solids (calculated)	Calcium (Ca)	Magnesium (Mg)	Sodium and Potassium (Na + K) (calculated)	Bicarbonate (HCO ₃)	Sulphate (SO ₄)	Chloride (Cl)	Total hardness as CaCO ₃ (calculated)
267	Mrs. Roxy Morris	17	Oct.21,1936	2,444	-	-	-	342	948	525	-
269	do.	16	do.	309	-	-	-	354	a/	12	-
271	J.B. Tolson	19	Oct.19,1936	1,004	-	-	-	610	190	150	-
273	W.J. Blackburn	12	do.	1,809	53	69	540	831	364	375	418
274	J.H. Beck	20	do.	528	69	53	70	610	15	21	393
276	L.P. Snoddy	24	Oct.21,1936	1,343	59	62	370	780	258	210	403
277	Mrs. - Parham	30	Oct.19,1936	814	-	-	-	587	110	114	-
281	Crow Parham	29	Oct.21,1936	696	-	-	-	573	76	76	-
283	Harry Beck	25	do.	6,105	292	163	1,665	695	1,858	1,785	1,401
287	E.A. Beck	22	do.	501	-	-	-	390	84	40	-
290	Mrs. S.F. Beck	18	do.	371	-	-	-	232	110	16	-
292	Ida K. Hale	23	Oct.26,1936	2,249	108	140	526	634	463	700	846
293	J. Kinnebrough	31	do.	1,498	-	-	-	378	353	440	-
295	do.	28	do.	1,056	-	-	-	415	285	200	-
297	Chas. Hobart	18	Dec.22,1936	726	-	-	-	415	129	130	-
304	J. Keeler	37	do.	836	50	25	236	390	118	215	231
305	J.A. Hendricks	27	do.	1,033	-	-	-	525	205	200	-
307	Laura Butler	31	Dec.23,1936	923	66	25	244	384	205	194	271
310	F.A. Doss	37	do.	927	85	20	232	341	197	225	298
314	G.L. Mays	40	do.	776	-	-	-	317	121	220	-
316	Maggie Smith	38	Dec.22,1936	1,782	-	-	-	256	497	555	-
320	Chas. Matlock	38	Dec.23,1936	964	-	-	-	451	285	122	-
322	Mrs. - Huskison	43	Dec.22,1936	1,546	-	-	-	329	349	500	-
325	A.A. Dusterhouse	30	do.	901	82	102	94	372	250	190	629
328	John Arvis	24	do.	699	49	60	139	488	76	135	367
332	Joe Redder	14	Oct.28,1936	8,140	528	406	1,561	292	4,361	1,140	2,990
336	F.J. Reddon	29	Dec.21,1936	485	36	39	102	433	53	42	249
338	L. Friske	26	do.	737	-	-	-	378	125	160	-
345	H.M. Michaels	25	do.	734	-	-	-	366	102	185	-
346	do.	16	Dec.22,1936	3,485	-	-	-	476	1,081	1,000	-
358	Roy Barron	25	Dec.10,1936	401	77	17	56	336	34	52	261
360	C.C. Burns	23	do.	644	17	9	237	610	49	32	81
366	Louise Ingram	22	Nov.14,1936	522	100	59	16	464	49	70	496
367	J.W. Howell	30	do.	698	-	-	-	293	195	116	-
369	Fred. N. Decker	38	do.	556	-	-	-	354	124	58	-

a/ Sulphate less than 10 parts per million.

Partial analyses of water from wells in Knox County--Continued
Results are in parts per million.

Well No.	Owner	Depth of well (feet)	Date of collection	Total dissolved solids (calculated)	Calcium (Ca)	Magnesium (Mg)	Sodium and Potassium (Na / K) (calculated)	Bicarbonate (HCO ₃)	Sulphate (SO ₄)	Chloride (Cl)	Total hardness as CaCO ₃ (calculated)
374	W.H. Clouts	24	Jan. 1, 1937	3,586	198	233	721	458	1,289	920	1,444
376	E.F. Jones	37	do.	719	-	-	-	378	167	110	-
378	S.L. Sibly	21	do.	778	-	-	-	390	152	155	-
380	C.A. Richardson	28	Nov. 13, 1936	503	-	-	-	354	86	58	-
384	G.F. Stubbs	20	Dec. 11, 1936	500	-	-	-	256	114	82	-
385	M.F. Whitten	28	Nov. 13, 1936	706	85	51	94	268	214	130	422
387	W.F. Waldrip	26	do.	800	-	-	-	317	229	138	-
390	B.P. Denton	32	do.	496	-	-	-	256	131	64	-
392	J.L. Armstrong	26	do.	584	-	-	-	305	154	74	-
394	C.W. Armstrong	28	do.	631	-	-	-	366	154	72	-
395	B.B. Campbell	38	do.	569	-	-	-	268	180	60	-
399	J.T. Davis	17	Nov. 5, 1936	1,220	-	-	-	244	361	325	-
403	T.H. Burnett	13	do.	621	65	36	118	390	124	86	313
405	R.B. Bush	31	do.	1,924	-	-	-	305	740	400	-
407	do.	28	do.	758	-	-	-	293	167	180	-
409	do.	24	do.	1,118	-	-	-	378	239	300	-
410	do.	26	do.	2,654	-	-	-	366	1,270	355	-
411	R.C. Hamlin	14	Dec. 9, 1936	3,419	306	90	823	238	910	1,270	1,136
413	R.B. Bush	27	Nov. 5, 1936	1,174	-	-	-	195	285	390	-
414	B.F. Farmer	20	do.	834	145	2	160	305	167	210	372
420	J.W. Henderson	27	Nov. 11, 1936	2,683	214	152	468	98	1,201	600	1,159
421	W.H. Cornett	34	do.	569	-	-	-	220	195	72	-
425	L.L. Houston	40	do.	635	-	-	-	268	191	92	-
428	R.B. Bush	39	Nov. 6, 1936	2,290	-	-	-	244	1,006	425	-
431	W.O. Griffith	13	do.	1,938	-	-	-	354	1,009	140	-
435	do.	42	do.	2,989	386	201	339	275	1,138	790	1,789
436	A.L. Lea	28	do.	843	-	-	-	390	252	106	-
442	Union Grove School	18	Nov. 6, 1936	771	55	66	133	372	210	124	411
444	A.R. Forsythe	29	Nov. 5, 1936	1,063	-	-	-	195	124	465	-
445	W.R. Jones	19	do.	3,479	-	-	-	366	1,764	435	-
446	Benton Anderson	26	Nov. 6, 1936	1,045	45	37	294	560	289	104	268
450	J.H. McGee	53	Nov. 5, 1936	1,044	-	-	-	244	281	285	-
452	N.B. Webb	24	do.	1,130	137	51	196	287	300	305	552
453	C.W. Pullig	25	Nov. 6, 1936	1,273	134	56	243	318	349	335	570
456	Mrs. - Gore	29	Nov. 12, 1936	890	-	-	-	293	210	225	-

Partial analyses of water from wells in Knox County--Continued
Results are in parts per million.

Well No.	Owner	Depth of well (feet)	Date of collection	Total dissolved solids (calculated)	Calcium (Ca)	Magnesium (Mg)	Sodium and Potassium (Na / K) (calculated)	Bicarbonate (HCO ₃)	Sulphate (SO ₄)	Chloride (Cl)	Total hardness as CaCO ₃ (calculated)
457	Betty G. Davis	30	Nov.12,1936	483	42	24	108	317	97	56	205
462	J.P. Hester	43	do.	975	-	-	-	232	267	260	-
464	W.H. Cornett	52	do.	1,052	99	41	222	280	297	255	416
468	Woodward Bros.	46	do.	1,348	-	-	-	244	424	350	-
470	J.E. McPherson	50	do.	786	-	-	-	281	210	165	-
472	T.L. Nesbit	22	Nov.13,1936	1,143	-	-	-	464	334	185	-
476	Horace Roberts	31	Nov.12,1936	1,276	-	-	-	342	300	365	-
495	W.H. Walling	32	Dec.10,1936	382	-	-	-	293	57	39	-
523	T.D.L. Johnson	39	Dec.11,1936	1,238	-	-	-	183	326	400	-
532	W.E. McNeil	43	Dec.28,1936	672	-	-	-	342	129	134	-
535	do.	30	do.	869	118	75	98	465	144	205	607
537	C.A. Steinneale	32	do.	663	-	-	-	549	64	78	-
539	W.J. Wallace	37	Dec.11,1936	1,711	-	-	-	464	553	350	-
541	E.B. Bowden	42	Dec.29,1936	958	-	-	-	329	243	220	-
547	Charlie Yates	31	do.	892	115	95	46	427	106	320	684
550	Ezra Harlan	30	do.	1,570	129	66	335	330	493	365	597

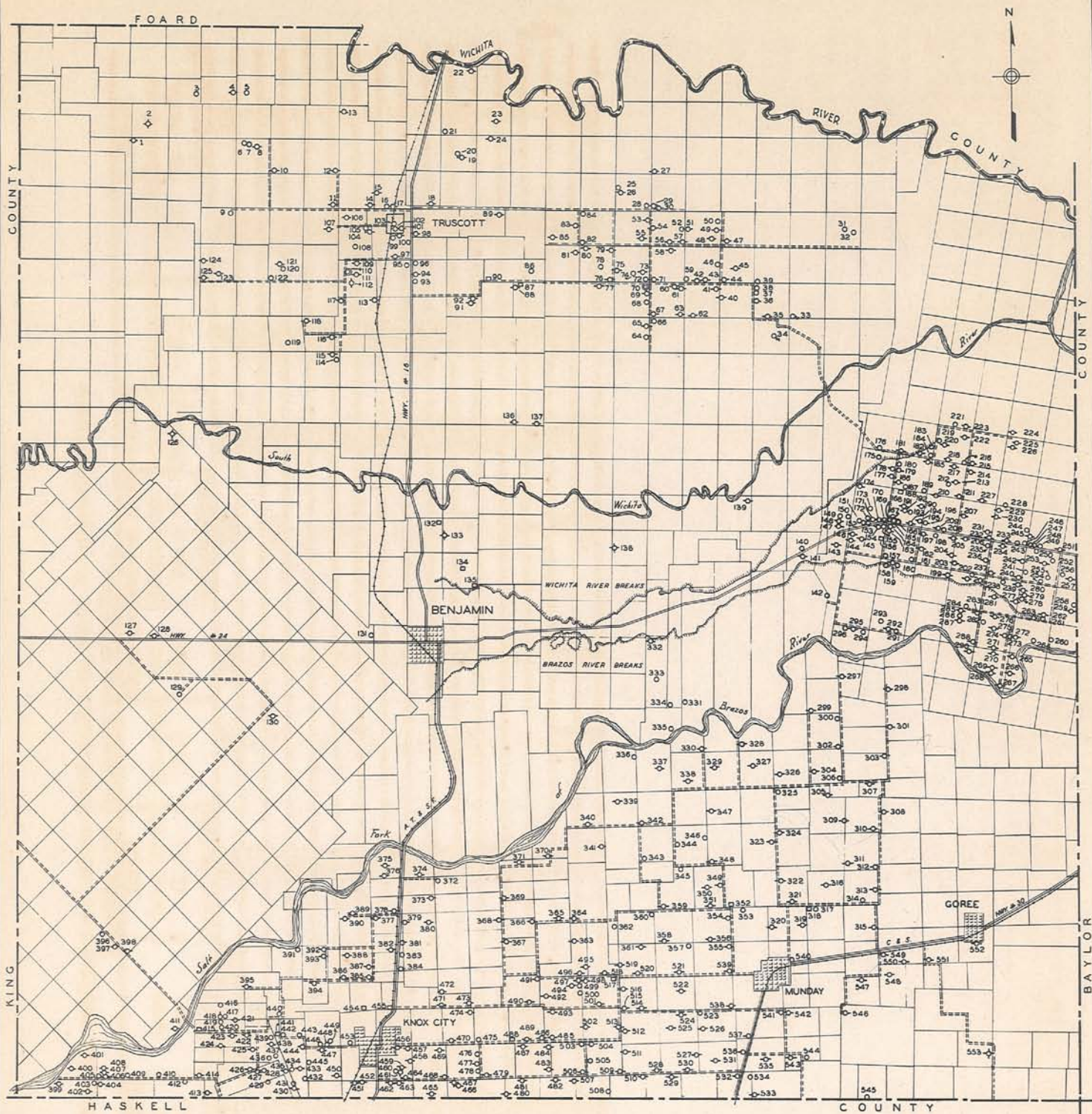

- EXPLANATION -

- WELL WITH HAND PUMP, BUCKET OR BAILER
- ◇ WELL WITH WINDMILL OR SMALL POWER PUMP
- ⊙ WELL WITH PUMPING PLANT- 5 HORSE POWER OR LARGER
- ◇ WELL DRILLED TO TEST FOR OIL OR GAS
- TEST WELL DRILLED BY W.P.A. LABOR
- ◇ UNUSED WELL
- ⊙ SPRING
- IMPROVED ROAD
- - - UNIMPROVED ROAD

TEXAS BOARD OF
WATER ENGINEERS
ASSISTED BY
U.S. GEOLOGICAL SURVEY

FIELD WORK BY
L.P. HUGGINS
PROJECT SUPERINTENDENT
W.P.A. PROJECT 2090

BASE COMPILED FROM
LAND OWNERSHIP MAP
AND FIELD NOTES

MAP OF KNOX COUNTY, TEXAS SHOWING LOCATIONS OF WATER WELLS LISTED

