

TEXAS BOARD OF WATER ENGINEERS

H. A. Beckwith, Chairman

A. P. Rollins, Member

O. F. Dent, Member

BULLETIN 5404

**RECORDS OF WATER-LEVEL MEASUREMENTS IN DALLAM, HANSFORD, HARTLEY,
HUTCHINSON, MOORE, OCHILTREE, AND SHERMAN COUNTIES, TEXAS**

Compiled by

C. R. Follett, Engineer

Texas Board of Water Engineers

Prepared in cooperation with the Geological Survey,
United States Department of the Interior

March 1954

C O N T E N T S

	Page
Introduction	1
References	2
Water level measurements in Dallam County, Tex.	5
Water level measurements in Hansford County	23
Water level measurements in Hartley County	28
Water level measurements in Hutchinson County	31
Water level measurements in Moore County	34
Water level measurements in Ochiltree County	38
Water level measurements in Sherman County	41

ILLUSTRATIONS

Map showing location of observation wells in Dallam County, Tex.	4
Hydrographs of Dallam County wells showing maximum and minimum fluctuations and annual precipitation at Dalhart	22
Map showing location of observation wells in Hansford County	24
Map showing location of observation wells in Hartley County	29
Map showing location of observation wells in Hutchinson County	32
Map showing location of observation wells in Moore County	35
Map showing location of observation wells in Ochiltree County	39
Map showing location of observation wells in Sherman County	42

RECORDS OF WATER-LEVEL MEASUREMENTS IN DALLAM, HANSFORD, HARTLEY,
HUTCHINSON, MOORE, OCHILTREE AND SHERMAN COUNTIES, TEXAS

Compiled by

C. R. Follett, Engineer
Texas Board of Water Engineers

March 1954

This bulletin contains measurements of the depth to water below land-surface datum in wells in Dallam, Hansford, Hartley, Hutchinson, Moore, Ochiltree, and Sherman Counties, which are in the Texas Panhandle north of the Canadian River. It is one of a series of publications which contain measurements of the water levels in selected observation wells.

Inventories of water wells were made in Dallam, Hansford, Hartley and Ochiltree Counties during the 1936-40 period. In 1937 water-level measurements were also made in selected wells in Sherman County. Very few measurements were made during the war years. In 1950 measurements were resumed in many of these wells and additional observation wells were selected in the irrigated areas of the counties mentioned above, and also in Moore and Hutchinson Counties. These measurements have been made as a part of a cooperative program of ground-water investigations by the United States Geological Survey and the Texas Board of Water Engineers. Some of the measurements made by the Soil Conservation Service of the Department of Agriculture are included.

If more than one water-level measurement was made during a month, only the highest water level is given in this report. The accompanying maps show the location of the observation wells with the numbers assigned to them in the records. Records of water wells and geologic data are given in the following list of publications.

REFERENCES

- BROADHURST, W. L., 1935, Records of wells in Hansford County. *
- BROADHURST, W. L., SUNDSTROM, R. W., and WEAVER, D. E., 1949, Public water supplies in western Texas, U. S. Geol. Survey Water-Supply Paper 1106.
- DAVIS, LLOYD G., 1939, Records of wells in Ochiltree County.
- FOLLETT, C. R., 1937, Records of wells in Dallam County.
- FOLLETT, C. R., and HARRISON, J. H., 1938, Records of wells in Hartley County.
- FOLLETT, C. R., SHAFER, G. H., and BROADHURST, W. L., 1938, Records of wells in Oldham County.
- FOSTER, C. V., and FOLLETT, C. R., 1940, Records of wells in Roberts County. *
- GOULD, C. N., 1906, Geology and water resources of the eastern portion of the Panhandle of Texas, U. S. Geol. Survey Water-Supply Paper 154. *
- _____, 1907, Geology and water resources of the western portion of the Panhandle of Texas, U. S. Geol. Survey Water-Supply Paper 191. *
- MEINZER, O. E., and WENZEL, L. K., 1938, Water levels and artesian pressure in wells in the United States in 1937, U. S. Geol. Survey Water-Supply Paper 840.
- _____, 1939, Water levels and artesian pressure in wells in the United States in 1938, U. S. Geol. Survey Water-Supply Paper 845.
- _____, 1940, Water levels and artesian pressure in wells in the United States in 1939, U. S. Geol. Survey Water-Supply Paper 886.
- _____, 1941, Water levels and artesian pressure in wells in the United States in 1940, U. S. Geol. Survey Water-Supply Paper 909.
- _____, 1943, Water levels and artesian pressure in wells in the United States in 1941, U. S. Geol. Survey Water-Supply Paper 939. *
- SMYERS, L. C., 1938, Records of wells in Potter County.

* Out of print. Copies available for reference in some public libraries and at the Austin office of the United States Geological Survey.

DALLAM COUNTY

2025
2024
2023
2022
2021
2020
2019
2018
2017
2016
2015
2014
2013
2012
2011
2010
2009
2008
2007
2006
2005
2004
2003
2002
2001
2000
1999
1998
1997
1996
1995
1994
1993
1992
1991
1990
1989
1988
1987
1986
1985
1984
1983
1982
1981
1980
1979
1978
1977
1976
1975
1974
1973
1972
1971
1970
1969
1968
1967
1966
1965
1964
1963
1962
1961
1960
1959
1958
1957
1956
1955
1954
1953
1952
1951
1950
1949
1948
1947
1946
1945
1944
1943
1942
1941
1940
1939
1938
1937
1936
1935
1934
1933
1932
1931
1930
1929
1928
1927
1926
1925
1924
1923
1922
1921
1920
1919
1918
1917
1916
1915
1914
1913
1912
1911
1910
1909
1908
1907
1906
1905
1904
1903
1902
1901
1900

DALLAM COUNTY, TEXAS OBSERVATION WELLS

January 1954

Bulletin 5404
Texas Board of Water Engineers
in cooperation with
U. S. Geological Survey

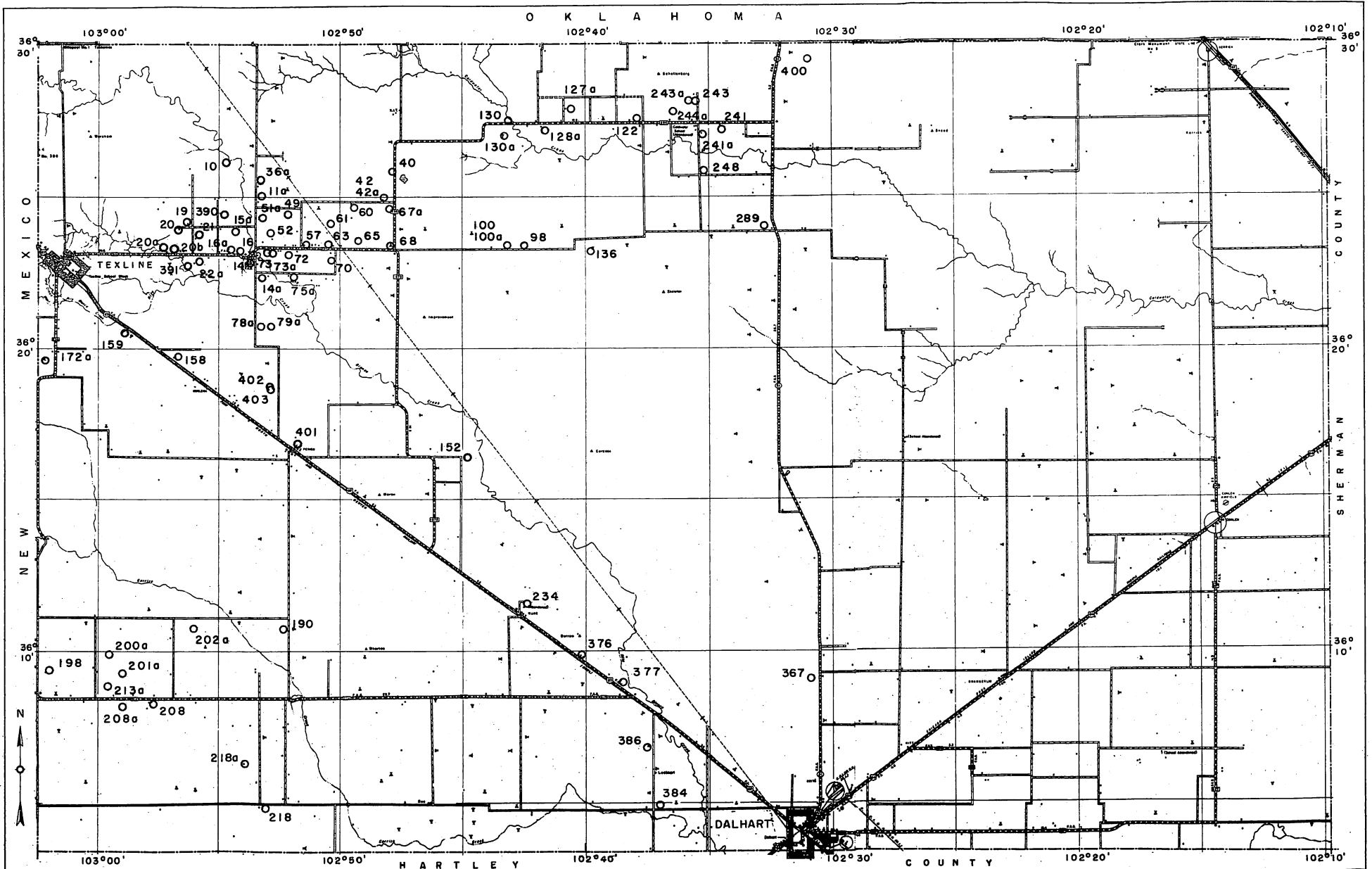

Base map by the Texas State Highway Department

0 1 2 3 4 5 MILES

DALLAM COUNTY

10. Lat. 36°26', long. 102°54'.

Date	Water level	Date	Water level	Date	Water level
Feb. 6, 1937	33.74	Feb. 19, 1951	30.65	Feb. 2, 1953	32.17
Feb. 26, 1950	30.60	Feb. 4, 1952	31.68		

11a. Lat. 36°25', long. 102°53'.

Jan. 4, 1939	*45.10	Mar. 18, 1940	*44.70	June 5, 1941	*45.27
Mar. 9	*44.62	Apr. 12	44.78	July 23	*44.35
Apr. 8	*44.72	July 1	*46.85	Aug. 21	*44.08
May 8	*44.64	Aug. 20	*46.85	Sept. 26	*44.00
July 10	*46.80	Sept. 24	*47.00	Nov. 18	*44.15
Aug. 5	*46.55	Oct. 23	*47.00	July 7, 1942	*42.50
Sept. 6	*45.15	Dec. 4	*46.50	Aug. 5	*42.85
Oct. 29	*44.86	Jan. 9, 1941	*46.75	Feb. 25, 1950	44.15
Nov. 17	*44.75	Feb. 5	*46.34	Feb. 19, 1951	49.37
Dec. 16	*44.76	Mar. 6	*46.25	Feb. 4, 1952	50.48
Jan. 24, 1940	*44.90	Apr. 4	*45.60	Feb. 2, 1953	52.73
Feb. 12	*44.90	May 8	*45.63	Jan. 15, 1954	55.11

14. Lat. 36°22', long. 102°53'.

Dec. 8, 1936	34.98	Nov. 11, 1938	34.90	May 8, 1939	*34.71
Jan. 30, 1937	34.99	Jan. 1, 1939	*35.00	June 19	*34.80
June 30	35.16	Feb. 10	34.85	Feb. 20, 1951	41.42
Jan. 13, 1938	35.04	Mar. 9	34.80	Feb. 4, 1952	42.49
May 11	35.04	Apr. 8	*34.78	Jan. 18, 1954	47.20

14a. Lat. 36°22', long. 102°53'.

Jan. 1949	*42.2	Feb. 18, 1951	36.25	Feb. 3, 1953	36.82
Feb. 26, 1950	34.27	Feb. 4, 1952	37.14		

* Measured by Soil Conservation Service.

DALLAM COUNTY

15a. Lat. 36°23', long. 102°54'.

Date	Water level	Date	Water level	Date	Water level
Jan.	*51.8	Feb. 19, 1951	50.74	Feb. 2, 1953	53.50
Feb. 26, 1950	48.57	Feb. 4, 1952	51.82	Jan. 14, 1954	56.45

16. Lat. 36°23', long. 102°54'.

Jan. 11, 1937	32.00	Sept. 6, 1939	*31.26	Dec. 6, 1940	31.81
Dec. 1, 1938	*31.50	Oct. 29	*31.70	Mar. 7, 1948	34.36
Mar. 9, 1939	31.22	Nov. 17	*31.34	Feb. 26, 1950	38.10
Apr. 8	*31.21	Dec. 16	*30.65	Feb. 22, 1951	38.47
May 8	*31.18	Jan. 24, 1940	*31.00	Feb. 4, 1952	39.30
June 19	*31.11	Mar. 19	*31.46	Feb. 2, 1953	40.75
July 8	*31.30	Apr. 12	*31.43		
Aug. 5	*31.40	July 1	*32.04		

16a. Lat. 36°23', long. 102°54'.

Aug. 20, 1940	*33.60	May 8, 1941	*33.70	Mar. 17, 1948	36.40
Sept. 24	*33.55	June 3	*33.49	Feb. 21, 1951	40.10
Dec. 4	*34.15	July 11	*33.17	Feb. 4, 1952	41.65
Jan. 9, 1941	*33.75	Sept. 26	*36.62	Feb. 2, 1953	43.00
Feb. 5	*33.60	Nov. 18	*33.20	Jan. 15, 1954	46.61
Mar. 6	*33.71	May 28, 1942	*31.27		
Apr. 4	*33.80	Mar. 11, 1943	*31.36		

19. Lat. 36°24', long. 102°56'.

Jan. 11, 1937	62.76	Aug. 5, 1939	*61.66	Mar. 17, 1948	59.70
Jan. 1, 1939	*60.26	Sept. 6	*61.39	Feb. 19, 1951	59.88
Mar. 9	60.14	Oct. 29	*61.28	Feb. 4, 1952	60.13
Apr. 8	*59.99	Nov. 17	*59.57	Jan. 14, 1954	61.90
May 8	*61.12	Dec. 16	*60.04		
July 8	*61.00	Mar. 19, 1940	*60.08		

* Measured by Soil Conservation Service.

DALLAM COUNTY

20. Lat. 36°23', long. 102°56'. Depth 65 feet.

Date	Water level	Date	Water level	Date	Water level
Jan. 1, 1939	*62.45	Aug. 5, 1939	*61.70	Mar. 19, 1940	*61.61
Mar. 9	*61.91	Sept. 6	*61.68	Apr. 12	61.89
Apr. 8	*61.65	Oct. 29	*61.82	Dec. 6	61.63
May 8	*61.93	Nov. 17	*61.59	Mar. 17, 1948	61.45
June 19	*61.63	Dec. 16	*61.70	Feb. 25, 1950	63.05
July 8	*61.69	Feb. 12, 1940	*61.90		

20a. Lat. 36°23', long. 102°57'. Depth 62 feet.

Dec. 29, 1938	*50.75	Dec. 16, 1939	*50.50	Mar. 6, 1941	*50.53
Mar. 9, 1939	50.69	Mar. 19, 1940	*50.45	Apr. 4	*50.60
Apr. 8	*50.68	Apr. 12	50.50	May 8	*50.53
May 8	*50.70	July 1	*50.55	June 5	*50.45
June 19	50.66	Aug. 20	*50.55	July 11	*50.22
July 8	*50.65	Sept. 24	*50.55	Aug. 21	*49.35
Aug. 5	*50.65	Oct. 23	*50.55	Sept. 26	*49.75
Sept. 6	*50.66	Dec. 4	51.34	Nov. 18	*49.75
Oct. 29	*50.65	Jan. 1, 1941	*50.60		
Nov. 17	*50.50	Feb. 5	*50.55		

20b. Lat. 36°23', long. 102°57'.

Feb. 21, 1951	48.36	Feb. 2, 1953	49.94	Jan. 14, 1954	51.13
Feb. 4, 1952	49.59				

21. Lat. 36°23', long. 102°56'. Depth 82 feet.

Jan. 11, 1937	62.04	Dec. 16, 1939	*61.80	Dec. 3, 1941	61.44
Jan. 1, 1939	*62.00	Jan. 24, 1940	*61.77	Mar. 17, 1948	62.00
Mar. 9	61.90	Feb. 12	*61.60	Feb. 25, 1950	68.18
Apr. 8	*61.96	Mar. 19	*61.63	Feb. 19, 1951	63.01
May 8	*61.89	Apr. 12	61.68	Feb. 4, 1952	63.31
Nov. 17	*61.58	Dec. 6, 1940	*61.89	Feb. 2, 1953	64.98

* Measured by Soil Conservation Service.

DALLAM COUNTY

22a. Lat. 36°22', long. 102°55'.

Date	Water level	Date	Water level	Date	Water level
Sept. 24, 1940	*46.65	May 27, 1943	*41.00	May 9, 1952	*53.5
Oct. 23	*46.60	Mar. 17, 1948	44.97	July 8	*51.0
Dec. 4	*45.30	Jan. 1949	*47.5	Aug. 22	*52.7
Jan. 9, 1941	*44.60	Jan. 30, 1950	*45.5	Sept. 15	*56.5
Feb. 5	*44.50	Feb. 25	45.43	Nov. 17	*49.8
Mar. 6	*44.50	Mar. 2	*45.4	Dec. 4	*48.0
Apr. 4	*44.60	June 2	*64.5	Jan. 5, 1953	*47.8
May 8	*44.46	July 17	*54.2	Feb. 2	47.44
June 5	*44.19	Sept. 1	*49.7	Mar. 9	*47.4
July 11	*43.68	Nov. 2, 1950	*49.1	Apr. 18	*47.0
Aug. 21	*46.50	Dec. 5	*46.2	Nov. 10	*49.3
Sept. 26	*44.42	Jan. 23, 1952	*46.0	Dec. 18	*49.3
Nov. 18	*41.82	Feb. 4	45.95	Jan. 14, 1954	49.14
Aug. 5, 1942	*42.02	Mar. 4	*46.2		
Mar. 11, 1943	*39.20	Apr. 9	*46.6		

36a. Lat. 36°26', long. 102°53'.

June 15, 1939	*40.6	Feb. 12, 1940	*40.60	Dec. 4, 1940	*47.83
Aug. 5	*40.9	Mar. 19	*40.40	Jan. 9, 1941	*41.35
Sept. 6	*41.0	Apr. 12	40.55	Feb. 5	*40.95
Oct. 29	*40.67	July 1	*42.06	Feb. 19, 1951	41.22
Nov. 17	*40.71	Aug. 20	*41.50	Feb. 4, 1952	42.09
Dec. 16	*40.70	Sept. 24	*41.3	Feb. 2, 1953	43.49
Jan. 24, 1940	*40.70	Oct. 23	*47.5	Jan. 15, 1954	44.44

40. Lat. 36°25', long. 102°47'. Depth 13± feet.

Jan. 13, 1937	9.94	Feb. 26, 1950	2.66	Feb. 3, 1953	2.92
Nov. 12, 1938	5.00	Feb. 17, 1951	2.25	Jan. 20, 1954	3.23
Dec. 6, 1940	4.51	Feb. 4, 1952	2.33		

* Measured by Soil Conservation Service.

DALLAM COUNTY

42. Lat. 36°24', long. 102°48'. Depth 40 feet.

Date	Water level	Date	Water level	Date	Water level
Mar. 9, 1939	10.40	Dec. 16, 1939	*11.65	Feb. 5, 1941	*11.30
Apr. 8	*10.03	Feb. 12, 1940	*11.50	Mar. 6	*11.02
May 8	*10.36	Mar. 18	*10.98	May 8	* 8.01
June 19	10.70	Apr. 12	10.80	June 5	* 5.72
July 10	*11.15	Aug. 20	*12.30	July 23	* 6.90
Aug. 5	*12.17	Sept. 24	*12.85	Aug. 21	* 7.50
Sept. 6	*12.90	Oct. 23	*12.65	Sept. 26	* 8.22
Oct. 27	*12.35	Dec. 4	12.30	May 28, 1942	* 5.60
Nov. 17	*12.06	Jan. 9, 1941	*11.55		

42a. Lat. 36°24', long. 102°48'.

Feb. 26, 1950	6.19	Feb. 4, 1952	6.40	Jan. 19, 1954	8.05
Feb. 17, 1951	5.84	Feb. 3, 1953	7.61		

49. Lat. 36°24', long. 102°51'. Depth 23 feet.

Dec. 23, 1937	18.45	Aug. 5, 1939	*18.94	Mar. 18, 1940	*18.91
Nov. 12, 1938	18.75	Sept. 6	*19.11	Apr. 12	18.93
Mar. 9, 1939	18.50	Oct. 27	*19.24	July 1	*19.55
Apr. 8	*18.40	Nov. 17	*19.12	Aug. 20	*20.80
May 8	*18.33	Dec. 16	*19.00	Sept. 24	*20.8
June 19	18.60	Jan. 24, 1940	*18.93		
July 8	*18.63	Feb. 12	*19.00		

51a. Lat. 36°24', long. 102°53'.

Aug. 20, 1940	45.80	Feb. 19, 1951	56.18	Jan. 15, 1954	63.47
July 7, 1942	45.20	Feb. 4, 1952	55.65		

* Measured by Soil Conservation Service.

DALLAM COUNTY

52. Lat. 36°23', long. 102°52'. Depth 86 feet.

Date	Water level	Date	Water level	Date	Water level
Dec. 23, 1936	36.35	June 19, 1939	37.62	Nov. 17, 1939	*37.77
Dec. 1, 1938	*36.75	July 8	*38.21	Dec. 16	*38.05
Mar. 9, 1939	36.75	Aug. 5	*38.98	Jan. 24, 1940	*37.82
Apr. 8	*36.29	Sept. 6	*38.00	Feb. 12	*37.70
May 8	*27.66	Oct. 29	*37.92	Mar. 19	*39.95

57. Lat. 36°23', long. 102°51'.

Jan. 29, 1937	23.05	Sept. 6, 1939	*24.60	June 5, 1941	*17.57
Mar. 16	23.07	Oct. 27	*24.73	July 23	*16.48
July 1	23.64	Nov. 17	*25.08	Aug. 21	*17.00
Jan. 13, 1938	23.77	Dec. 16	*24.82	Sept. 26	*16.60
May 11	23.54	Jan. 24, 1940	*24.57	Nov. 18	*16.09
Nov. 11	24.62	Mar. 19	*24.43	July 7, 1942	*14.06
Jan. 1, 1939	*24.04	Apr. 12	24.34	Aug. 5	*14.08
Feb. 10	24.01	July 1	*25.05	Mar. 11, 1943	*14.00
Mar. 9	23.90	Dec. 4	*19.50	Jan. 1949	*42.3
Apr. 8	*23.79	Jan. 9, 1941	*18.90	Feb. 26, 1950	30.05
May 8	*23.72	Feb. 5	*18.70	Feb. 19, 1951	37.98
June 19	*23.91	Mar. 6	*18.62	Feb. 4, 1952	41.88
July 8	*24.16	Apr. 4	*18.50	Jan. 18, 1954	45.66
Aug. 5	*24.35	May 8	*18.35		

60. Lat. 36°24', long. 102°49'. Depth 112 feet.

Feb. 3, 1937	69.5	Jan. 24, 1940	*70.28	May 8, 1941	*70.72
Nov. 11, 1938	69.99	Feb. 12	*70.30	June 5	*70.48
Feb. 10, 1939	70.07	Mar. 19	*69.88	July 23	*70.28
Mar. 9	70.09	Apr. 12	70.40	Aug. 21	*71.88
Apr. 8	*70.12	July 1	*70.38	Sept. 26	*69.55
May 8	*70.08	Aug. 20	*71.40	Nov. 18	*69.07
June 17	70.09	Sept. 24	*72.95	July 7, 1942	*67.66
July 10	70.09	Oct. 23	*70.5	Aug. 5	*70.13
Aug. 5	*70.13	Dec. 4	*70.7	Feb. 24, 1950	67.85
Sept. 6	*70.20	Jan. 9, 1941	*70.65	Feb. 17, 1951	68.50
Oct. 27	*70.27	Feb. 5	*70.65	Feb. 4, 1952	68.32
Nov. 17	*70.24	Mar. 6	*70.65	Feb. 3, 1953	69.18
Dec. 16	*70.30	Apr. 4	*70.70	Jan. 19, 1954	69.82

* Measured by Soil Conservation Service.

DALLAM COUNTY

61. Lat. 36°23', long. 102°50'. Depth 117 feet.

Date	Water level	Date	Water level	Date	Water level
Jan. 29, 1937	23.85	Nov. 18, 1941	*22.90	Aug. 16, 1952	*28.0
Apr. 17	24.74	July 7, 1942	*19.53	Sept. 25	*28.1
June 30	23.93	Aug. 5	*19.27	Oct. 2	*28.0
July 5	23.89	Jan. 1949	*29.4	Nov. 17	*27.6
Jan. 13, 1938	24.17	Jan. 30, 1950	*25.60	Dec. 12	*27.3
May 11	24.11	Feb. 26	*24.43	Jan. 5, 1953	*27.8
Feb. 10, 1939	24.40	Mar. 2	*25.7	Feb. 3	26.76
Mar. 9	24.37	Apr. 25	*26.6	Mar. 9	*28.1
June 29	24.32	June 2	*28.0	Apr. 15	*28.1
Dec. 20	24.75	July 17	*27.6	May 7	*28.2
Jan. 24, 1940	*24.43	Sept. 14	*26.8	June 7	*28.5
Apr. 12	24.73	Nov. 7	*27.1	July 7	*28.1
Dec. 6	25.13	Dec. 5	*26.7	Aug. 11	*29.0
Jan. 9, 1941	*25.13	Jan. 23, 1952	*27.3	Sept. 9	*29.9
Feb. 15	*25.15	Feb. 4	27.24	Oct. 9	*29.7
Mar. 6	*25.12	Mar. 4	*27.4	Nov. 23	*29.4
Apr. 12	*24.73	Apr. 9	*27.4	Dec. 18	*30.9
May 8	*24.98	May 9	*27.6	Jan. 18, 1954	29.21
June 5	*24.48	June 16	*28.8		
July 23	*23.23	July 22	*27.7		

63. Lat. 36°23', long. 102°50'. Depth 105 feet.

Apr. 19, 1937	18.90	Jan. 1949	*23.8	Feb. 3, 1953	24.70
July 1	19.01	Feb. 19, 1951	24.49	Jan. 18, 1954	29.70
Jan. 13, 1938	18.50	Feb. 4, 1952	23.49		

65. Lat. 36°23', long. 102°49'.

Dec. 8, 1936	17.54	July 5, 1937	17.02	Feb. 17, 1951	17.14
Jan. 29, 1937	17.05	Jan. 13, 1938	17.04	Feb. 4, 1952	18.98
Mar. 16	17.62	May 11	17.90	Jan. 19, 1954	19.70
Apr. 16	18.64	Nov. 11	17.68		
June 30	17.19	Feb. 10, 1939	16.74		

* Measured by Soil Conservation Service.

DALLAM COUNTY

67a. Lat. 36°24', long. 102°47'. Depth 104 feet.

Date	Water level	Date	Water level	Date	Water level
Jan. 4, 1939	*17.73	Oct. 27, 1939	*18.86	Sept. 24, 1940	*19.55
Feb. 10	17.36	Nov. 17	*18.65	Oct. 23	*19.40
Mar. 9	17.23	Dec. 16	*18.36	Dec. 4	*19.30
Apr. 8	*17.00	Jan. 24, 1940	*18.24	Jan. 9, 1941	*18.25
May 8	*16.77	Feb. 12	*17.80	Feb. 5	*18.08
June 19	*17.05	Mar. 19	*17.56	Mar. 6	*17.65
July 10	*17.42	Apr. 12	17.46	Apr. 4	*17.65
Aug. 5	*18.10	July 1	*18.02		
Sept. 6	*18.85	Aug. 20	*19.00		

68. Lat. 36°23', long. 102°47'.

Jan. 13, 1937	47.7	Feb. 17, 1951	45.17	Jan. 19, 1954	45.89
Nov. 12, 1938	47.57	Feb. 4, 1952	45.20		

70. Lat. 36°23', long. 102°50'. Depth 118 feet.

Dec. 10, 1934	22.08	Nov. 11, 1938	23.25	June 19, 1939	22.35
Jan. 29, 1937	22.33	Jan. 1, 1939	*22.77	July 8	*22.50
June 30	26.17	Feb. 10	22.40	Aug. 5	*22.54
July 7	25.22	Mar. 9	*22.24	Sept. 6	*22.79
Jan. 13, 1938	22.29	Apr. 8	*22.14	Oct. 27	*22.18
May 11	22.15	May 8	*22.12		

72. Lat. 36°23', long. 102°52'.

July 5, 1937	34.26	Jan. 24, 1940	*35.41	Aug. 21, 1941	*37.62
Jan. 13, 1938	34.09	Feb. 12	*35.10	Sept. 26	*36.85
May 11	33.99	Mar. 19	*34.99	Nov. 18	*34.84
Dec. 30	*34.20	Apr. 12	*34.94	July 7, 1942	*33.05
Feb. 10, 1939	34.28	Aug. 20	*36.20	Aug. 5	*34.25
Mar. 9	34.20	Sept. 24	*36.35	Mar. 11, 1943	*31.95
Apr. 8	*34.15	Oct. 23	*36.45	May 7	*33.10
May 8	*34.14	Dec. 4	*36.43	Mar. 17, 1948	46.36
June 19	*34.38	Jan. 9, 1941	*35.95	Jan. 1949	47.6
July 8	*34.58	Feb. 5	*35.82	Feb. 25, 1950	45.34
Aug. 5	*34.92	Mar. 6	*35.62	Feb. 19, 1951	46.90
Sept. 6	*35.02	Apr. 4	*35.55	Feb. 4, 1952	51.18
Oct. 27	*35.50	May 8	*35.15	Feb. 3, 1953	55.84
Nov. 17	*35.68	June 5	*35.03	Jan. 18, 1954	58.83
Dec. 16	*35.48	July 23	*34.70		

* Measured by Soil Conservation Service.

DALLAM COUNTY

73. Lat. 36°23', long. 102°53'.

Date	Water level	Date	Water level	Date	Water level
Dec. 10, 1934	37.15	Nov. 17, 1939	*39.10	Nov. 18, 1941	*37.33
Jan. 28, 1937	37.15	Dec. 16	*38.48	July 7, 1942	*35.92
Mar. 16	37.17	Jan. 24, 1940	*38.45	Aug. 5	*36.08
Apr. 21	39.95	Mar. 19	*38.20	May 27, 1943	*35.50
June 30	38.13	Apr. 12	38.15	Jan. 1949	*51.3
July 5	37.48	July 1	*38.60	Jan. 30, 1950	*49.3
Jan. 13, 1938	37.39	Aug. 20	*39.00	Feb. 26	*50.02
May 11	37.20	Sept. 24	*39.25	Mar. 2	*49.4
Nov. 11	37.65	Oct. 23	*39.40	June 2	*58.5
Dec. 1	*37.94	Dec. 4	*39.73	July 17	*55.8
Feb. 10, 1939	37.50	Jan. 9, 1941	*39.40	Sept. 1	*58.5
Mar. 9	37.47	Feb. 5	*38.88	Nov. 2	*53.4
Apr. 8	*37.44	Mar. 6	*38.80	Feb. 19, 1951	51.75
May 8	*37.45	Apr. 4	*38.75	Jan. 23, 1952	*56.8
June 19	*37.84	May 8	*38.60	Feb. 4	52.09
July 8	*37.96	June 5	*38.34	Mar. 4	*57.0
Aug. 5	*38.38	July 23	*37.92	May 13	*57.4
Sept. 6	*38.43	Aug. 21	*37.92	June 23	*66.0
Oct. 27	*38.47	Sept. 26	*37.95	July 8	*59.1

73a. Lat. 36°23', long. 102°53'.

Feb. 26, 1950	47.39	Feb. 4, 1952	49.58	Jan. 18, 1954	56.60
Feb. 19, 1951	48.40	Feb. 3, 1953	53.38		

75a. Lat. 36°22', long. 102°52'. Depth 120 feet.

Feb. 26, 1950	36.64	Feb. 4, 1952	40.22	Feb. 3, 1953	40.43
Feb. 18, 1951	38.48				

78a. Lat. 36°20', long. 102°53'.

Jan. 1949	26.5	Feb. 18, 1951	20.44	Feb. 3, 1953	21.10
Feb. 26, 1950	20.74	Feb. 5, 1952	20.46	Jan. 8, 1954	22.03

* Measured by Soil Conservation Service.

DALLAM COUNTY

79a. Lat. 36°20', long. 102°52'.

Date	Water level	Date	Water level	Date	Water level
Jan. 1949	*22.9	Feb. 18, 1951	16.51	Feb. 5, 1952	16.62
Feb. 26, 1950	16.63				

98. Lat. 36°23', long. 102°43'. Depth 23+ feet.

Dec. 16, 1936	22.64	Dec. 20, 1939	22.96	Feb. 3, 1953	20.00
Nov. 12, 1938	21.75	Feb. 18, 1951	19.60	Jan. 19, 1954	19.82
Mar. 9, 1939	21.49	Feb. 4, 1952	19.78		

100. Lat. 36°23', long. 102°43'. Depth 58 feet.

Dec. 19, 1936	21.4	Feb. 18, 1951	14.05	Feb. 4, 1952	13.96
---------------	------	---------------	-------	--------------	-------

100a. Lat. 36°23', long. 102°43'. Depth 180 feet.

Feb. 18, 1951	15.74	Feb. 4, 1952	15.62	Feb. 3, 1953	15.48
---------------	-------	--------------	-------	--------------	-------

122. Lat. 36°27', long. 102°37'. Depth 48± feet.

Feb. 4, 1937	42.34	Feb. 10, 1939	42.46	Dec. 6, 1940	42.82
July 1	42.44	Mar. 9	42.38	Feb. 24, 1950	38.22
Jan. 13, 1938	42.42	June 29	42.51	Feb. 18, 1951	38.13
May 11	42.36	Dec. 20	42.62		
Nov. 11	42.41	Apr. 12, 1940	42.72		

* Measured by Soil Conservation Service.

DALLAM COUNTY

127a. Lat. 36°27', long. 102°40'. Depth 180 feet.

Date	Water level	Date	Water level	Date	Water level
Dec. 1948	*54.2	Jan. 2, 1952	*54.0	Feb. 3, 1953	54.14
Aug. 30, 1949	*57.3	Mar. 4	*54.5	Mar. 11	*54.6
Sept. 20	*55.0	Apr. 9	*54.5	Apr. 18	*55.8
Oct. 24	*53.9	May 9	*54.3	May 12	*57.7
Nov. 25	*54.3	June 9	*54.7	July 27	*61.3
Jan. 30, 1950	*53.8	July 14	*57.3	Oct. 9	*61.5
Mar. 2	*54.0	Aug. 18	*57.7	Nov. 17	*58.4
Apr. 25	*56.0	Sept. 12	*57.5	Dec. 18	*57.7
July 14	*55.3	Oct. 16	*55.8	Jan. 19, 1954	56.92
Sept. 14	*54.3	Nov. 10	*55.2		
Oct. 18	*54.6	Dec. 2	*55.3		
Dec. 5	*54.9	Jan. 5, 1953	*55.2		

128a. Lat. 36°27', long. 102°41'.

Dec. 6, 1940	45.63	Jan. 1949	*44.90	Feb. 3, 1953	47.08
Dec. 4, 1941	44.55				

130. Lat. 36°27', long. 102°43'. Depth 30 feet.

Jan. 16, 1937	17.12	Nov. 11, 1938	16.91	Dec. 20, 1939	17.04
July 1	16.38	Feb. 10, 1939	16.21	Apr. 12, 1940	16.03
Jan. 13, 1938	17.07	Mar. 9	16.06	Dec. 6	17.11
May 11	16.54	June 29	16.62	Dec. 4, 1941	15.08

130a. Lat. 36°27', long. 102°43'. Depth 120± feet.

Feb. 24, 1950	28.64	Feb. 4, 1952	29.24	Jan. 20, 1954	29.25
Feb. 18, 1951	29.01	Feb. 3, 1953	29.23		

136. Lat. 36°23', long. 102°39'. Depth 164 feet.

Feb. 4, 1937	130.7	Feb. 4, 1952	127.79	Jan. 19, 1954	127.73
Feb. 18, 1951	127.25	Feb. 3, 1953	128.15		

*Measured by Soil Conservation Service.

DALLAM COUNTY

152. Lat. $36^{\circ}16'$, long. $102^{\circ}45'$. Depth 250 feet.

Date	Water level	Date	Water level	Date	Water level
Mar. 9, 1937	246.82	Apr. 12, 1940	246.30	Mar. 17, 1948	241.95
Mar. 8, 1939	246.52	Aug. 8	246.06	Feb. 26, 1950	241.32
June 29	246.44	Dec. 6	245.86		
Dec. 20	246.01	Dec. 3, 1941	240.35		

158. Lat. $36^{\circ}19'$, long. $102^{\circ}57'$. Depth 93 feet.

Feb. 22, 1937	70.55	May 11, 1938	69.41	June 29, 1939	70.10
June 30	70.53	Nov. 11	70.36	Apr. 12, 1940	70.09
Jan. 13, 1938	70.38	Mar. 9, 1939	70.22	Dec. 6	69.88

159. Lat. $36^{\circ}20'$, long. $102^{\circ}58'$. Depth 126 feet.

Feb. 22, 1937	71.56	June 29, 1939	67.87	Feb. 26, 1950	59.00
June 30	71.71	Dec. 20	67.74	Feb. 20, 1951	58.15
Jan. 13, 1938	68.81	Apr. 12, 1940	68.52	Jan. 14, 1953	56.60
May 11	68.84	Aug. 8	68.87	Jan. 8, 1954	58.02
Nov. 11	67.53	Dec. 6	69.30		
Mar. 8, 1939	67.40	Dec. 3, 1941	62.71		

172a. Lat. $36^{\circ}19'$, long. $103^{\circ}02'$. Depth 360 feet.

Feb. 25, 1950	91.27	Feb. 3, 1952	90.46	Jan. 20, 1954	89.25
Feb. 18, 1951	90.53	Jan. 14, 1953	89.04		

190. Lat. $36^{\circ}10'$, long. $102^{\circ}52'$. Depth 197+ feet.

Feb. 12, 1937	183.2	Feb. 5, 1952	181.30	Jan. 8, 1954	180.63
Feb. 18, 1951	181.49	Jan. 14, 1953	180.88		

* Measured by Soil Conservation Service.

DALLAM COUNTY

198. Lat. 36°09', long. 103°02'. Depth 139 feet.

Date	Water level	Date	Water level	Date	Water level
Feb. 10, 1937	115.75	Feb. 18, 1951	112.58	Jan. 14, 1953	112.08
Feb. 25, 1950	113.30	Feb. 5, 1952	112.52	Jan. 15, 1954	111.87

200a. Lat. 36°09', long. 102°59'. Depth 250 feet.

Jan. 1949	*101.0	Feb. 18, 1951	99.05	Jan. 14, 1953	97.81
Feb. 25, 1950	98.91	Feb. 5, 1952	98.48	Jan. 15, 1954	99.11

201a. Lat. 36°09', long. 102°59'. Depth 250 feet.

Jan. 1949	*93.0	Feb. 18, 1951	90.47	Jan. 14, 1953	90.75
Feb. 25, 1950	90.43	Feb. 5, 1952	90.64	Jan. 15, 1954	91.35

202a. Lat. 36°10', long. 102°55'.

Feb. 25, 1950	84.53	Feb. 5, 1952	83.99	Jan. 14, 1954	83.70
Feb. 18, 1951	84.18	Jan. 14, 1953	83.78		

208. Lat. 36°08', long. 102°57'. Depth 94 feet.

Mar. 2, 1937	75.97	Feb. 18, 1951	73.96	Jan. 14, 1953	74.61
Feb. 25, 1950	74.00	Feb. 5, 1952	74.35		

208a. Lat. 36°08', long. 102°59'. Depth 250 feet.

Dec. 1948	81.2	Jan. 4, 1952	80.8	Jan. 14, 1953	81.03
July 1949	80.75	Feb. 5	80.80	Feb. 24	*80.9
Dec. 2	80.4	Mar. 10	80.6	Mar. 16	*81.7
Jan. 6, 1950	80.2	Apr. 2	80.7	Apr. 20	*81.9
Feb. 3	80.1	May 20	80.9	May 25	*82.6
Mar. 29	80.1	June 25	83.6	June 3	*82.3
Apr. 25	83.4	July 10	81.9	Sept. 3	*82.5
June 26	84.0	Sept. 15	82.4	Oct. 13	*82.1
July 24	91.7	Oct. 3	82.0	Nov. 20	*81.9
Sept. 7	82.7	Nov. 17	81.3	Jan. 14, 1954	81.63
Feb. 18, 1951	80.53	Dec. 29	81.2		

* Measured by Soil Conservation Service.

DALLAM COUNTY

213a. Lat. $36^{\circ}08'$, long. $102^{\circ}59'$. Depth 250 feet.

Date	Water level	Date	Water level	Date	Water level
Jan. 1949	*107.0	Feb. 5, 1952	105.99	Jan. 15, 1954	106.39
Feb. 25, 1950	105.10	Jan. 14, 1953	105.98		

218. Lat. $36^{\circ}04'$, long. $102^{\circ}53'$. Depth 192 feet.

Feb. 12, 1937	154.78	Feb. 18, 1951	151.87	Jan. 8, 1954	152.26
Feb. 25, 1950	152.63	Feb. 5, 1952	152.05		

218a. Lat. $36^{\circ}06'$, long. $102^{\circ}54'$.

Feb. 25, 1950	168.11	Feb. 5, 1952	168.86	Jan. 8, 1954	169.53
Feb. 18, 1951	168.39	Jan. 14, 1953	169.06		

234. Lat. $36^{\circ}11'$, long. $102^{\circ}42'$. Depth 300+ feet.

Apr. 12, 1937	285.26	May 11, 1938	274.10	Dec. 20, 1939	274.17
June 30	274.66	Mar. 8, 1939	274.53	Dec. 6, 1940	274.20
Jan. 13, 1938	274.38	June 29	274.62		

241. Lat. $36^{\circ}27'$, long. $102^{\circ}34'$. Depth 135 feet.

Feb. 4, 1937	51.88	Feb. 10, 1939	51.53	Dec. 6, 1940	51.60
July 5	51.85	Mar. 9	51.51	Dec. 4, 1941	51.89
Jan. 13, 1938	51.75	June 29	51.52	Mar. 17, 1948	49.84
May 11	52.22	Dec. 20	51.50		
Nov. 11	51.57	Apr. 12, 1940	51.54		

* Measured by Soil Conservation Service.

DALLAM COUNTY

241a. Lat. 36°27', long. 102°35'.

Date	Water level	Date	Water level	Date	Water level
Dec. 1948	*34.6	Nov. 2, 1950	*38.0	Oct. 16, 1952	*37.0
Sept. 20, 1949	*34.2	Dec. 5	*34.7	Nov. 10	*35.0
Oct. 24	*33.6	Feb. 18, 1951	33.15	Dec. 2	*34.6
Nov. 25	*33.2	Jan. 2, 1952	*33.7	Jan. 5, 1953	*34.1
Jan. 30, 1950	*33.0	Feb. 4	35.26	Feb. 3	34.27
Mar. 2	*33.0	Mar. 4	*33.9	Mar. 11	*33.7
Apr. 25	*34.3	Apr. 11	*36.3	Oct. 9	*41.1
July 14	*34.7	May 19	*34.4	Nov. 17	*37.4
Sept. 14	*35.6	June 6	*34.6	Dec. 18	*34.8
Oct. 18	*34.8	July 14	*36.1	Jan. 19, 1954	*34.53

243. Lat. 36°28', long. 102°35'. Depth 64 feet.

Mar. 10, 1937	33.70	Apr. 12, 1940	33.46	Feb. 18, 1951	29.30
Nov. 12, 1938	33.35	Dec. 6	33.15	Feb. 4, 1952	28.84
June 29, 1939	33.26	Dec. 4, 1941	32.25	Feb. 2, 1953	29.25
Dec. 20	33.38	Feb. 24, 1950	30.44	Mar. 19, 1954	29.46

243a. Lat. 36°28', long. 102°35'. Depth 150 feet.

Feb. 24, 1950	34.66	Feb. 4, 1952	33.64	Feb. 2, 1953	34.06
Feb. 18, 1951	34.10				

244a. Lat. 36°27', long. 102°36'.

Dec. 6, 1940	45.04	Feb. 24, 1950	40.29	Jan. 19, 1954	43.76
Dec. 4, 1941	44.28	Feb. 18, 1951	40.60		
Jan. 1949	*41.2	Feb. 3, 1953	42.76		

248. Lat. 36°25', long. 102°35'. Depth 39 feet.

Feb. 4, 1937	13.97	Feb. 10, 1939	13.45	Feb. 3, 1953	9.50
July 5	13.27	Mar. 8	13.40	Jan. 19, 1954	3.90
Jan. 13, 1938	13.63	Feb. 18, 1951	9.40		
May 11	13.75	Feb. 4, 1952	9.35		

* Measured by Soil Conservation Service.

DALLAM COUNTY

289. Lat. $36^{\circ}23'$, long. $102^{\circ}32'$. Depth 190 feet.

Date	Water level	Date	Water level	Date	Water level
Mar. 10, 1937	155.75	Jan. 13, 1938	155.73	Dec. 20, 1939	155.40
July 5	155.98	Feb. 10, 1939	156.03		

367. Lat. $36^{\circ}09'$, long. $102^{\circ}30'$. Depth 275 feet.

Apr. 13, 1937	260.75	Feb. 10, 1939	260.35	Dec. 20, 1939	261.33
July 5	260.73	Mar. 9	260.97	Apr. 12, 1940	261.09
Jan. 13, 1938	261.10	June 29	261.06		

376. Lat. $36^{\circ}09'$, long. $102^{\circ}40'$. Depth 257 feet.

Feb. 24, 1937	245.21	Dec. 20, 1939	244.60	Aug. 8, 1940	244.92
June 29, 1939	245.12	Apr. 12, 1940	245.29	Dec. 6	245.54

377. Lat. $36^{\circ}08'$, long. $102^{\circ}38'$. Depth 214 feet.

Feb. 24, 1937	209.62	June 29, 1939	205.41	Dec. 6, 1940	204.80
Mar. 8, 1939	205.28	Apr. 12, 1940	205.58		

384. Lat. $36^{\circ}04'$, long. $102^{\circ}37'$. Depth 230 feet.

Mar. 1, 1937	199.54	Nov. 11, 1938	198.85	Aug. 8, 1940	198.97
June 30	199.30	Mar. 8, 1939	199.10	Dec. 6	198.76
July 4	199.30	June 29	199.23	Dec. 3, 1941	198.80
Jan. 13, 1938	198.94	Dec. 20	198.84	Feb. 26, 1950	197.88
May 11	199.16	Apr. 12, 1940	199.55	Feb. 17, 1951	197.44

386. Lat. $36^{\circ}06'$, long. $102^{\circ}37'$. Depth 246 feet.

Apr. 1, 1937	235.37	Jan. 13, 1938	234.90	June 29, 1939	221.66
June 30	235.40	Nov. 11	198.16		
July 4	235.20	Mar. 8, 1939	220.32		

* Measured by Soil Conservation Service.

DALLAM COUNTY

390. Lat. 36°24', long. 102°54'.

Date	Water level	Date	Water level	Date	Water level
Aug. 21, 1941	*59.3	Jan. 23, 1952	*63.6	Feb. 12, 1953	*64.5
July 7, 1942	*49.15	Feb. 4	63.15	Mar. 9	*63.7
Mar. 11, 1943	*49.76	Mar. 4	*64.3	Apr. 18	*72.4
Jan. 1949	*60.2	Apr. 9	*76.7	May 12	*70.6
Jan. 30, 1950	*60.1	May 16	*84.3	June 4	*67.2
Mar. 2	*59.4	June 11	*74.5	Aug. 21	*79.9
Apr. 25	*60.6	Aug. 22	*83.6	Sept. 9	*78.7
Sept. 14	*71.1	Sept. 19	*75.6	Oct. 9	*73.1
Nov. 2	*67.5	Nov. 10	*72.4	Nov. 17	*69.7
Dec. 5	*64.7	Dec. 4	*67.8	Dec. 18	*68.0
Feb. 9, 1951	63.67	Jan. 5, 1953	*65.4	Jan. 18, 1954	66.64

391. Lat. 36°22', long. 102°56'.

June 1949	*55.7	Feb. 4, 1952	50.55	Apr. 18, 1953	*54.3
Sept. 20	*52.5	Mar. 4	*50.8	June 4	*56.2
Oct. 24	*52.0	Apr. 9	*51.1	July 7	*58.0
Jan. 9, 1950	*50.9	May 9	*51.3	Aug. 11	*57.0
Mar. 2	*51.1	July 8	*59.1	Sept. 9	*56.5
Apr. 25	*50.9	Sept. 15	*56.3	Oct. 9	*56.0
July 17	*52.8	Oct. 2	*55.0	Nov. 17	*53.6
Sept. 14	*54.2	Nov. 10	*52.6	Dec. 18	*53.9
Nov. 2	*51.9	Dec. 4	*52.5	Jan. 14, 1954	53.17
Dec. 5	*51.3	Jan. 5, 1953	*52.2		
Feb. 21, 1951	50.61	Feb. 2	51.98		
Jan. 23, 1952	*50.6	Mar. 9	*52.0		

400. Lat. 36°29', long. 102°31'. Depth 258 feet.

Jan. 1949	72.7	Feb. 24, 1950	69.05	Feb. 18, 1951	68.88
-----------	------	---------------	-------	---------------	-------

401. Lat. 36°16', long. 102°51'. Depth 250 feet.

Feb. 20, 1951	135.58	Jan. 14, 1953	135.61	Jan. 8, 1954	135.21
Feb. 5, 1952	135.05				

402. Lat. 36°18', long. 102°53'. Depth 337 feet.

Feb. 21, 1951	35.58	Feb. 5, 1952	34.01	Jan. 8, 1954	34.50
---------------	-------	--------------	-------	--------------	-------

403. Lat. 36°18', long. 102°53'. Depth 337 feet.

Feb. 21, 1951	35.92	Feb. 5, 1952	34.27	Jan. 8, 1954	35.90
---------------	-------	--------------	-------	--------------	-------

* Measured by Soil Conservation Service.

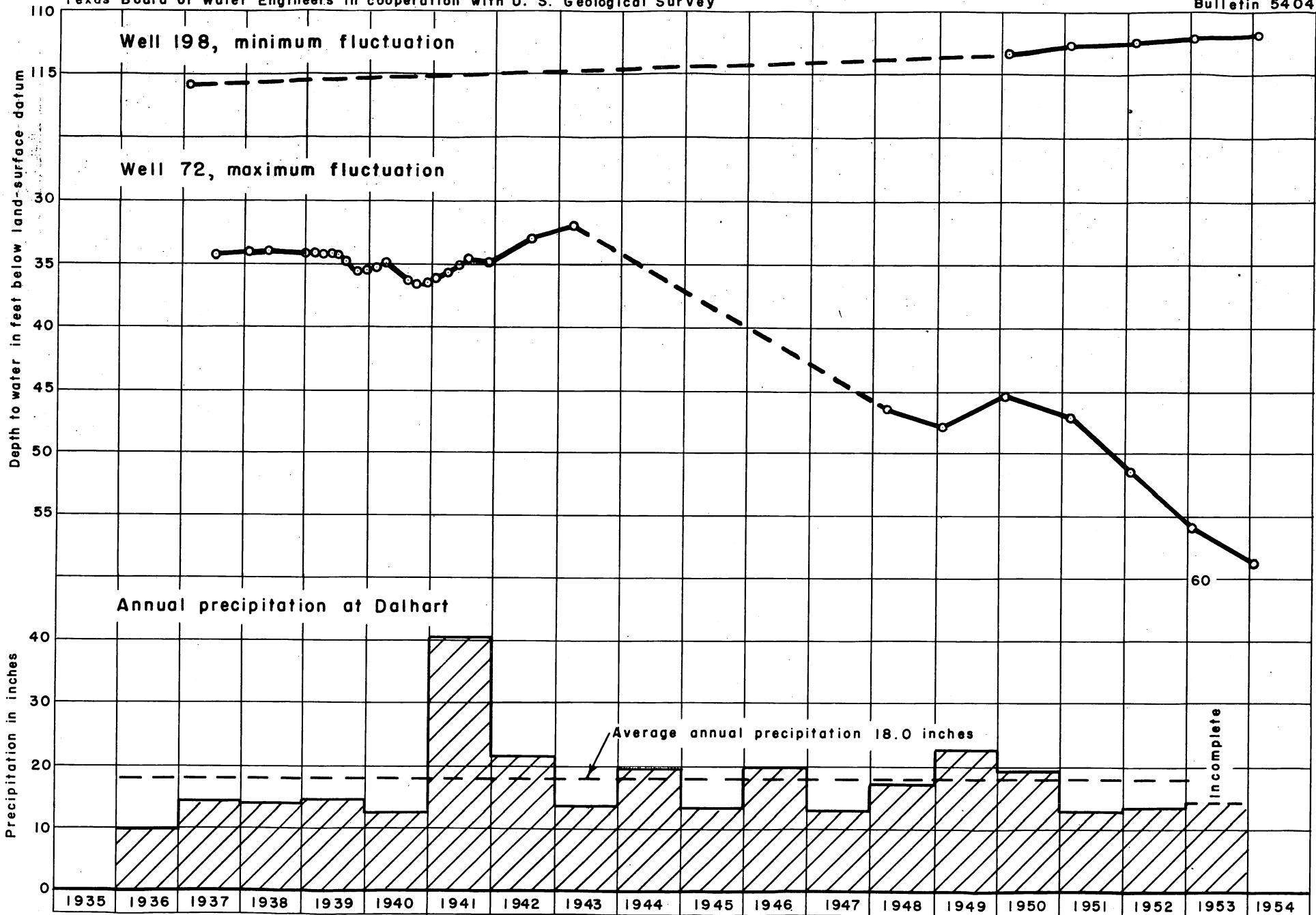

Hydrographs of Dallam County wells showing maximum and minimum fluctuations and annual precipitation at Dalhart, Texas

HANSFORD COUNTY

HANSFORD COUNTY, TEXAS OBSERVATION WELLS January 1954

Bulletin 5404
Texas Board of Water Engineers
in cooperation with
U. S. Geological Survey

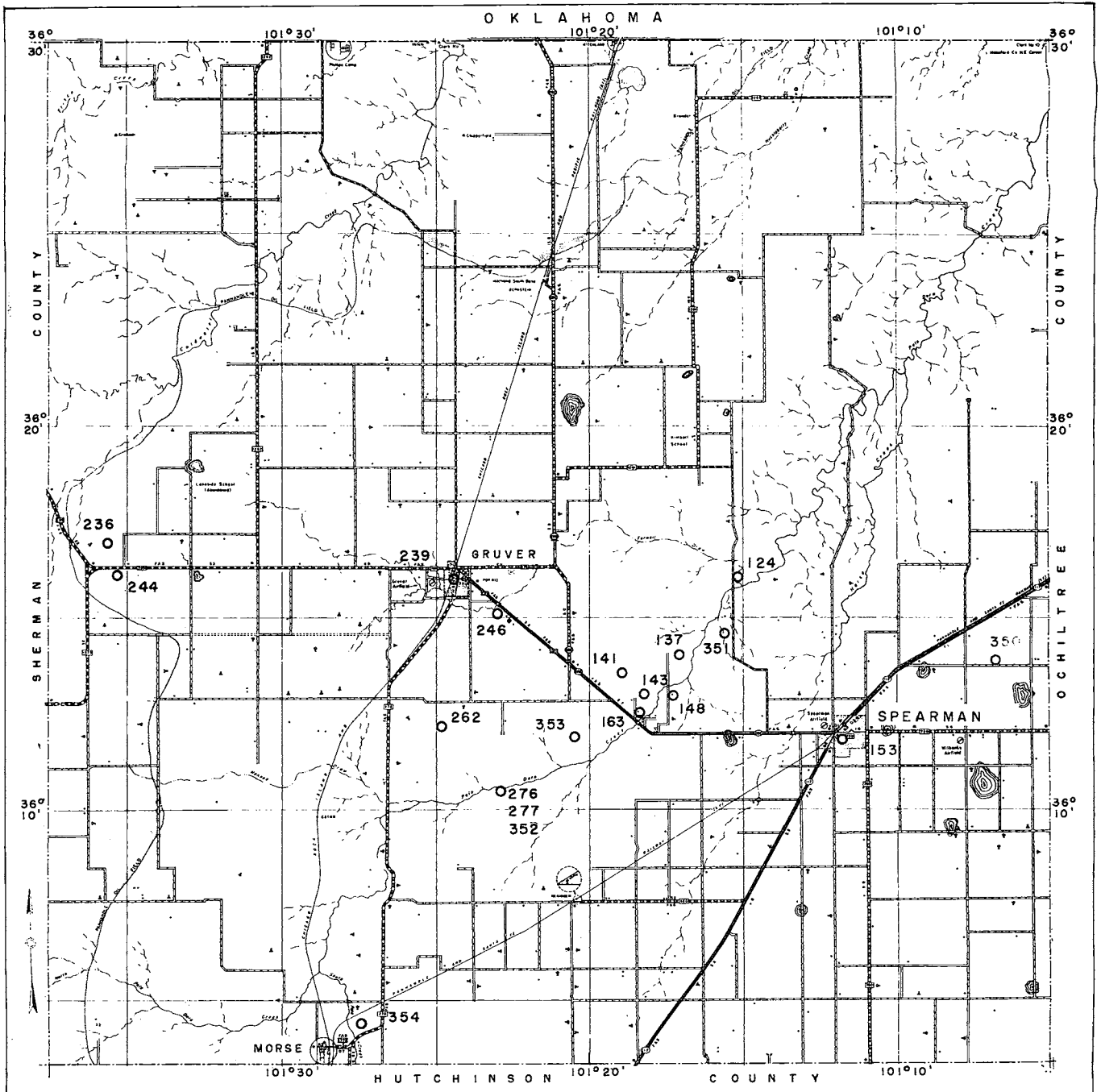

Base map by the Texas State
Highway Department

0 1 2 3 4 5 MILES

HANSFORD COUNTY

124. Lat. 36°16', long. 101°15'. Depth 151 feet.

Date	Water level	Date	Water level	Date	Water level
Mar. 13, 1936	71.92	Jan. 14, 1938	71.78	Dec. 21, 1939	71.74
Apr. 14	72.10	May 12	71.83	Apr. 10, 1940	72.00
June 10	72.25	Feb. 13, 1939	71.23	Dec. 5, 1941	71.76
July 29, 1937	71.92	June 30	71.51		

137. Lat. 36°14', long. 101°17'. Depth 115 feet.

Feb. 20, 1936	67.47	July 29, 1937	67.15	Apr. 10, 1940	67.91
Mar. 11	67.45	Jan. 14, 1938	67.20	Aug. 7	68.14
Apr. 27	66.90	Feb. 13, 1939	66.73	Dec. 5	68.25
May 25	66.00	June 30	67.12	Dec. 5, 1941	66.43
June 1	66.80	Dec. 21	67.60		

141. Lat. 36°13', long. 101°18'. Depth 117 feet.

Feb. 27, 1936	72.4	May 25, 1936	72.00	Apr. 10, 1940	71.30
Mar. 11	72.43	June 10	72.50	Dec. 5	71.43
Apr. 13	72.40	Feb. 13, 1939	70.70		

143. Lat. 36°13', long. 101°18'. Depth 500 feet.

Feb. 16, 1951	56.15	Feb. 6, 1952	55.86	Jan. 13, 1953	56.30
---------------	-------	--------------	-------	---------------	-------

148. Lat. 36°12', long. 101°17'. Depth 79 feet.

Feb. 27, 1936	70.40	May 25, 1936	69.90	Jan. 14, 1938	69.90
Mar. 11	69.95	June 10	70.10	May 12	70.05
Apr. 13	70.40	July 29, 1937	69.76	Feb. 13, 1939	69.54

153. Lat. 36°12', long. 101°11'. Depth 348 feet.

May 23, 1936	256.5	Jan. 14, 1938	256.14	Dec. 5, 1940	256.15
July 29, 1937	256.94				

HANSFORD COUNTY

163. Lat. 36°12', long. 101°18'. Depth 200 feet.

Date	Water level	Date	Water level	Date	Water level
Feb. 26, 1936	82.08	June 10, 1936	81.00	Feb. 13, 1939	79.95
Mar. 12	81.54	July 27, 1937	81.00	June 30	80.24
Apr. 27	81.24	Jan. 14, 1938	80.63	Dec. 21	80.41
May 26	81.00	May 12	80.64	Apr. 10, 1940	80.45

236. Lat. 36°17', long. 101°35'. Depth 224 feet.

June 1, 1936	186.0	Mar. 10, 1939	169.89	Dec. 5, 1941	168.82
Jan. 14, 1938	170.18	Dec. 21	169.80		
May 12	170.21	Dec. 5, 1940	169.85		

239. Lat. 36°15', long. 101°24'. Depth 502 feet.

Aug. 14, 1936	148.1	June 30, 1939	147.95	Dec. 5, 1940	148.02
July 26, 1937	148.00	Dec. 21	147.92		
Mar. 10, 1939	147.89	Aug. 8, 1940	148.19		

244. Lat. 36°16', long. 101°35'. Depth 225 feet.

July 29, 1937	178.56	Mar. 10, 1939	178.57	Feb. 6, 1952	177.64
Aug. 20	178.56	Aug. 8, 1940	178.54	Jan. 13, 1953	177.53
Jan. 15, 1948	178.57	Dec. 5	178.35		
May 12	178.63	Dec. 4, 1941	178.52		

246. Lat. 36°15', long. 101°22'. Depth 194 feet.

Apr. 15, 1936	181.70	May 12, 1938	172.22	Dec. 5, 1940	172.68
July 26, 1937	173.23	Feb. 13, 1939	172.58	Dec. 5, 1941	172.56
Jan. 14, 1938	173.17	Aug. 7, 1940	172.68		

262. Lat. 36°11', long. 101°24'. Depth 64 feet.

Mar. 7, 1936	43.63	Jan. 14, 1938	43.65	Dec. 21, 1939	44.01
Apr. 13	43.69	May 12	43.74	Dec. 5, 1941	43.57
July 28, 1937	43.54	Feb. 13, 1939	43.50		

HANSFORD COUNTY

276. Lat. 36°10', long. 101°22'.

Date	Water level	Date	Water level	Date	Water level
Mar. 26, 1936	34.9	Feb. 6, 1952	33.81	Jan. 12, 1954	33.57
Feb. 16, 1951	33.49	Jan. 13, 1953	33.83		

277. Lat. 36°10', long. 101°22'. Depth 120 feet.

Mar. 26, 1936	28.32	Dec. 21, 1939	28.24	Jan. 13, 1953	26.98
Apr. 13	27.79	Dec. 5, 1940	28.82	Jan. 12, 1954	26.90
Jan. 14, 1938	27.10	Dec. 5, 1941	27.03		
Feb. 13, 1939	27.10	Feb. 16, 1951	26.63		

350. Lat. 36°14', long. 101°06'. Depth 494 feet.

Feb. 16, 1951	268.97	Jan. 13, 1953	269.24	Jan. 22, 1954	269.79
Feb. 6, 1952	269.02				

351. Lat. 36°14', long. 101°15'. Depth 185 feet.

Feb. 16, 1951	70.12	Jan. 13, 1953	70.53	Jan. 12, 1954	71.05
Feb. 6, 1952	69.65				

352. Lat. 36°10', long. 101°22'.

Feb. 16, 1951	24.95	Jan. 13, 1953	24.91	Jan. 12, 1954	24.92
Feb. 6, 1952	24.82				

353. Lat. 36°11', long. 101°20'. Depth 205 feet.

Feb. 17, 1951	59.38	Jan. 13, 1953	59.19	Jan. 12, 1954	59.30
Feb. 6, 1952	58.81				

354. Lat. 36°04', long. 101°27'.

Feb. 17, 1951	48.95	Jan. 12, 1953	50.51	Jan. 13, 1954	51.47
Feb. 7, 1952	50.87				

HARTLEY COUNTY

HARTLEY COUNTY, TEXAS
OBSERVATION WELLS
January 1954

Bulletin 5404
Texas Board of Water Engineers
in cooperation with
U. S. Geological Survey

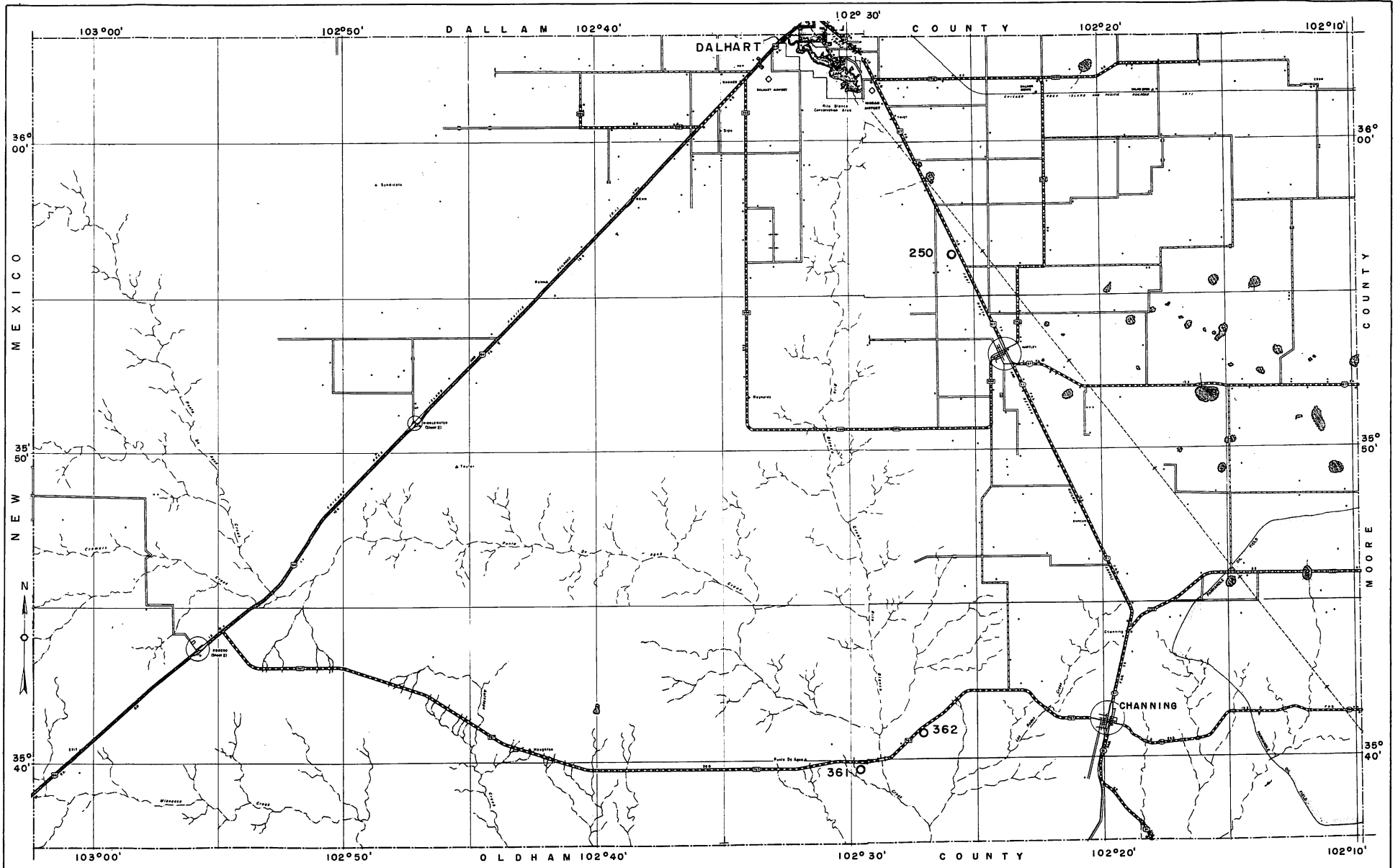

Base map by the Texas State Highway Department

0 1 2 3 4 5 MILES

HARTLEY COUNTY

250. Lat. $35^{\circ}56'$, long. $102^{\circ}25'$.

Date	Water level	Date	Water level	Date	Water level
May 11, 1938	320.95	June 28, 1939	320.86	Apr. 12, 1940	321.07
Mar. 8, 1939	320.79	Dec. 20	320.80		

361. Lat. $35^{\circ}39'$, long. $102^{\circ}27'$ Depth 120 feet.

Feb. 2, 1952	33.18	Jan. 12, 1953	33.30	Jan. 6, 1954	33.48
--------------	-------	---------------	-------	--------------	-------

362. Lat. $35^{\circ}40'$, long. $102^{\circ}27'$.

Jan. 12, 1953	63.67	Jan. 6, 1954	64.28		
---------------	-------	--------------	-------	--	--

HUTCHINSON COUNTY

HUTCHINSON COUNTY, TEXAS OBSERVATION WELLS

January 1954

Bulletin 5404
Texas Board of Water Engineers
in cooperation with
U. S. Geological Survey

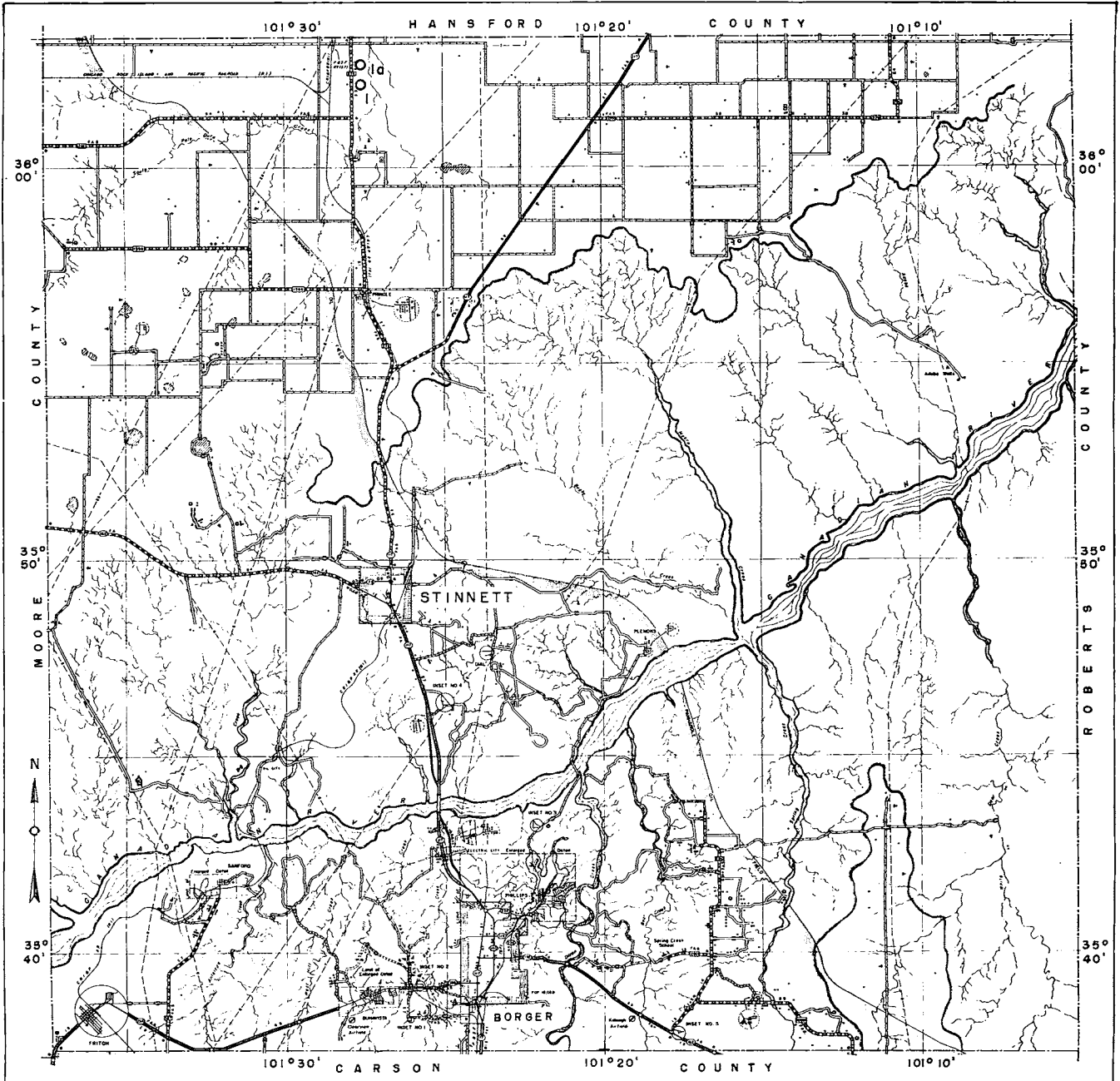

Base map by the Texas State
Highway Department

0 1 2 3 4 5 MILES

HUTCHINSON COUNTY

1. Lat. $36^{\circ}02'$, long. $101^{\circ}27'$.

Date	Water level	Date	Water level	Date	Water level
Feb. 23, 1950	84.64	Jan. 12, 1953	88.22	Jan. 13, 1954	89.43
Feb. 7, 1952	86.18				

1a. Lat. $36^{\circ}02'$, long. $101^{\circ}27'$.

Feb. 7, 1952	67.31	Jan. 12, 1953	68.87	Jan. 13, 1954	70.24
--------------	-------	---------------	-------	---------------	-------

MOORE COUNTY

MOORE COUNTY, TEXAS
OBSERVATION WELLS
January 1954

Bulletin 5404
Texas Board of Water Engineers
in cooperation with
U. S. Geological Survey

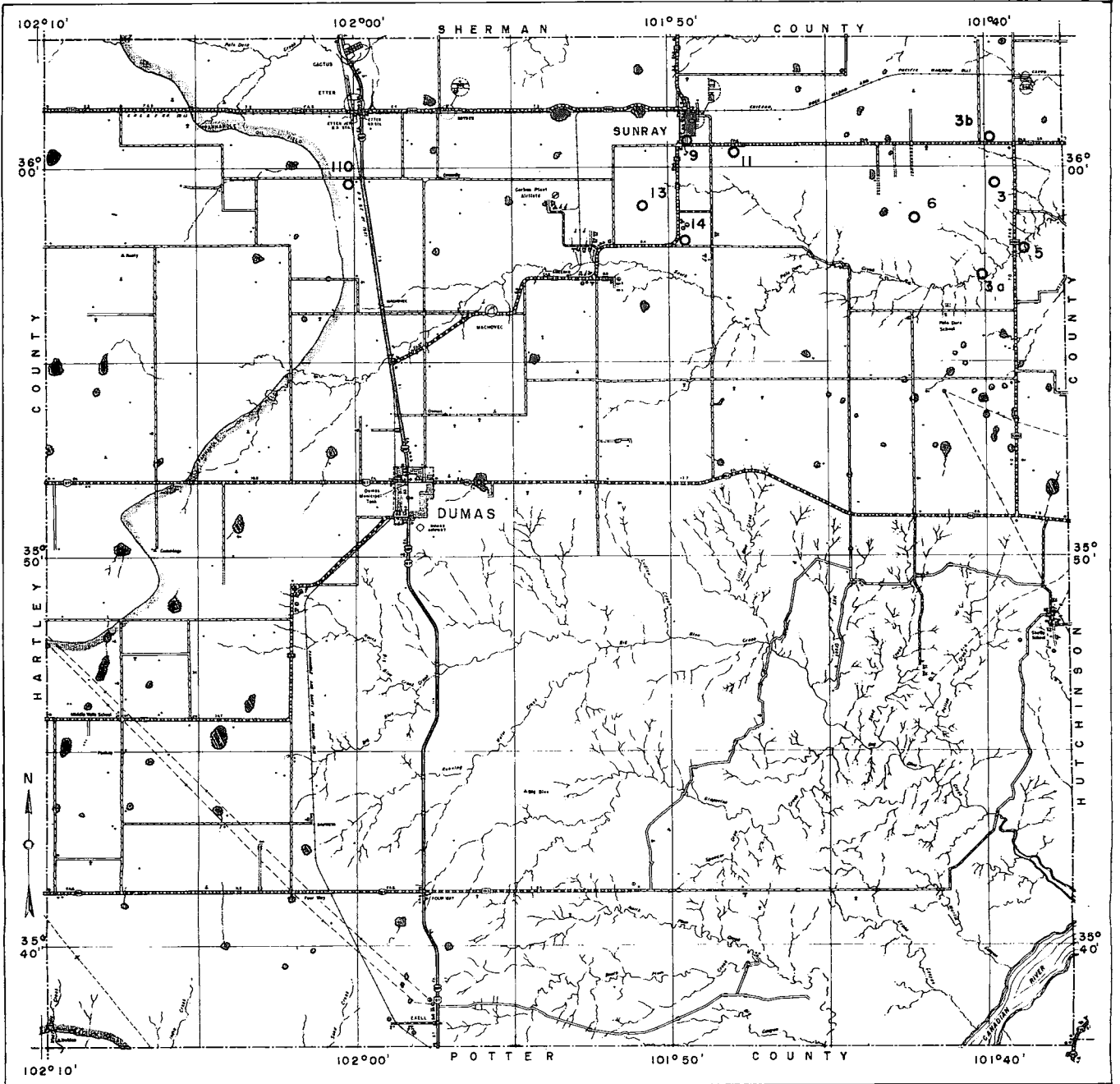

Base map by the Texas State
Highway Department

0 1 2 3 4 5 MILES

MOORE COUNTY

3. Lat. $35^{\circ}59'$, long. $101^{\circ}39'$.

Date	Water level	Date	Water level	Date	Water level
Feb. 23, 1950	147.58	Feb. 7, 1952	147.20	Jan. 7, 1954	147.75
Dec. 29, 1951	147.71	Jan. 12, 1953	147.34		

3a. Lat. $36^{\circ}00'$, long. $101^{\circ}39'$.

Feb. 7, 1952	111.06	Feb. 25, 1953	112.19	Jan. 7, 1954	110.98
Jan. 12, 1953	111.90				

3b. Lat. $36^{\circ}00'$, long. $101^{\circ}39'$. Depth 401 feet.

Feb. 7, 1952	154.22	Jan. 12, 1953	153.82	Jan. 7, 1954	155.86
--------------	--------	---------------	--------	--------------	--------

5. Lat. $35^{\circ}57'$, long. $101^{\circ}39'$.

Feb. 23, 1950	96.33	Jan. 12, 1953	95.61	Jan. 7, 1954	96.03
Feb. 7, 1952	95.62				

6. Lat. $35^{\circ}39'$, long. $101^{\circ}42'$. Depth 278 feet.

Feb. 23, 1950	171.89	Feb. 7, 1952	172.15	Jan. 12, 1953	172.62
July 7	172.09				

9. Lat. $36^{\circ}00'$, long. $101^{\circ}49'$. Depth 350 feet.

Feb. 23, 1950	170.13	Jan. 12, 1953	174.11	Jan. 25, 1954	175.87
Jan. 8, 1951	171.63				

11. Lat. $36^{\circ}00'$, long. $101^{\circ}47'$. Depth 360 feet.

Feb. 23, 1950	182.31	Feb. 7, 1952	183.38	Jan. 7, 1954	187.52
Jan. 9, 1951	181.71	Jan. 12, 1953	185.16		

MOORE COUNTY

13. Lat. $35^{\circ}58'$, long. $101^{\circ}50'$.

Date	Water level	Date	Water level	Date	Water level
Feb. 23, 1950	179.62	Feb. 7, 1952	178.96	Jan. 7, 1954	182.88
Jan. 8, 1951	180.37				

14. Lat. $35^{\circ}57'$, long. $101^{\circ}49'$.

Feb. 23, 1950	181.36	Feb. 7, 1952	182.88	Jan. 7, 1954	184.69
Jan. 10, 1951	182.57	Jan. 12, 1953	183.45		

110. Lat. $35^{\circ}59'$, long. $102^{\circ}00'$. Depth 216 feet.

May 19, 1943	206.40	Jan. 4, 1951	208.64	Jan. 12, 1953	205.92
--------------	--------	--------------	--------	---------------	--------

OCHILTREE COUNTY

OCHILTREE COUNTY, TEXAS OBSERVATION WELLS

January 1954

Bulletin 5404
Texas Board of Water Engineers
in cooperation with
U. S. Geological Survey

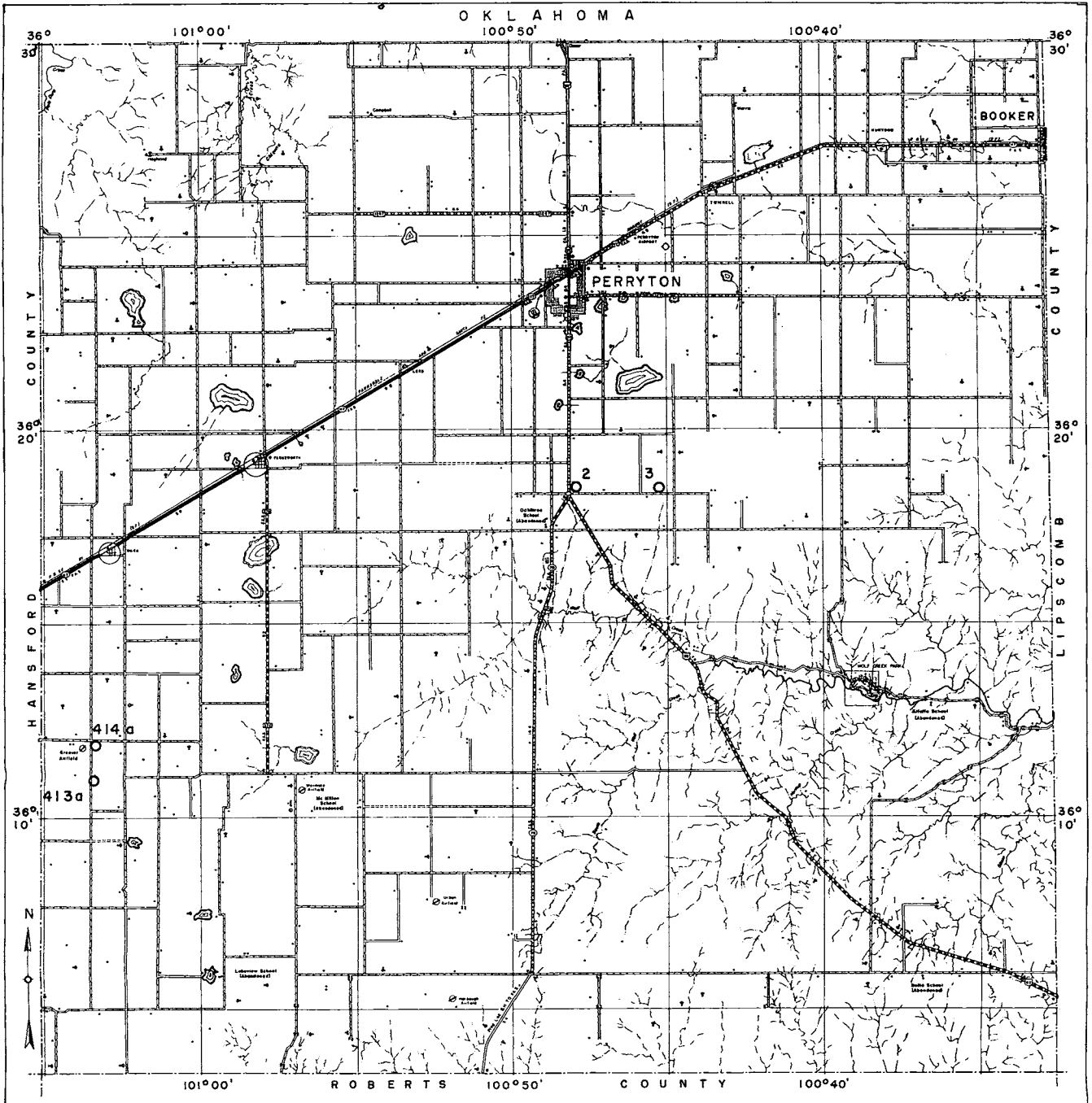

Base map by the Texas State
Highway Department

0 1 2 3 4 5 MILES

OCHILTREE COUNTY

2. Lat. $36^{\circ}18'$, long. $100^{\circ}48'$. Depth 295 feet.

Date	Water level	Date	Water level	Date	Water level
July 7, 1937	261.51	Mar. 11, 1939	261.20	Aug. 6, 1940	261.67
Jan. 15, 1938	261.49	July 1	261.57	Dec. 4	261.58
May 13	261.46	Dec. 22	261.37	Dec. 6, 1941	261.55
Oct. 1	261.4	Apr. 9, 1940	261.42		

3. Lat. $36^{\circ}18'$, long. $100^{\circ}45'$. Depth 228 feet.

July 7, 1937	218.32	Mar. 11, 1939	217.88	Aug. 6, 1940	218.57
Jan. 15, 1938	218.36	July 1	218.48	Dec. 4	218.39
May 13	218.39	Dec. 22	218.36	Dec. 6, 1941	217.66
Oct. 1	218.4	Apr. 9, 1940	218.32		

413a. Lat. $36^{\circ}10'$, long. $101^{\circ}03'$. Depth 472 feet.

Feb. 6, 1952	288.05	Jan. 13, 1953	290.39	Jan. 22, 1954	290.58
--------------	--------	---------------	--------	---------------	--------

414a. Lat. $36^{\circ}11'$, long. $101^{\circ}03'$. Depth $500\pm$ feet.

Feb. 6, 1952	285.07	Jan. 13, 1953	285.52	Jan. 22, 1954	286.04
--------------	--------	---------------	--------	---------------	--------

SHERMAN COUNTY

SHERMAN COUNTY, TEXAS OBSERVATION WELLS January 1954

Bulletin 5404
Texas Board of Water Engineers
in cooperation with
U. S. Geological Survey

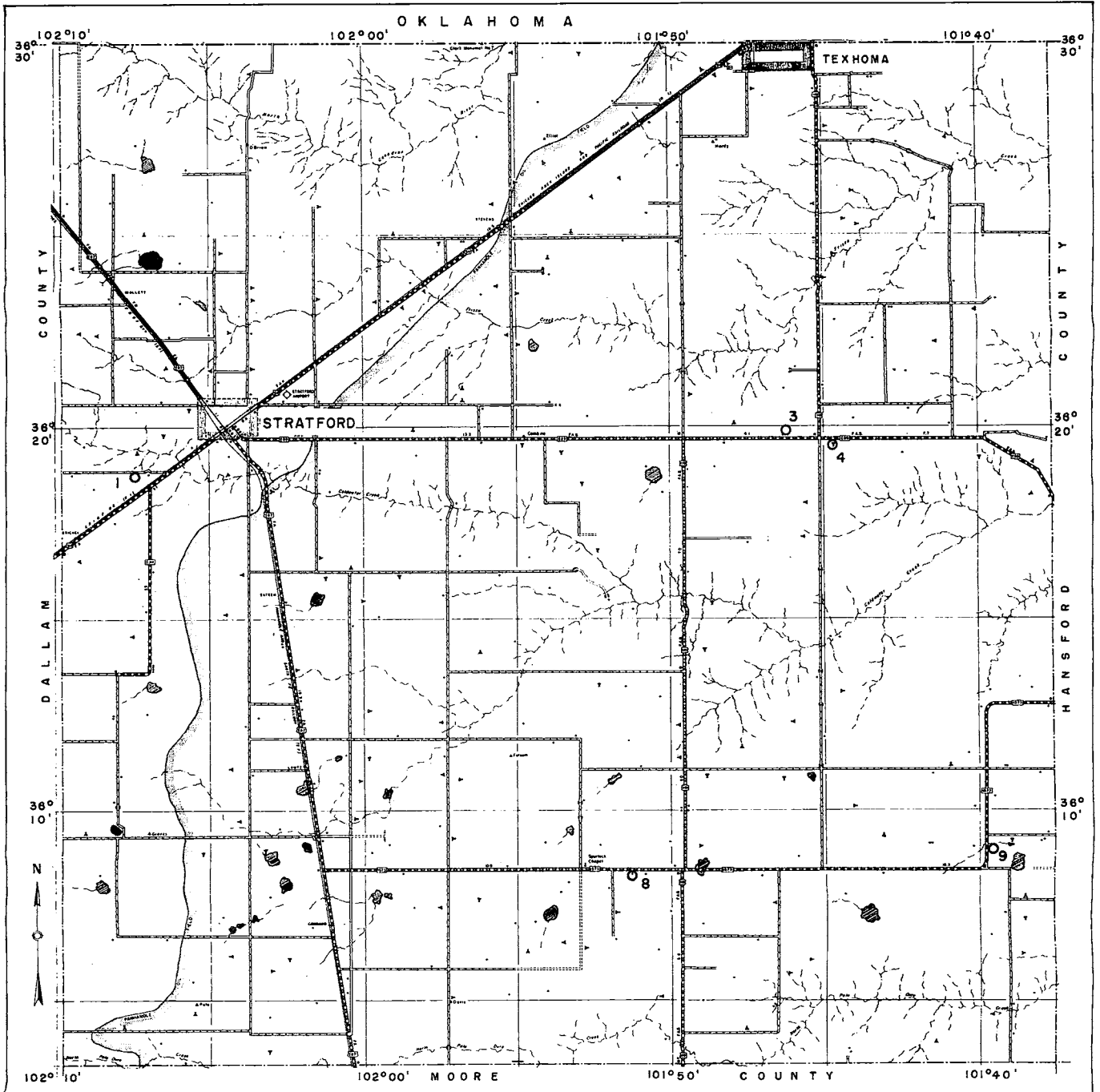

Base map by the Texas State
Highway Department

0 1 2 3 4 5 MILES

SHERMAN COUNTY

1. Lat. $36^{\circ}18'$, long. $101^{\circ}07'$. Depth 236 feet.

Date	Water level	Date	Water level	Date	Water level
July 6, 1937	203.96	May 12, 1938	203.72	Mar. 10, 1939	203.26
Jan. 13, 1938	203.85				

3. Lat. $36^{\circ}19'$, long. $101^{\circ}46'$. Depth 235 feet.

July 6, 1937	174.78	May 12, 1938	174.52	June 30, 1939	174.61
Jan. 13, 1938	174.65	Mar. 10, 1939	174.44	Aug. 8, 1940	174.64

4. Lat. $36^{\circ}19'$, long. $101^{\circ}44'$. Depth 221 feet.

Jan. 13, 1938	189.65	Dec. 21, 1939	189.51	Dec. 5, 1940	189.69
May 12	189.58	Apr. 11, 1940	189.56		
June 30, 1939	189.43	Aug. 8	189.51		

8. Lat. $36^{\circ}08'$, long. $101^{\circ}51'$. Depth 400 feet.

Feb. 23, 1950	208.4	Jan. 13, 1953	209.63		
---------------	-------	---------------	--------	--	--

9. Lat. $36^{\circ}09'$, long. $101^{\circ}39'$. Depth 401 feet.

Jan. 13, 1953	142.71	Jan. 25, 1954	140.34		
---------------	--------	---------------	--------	--	--